



# INSTRUCTIONS

-J04125

REV. 2006-05-17

## CLASSIC COVERS MOTORCYCLE KITS

### GENERAL

#### Kit Number

94946-07, 94947-07, 94948-07, 94949-07

#### Models

**Table 1. Models**

Kit	Kit Number	Models
A	94946-07	2004 and later Sportster models
B	94947-07	Twin Cam equipped Dyna models
C	94948-07	Twin Cam equipped Softail models
D	94949-07	Twin Cam equipped Touring models

### Additional Parts May Be Required

#### NOTE

Because of the large variation of fitments between models and model years, you may find that you have extra covers remaining after the installation of this kit. You may also find that you may be short various covers after installing this kit. If this occurs, contact a Harley-Davidson dealer to purchase additional individual covers.

### Kit Contents

#### NOTE

The different size and type covers are packaged (with part number on package) in groups. Refer to Table 2 to determine the recommended usage area and intended fasteners for each group of covers. See Figure 2 for images of each cover and corresponding fasteners. If ordering replacement covers from a Harley-Davidson dealer, the part number in Table 2 is for a quantity of 1 each.

**Table 2. Kit Contents**

	Intended Fastener	Recommended Usage (Not applicable for all models)	Part Number	Kit A	Kit B	Kit C	Kit D
1	1/4 in. size socket head cap screw	Various engine and transmission cover screws	94903-07	56	56	50	50
2	5/16 in. size socket head cap screw	Handlebar clamp bolts, transmission clutch release cover screws	94904-07	11	11	11	7
3	5/16 in. size socket head cap screw	Front fender mounting screws	94905-07	5	8	8	0
4	3/8 in. size socket head cap screw	Footpeg mounting bolts, Exhaust mounting bolts	94906-07	3	6	12	3
5	5/16 in. size special hex/socket screw	Rocker box cover screws	94907-07	0	8	8	8
6	5/16 in. size T40 Torx button head screw	Front brake disc screws	94908-07	0	5	5	10
7	3/8 in. size T45 Torx button head screw	Rear brake disc screws	94909-07	0	5	5	0
8	1/4 in. socket size 12-point screw	Brake caliper pins	94910-07	0	4	4	4
9	10mm socket size 12-point screw	Brake caliper screws	94911-07	4	8	8	8
10	1/2 in. size flanged hex bolt assembly	Right front motor mount bolt	94912-07	1	0	1	0
11	3/8 in. size T45 Torx button head screw	Rear fender strut screws	94913-07	4	4	18	0
12	7/16 in. size hex bolt assembly	Rear sprocket bolts	94914-07	5	5	5	0
13	3/8 in. size hex bolt (9/16 in. hex)	Footpeg mounting bolts	94915-07	1	11	11	16
14	3/8 in. size hex bolt (9/16 in. hex)	Transmission to engine mounting screws, Footpeg mounting nuts	94916-07	2	6	6	0
15	1/4 in. size hex bolt (7/16 in. hex)	Tourpak mounting screws, Regulator mounting nut	94917-07	0	1	0	14
16	5/16 in. size hex bolt (1/2 in. hex)	Engine case screws	94918-07	8	10	12	16

**Table 2. Kit Contents**

	Intended Fastener	Recommended Usage (Not applicable for all models)	Part Number	Kit A	Kit B	Kit C	Kit D
17	1/2 in. size hex bolt (3/4 in. hex)	Rear shock mounting bolts, Handlebar riser bolts	94919-07	2	2	4	0
18	1/2 in. size flanged hex nut assembly	Left front motor mount nut	94920-07	0	0	1	0
19	7/16 in. size hex bolt (5/8 in. hex)	Engine mount screws, Passenger footboard mounting screws	94941-07	3	0	0	3
20	5/16 in. size button or special round head screw	Brake pedal pivot screw, Front wheel hub screw, Spotlamp mounting bracket screws, Saddlebag mounting bracket screws	94942-07	4	6	6	9
21	Silicone adhesive		Not sold separately (not shown)				

## INSTALLATION

### NOTE

Prior to final installation of covers, test fit covers over fasteners to determine correct fastener-to-cover fitment.

### NOTE

See Figure 1. This kit includes a container of silicone adhesive. For the plug style covers (1), apply adhesive in the area marked with "x". For cap style covers (2), apply adhesive in the area marked with "x".

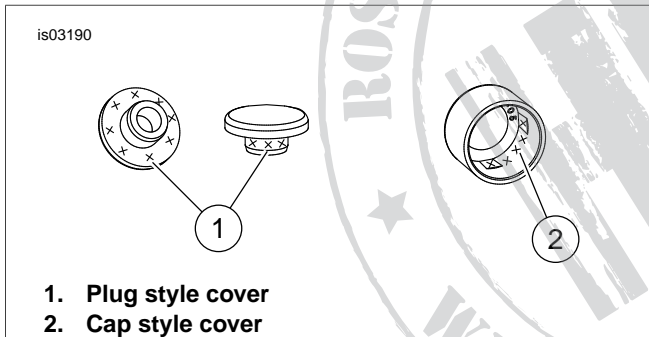

**Figure 1. Silicone Adhesive Application Area**

### NOTE

All fasteners that will be covered must be clean and dry prior to cover installation. It is recommended that the entire motorcycle be washed and completely dry. Pay particular attention to fastener heads.

1. Open only one part numbered bag of covers at a time. Start in one area of motorcycle and test fit several covers over fasteners. Once correct fitment is confirmed, apply a small amount of silicone adhesive to inside wall of cover and install over fastener. Remove excess adhesive. Move to the next part numbered bag of covers and repeat process.
2. Allow the silicone adhesive to cure for a minimum of 12 hours before operating motorcycle.

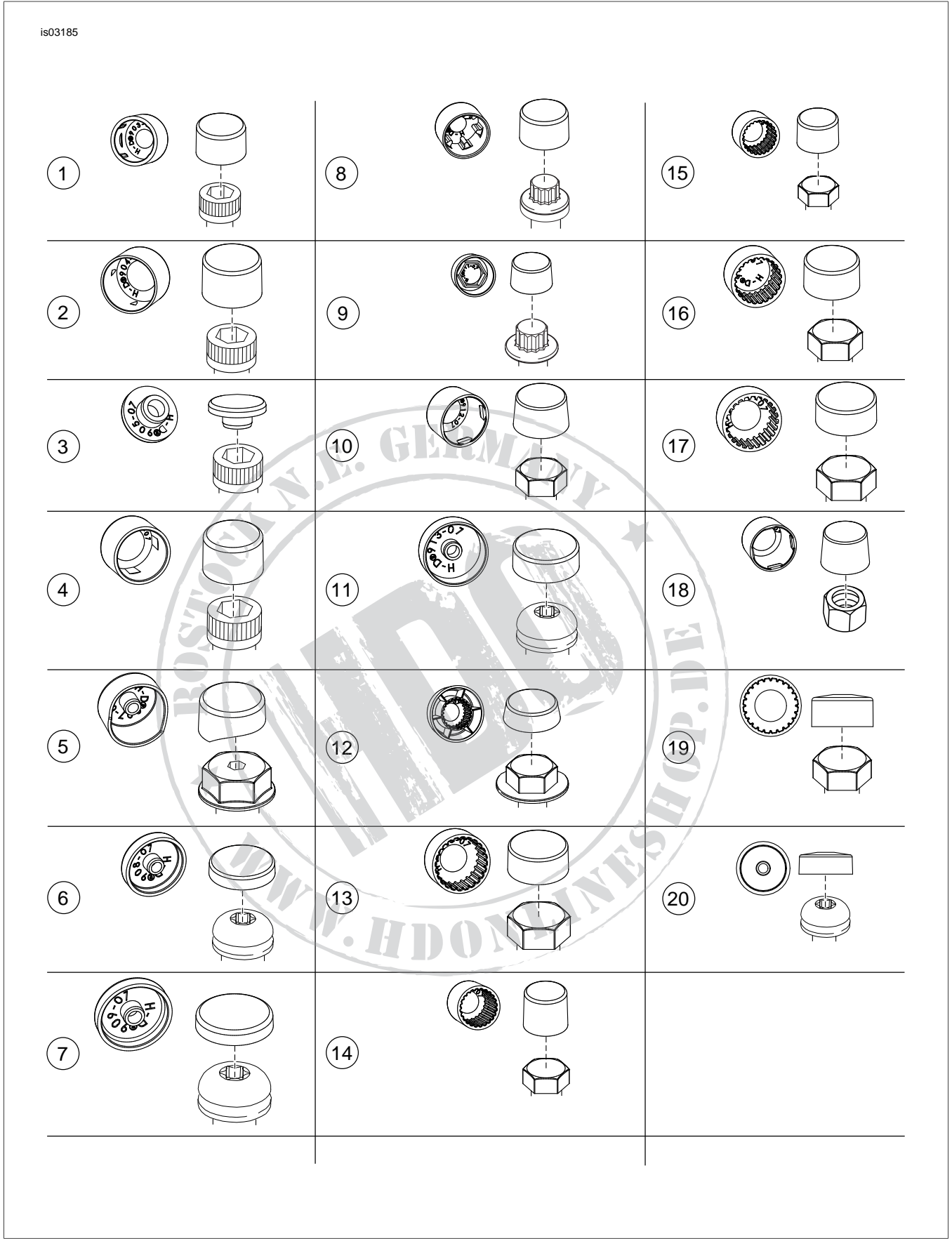

Figure 2. Classic Covers and Corresponding Fasteners