



INSTRUCTIONS

-J04437

REV. 2007-05-22

CHROME REAR FENDER SUPPORT HARDWARE KIT

GENERAL

Kit Number

94691-08

Models

For model fitment information, please see the P&A Retail Catalog or the Parts and Accessories section of www.harley-davidson.com (English only).

Additional Parts Required

This kit also requires the separate purchase of Loctite® 243 Threadlocker and Sealant (blue) (Harley-Davidson Part Number 99642-97) which can be purchased from any Harley-Davidson Dealer.

WARNING

The rider's safety depends upon the correct installation of this kit. Use the appropriate service manual procedures. If the procedure is not within your capabilities or you do not have the correct tools, have a Harley-Davidson dealer perform the installation. Improper installation of this kit could result in death or serious injury. (00333a)

NOTE

This instruction sheet references Service Manual information. A Service Manual for your model motorcycle is required for this installation and is available from a Harley-Davidson Dealer.

Kit Contents

See Figure 1 and Table 1.

INSTALLATION

NOTES

When performing this installation, be careful not to scratch nearby painted or chrome surfaces.

Remove and replace one screw before removing the next.

WARNING

Be sure fasteners do not extend inward beyond fender mounting bracket. Fastener contact with tire can lead to premature tire failure, which could result in death or serious injury. (00389a)

1. Remove and discard one rear fender attaching screw from the bottom front of the rear fender support.
2. See Figure 1. Apply Loctite 243 (blue) (Harley-Davidson Part Number 99642-97) to the threads of the 1-1/4 inch screw (1). Insert the screw through the counterbore side of the chrome washer (2), the hole in the fender support cover, fender support and into the hole in the motorcycle frame. Tighten the screw to 21-27 ft-lbs (28.5-36.6 Nm).
3. Apply Loctite 243 (blue) (Harley-Davidson Part Number 99642-97) to the threads of the 1-1/2 inch screw (3). Insert the screw through the counterbore side of the chrome washer (2), the hole in the fender support cover, fender support and into the hole in the motorcycle frame. Tighten the screw to 30-35 ft-lbs (41-47 Nm). Loosen the screw and retighten to 38-42 ft-lbs (52-57 Nm). Repeat for the other screw (3).
4. Repeat Steps 1 through 3 for the opposite side of the motorcycle.



SERVICE PARTS

is04623

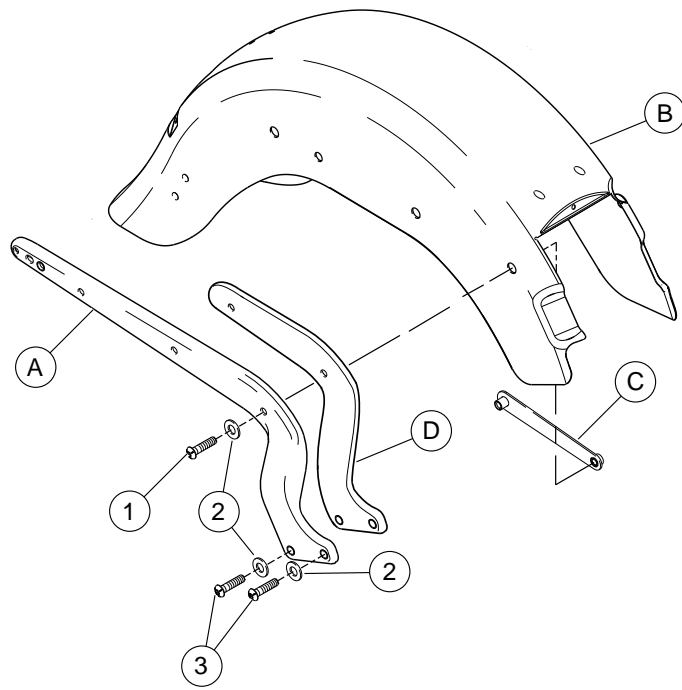

Figure 1. Service Parts: Chrome Rear Fender Support Hardware Kit

Table 1. Service Parts Table: Chrome Rear Fender Support Hardware Kit

Item	Description (Quantity)	Part Number
1	Screw, button head, TORX®, chrome, 3/8-16 x 1-1/4 inch (32 mm) (2)	94606-98
2	Washer, chrome (6)	6586
3	Screw, button head, TORX®, chrome, 3/8-16 x 1-1/2 inch (4)	9460
Items mentioned in text, but not included in kit:		
A	Cover, fender support (right side shown)	
B	Fender, rear	
C	Bracket, fender mounting, front	
D	Support, fender (right side shown)	

