



# INSTRUCTIONS

-J02918

REV. 6-26-03

Kit Number 94281-04

## PRIMARY COVER CHROME HARDWARE KIT

### General

This kit is designed for use on all 2004 and later XL model motorcycles.

See the Service Parts illustration below for a list of items contained in this kit.

#### NOTE

A Service Manual for your model motorcycle is available from any Harley-Davidson Dealer.

### Installation

#### WARNING

To prevent accidental vehicle start-up, which could cause death or serious injury, disconnect negative (-) battery cable before proceeding. (00048a)

1. Refer to the Service Manual and follow the instructions given to remove the seat and disconnect the negative battery cable.
2. Follow the procedure found in the Service Manual to remove and discard the hardware from the primary cover. Secure the primary cover with all the new chrome screws and washers from the service kit.
3. Consult the Service Manual for screw locations, torque values and recommended gasket replacement.
4. Re-connect negative (-) battery cable.
5. Refer to the Service Manual, and follow the instructions to install the seat.

#### WARNING

After installing seat, pull upward on front of seat to be sure it is in locked position. While riding, a loose seat can shift causing loss of control, which could result in death or serious injury. (00070a)



## Service Parts

Part No. 94281-04

Date 6/03

Primary Cover Chrome Hardware Kit

i05301a

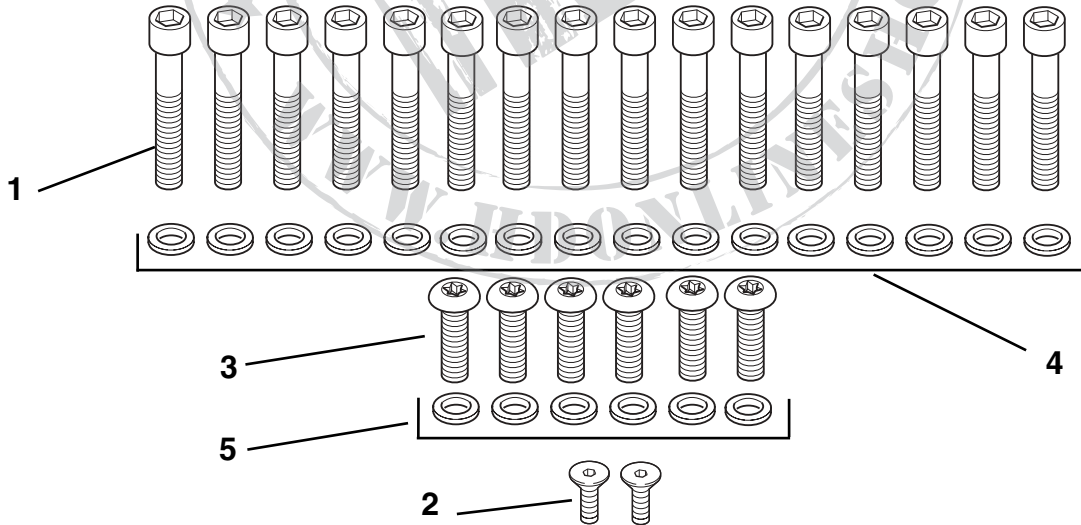

#### Item

#### Description

#### Part No.

- |   |  |             |
|---|--|-------------|
| 1 | Screw, Chrome, Socket Head, (1/4 - 20 x 2 in. long) (16)           | 94318-91TS* |
| 2 | Screw, Chrome, Flat Head Hex. Drive (1/4 - 20 x 5/8 in. long) (2)  | 94230-00**  |
| 3 | Screw, Chrome, Button Head, TORX® (1/4 - 20 x 5/8 in. long) (6)    | 94592-98    |
| 4 | Washer, Chrome (1/4 I.D. x 7/16 O.D. x 1/16 in thick) (16)         | 94062-03    |
| 5 | Washer, stainless steel (1/4 I.D. x 7/16 O.D. x 1/64 in.thick) (6) | 94629-04    |

These screws are shipped with threadlocker applied. If replacement screws are ordered, apply

\*LOCTITE® THREADLOCKER® 243 (blue) (HD® Part Number 99642-97) to the threads before installing.

\*\*LOCTITE® THREADLOCKER® 222 MS(purple) (HD® Part Number 99811-97) to the threads before installing.