



INSTRUCTIONS

-J02048

REV. 2007-07-20

CHROME FOOTPEG BOLT KIT

GENERAL

Kit Number

94133-01

Models

For model fitment information, please see the P&A Retail Catalog or the Parts and Accessories section of www.harley-davidson.com (English only).

Additional Parts Required

LOCTITE® 243 Threadlocker and Sealant (blue) (HD-99642-97)

WARNING

The rider's safety depends upon the correct installation of this kit. Use the appropriate service manual procedures. If the procedure is not within your capabilities or you do not have the correct tools, have a Harley-Davidson dealer perform the installation. Improper installation of this kit could result in death or serious injury. (00333a)

NOTE

The bolts supplied in this kit are designed for a one-time installation only. If this kit is removed after initial installation, you must re-apply Loctite 243 (Blue) to the threads of the bolts.

Kit Contents

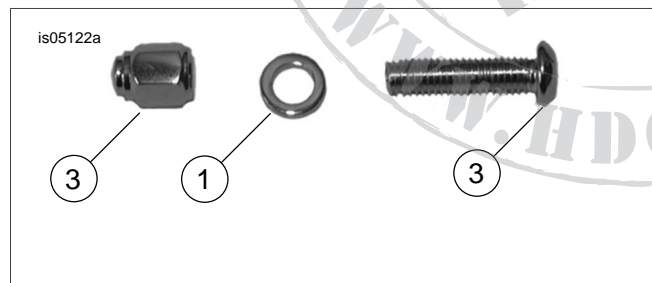

Figure 1. Service Parts: Chrome Footpeg Bolt Kit

Table 1. Service Parts

Item	Description (Quantity)	Part Number
1	Washer, chrome (2)	94128-01
2	Nut, chrome (2)	8023
3	Screw, TORX®, button head, chrome (2)	4233

INSTALLATION

1. Remove existing nut and bolt securing footpeg to mount. Discard nut and bolt.
2. See Figure 2. Install chrome washer to bolt, then install bolt through mount and footpeg as shown.
3. Install nut to bolt. Tighten hardware to 10-16 ft-lbs (13.6-21.7 Nm).
4. Repeat Steps 1 through 3 for the opposite side.

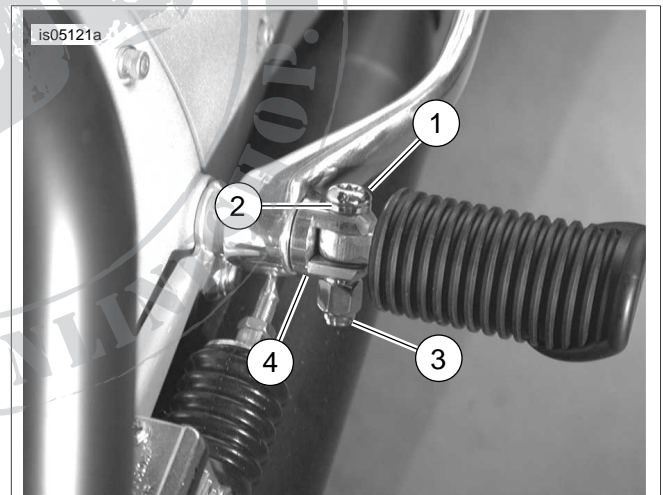

1. Bolt
2. Washer
3. Nut
4. Footpeg mount

Figure 2. Footpeg Bolt Installation