



# INSTRUCTIONS

-J02763

REV. 2006-11-30

## TRANSMISSION COVER CHROME HARDWARE KIT

### GENERAL

#### Kit Number

94055-03

#### Models

For model fitment information, please see the P&A Retail Catalog or the Parts and Accessories section of [www.harley-davidson.com](http://www.harley-davidson.com) (English only).

#### WARNING

**The rider's safety depends upon the correct installation of this kit. Use the appropriate service manual procedures. If the procedure is not within your capabilities or you do not have the correct tools, have a Harley-Davidson dealer perform the installation. Improper installation of this kit could result in death or serious injury. (00333a)**

#### NOTE

*This instruction sheet references Service Manual information. A Service Manual for your model motorcycle is required for this installation and is available from a Harley-Davidson Dealer.*

### Kit Contents

See Figure 1 and Table 1.

### INSTALLATION

#### WARNING

**To prevent accidental vehicle start-up, which could cause death or serious injury, disconnect negative (-) battery cable before proceeding. (00048a)**

1. Refer to Service Manual and disconnect battery negative cable.
2. Follow the procedure found in the Service Manual to remove the hardware from the transmission top cover, bearing housing assembly and clutch release cover.
3. Refer to the Service Manual for screw locations, torque values and recommended gasket replacement.
4. Refer to the Service Manual and reconnect the battery negative cable.

# SERVICE PARTS

is04187

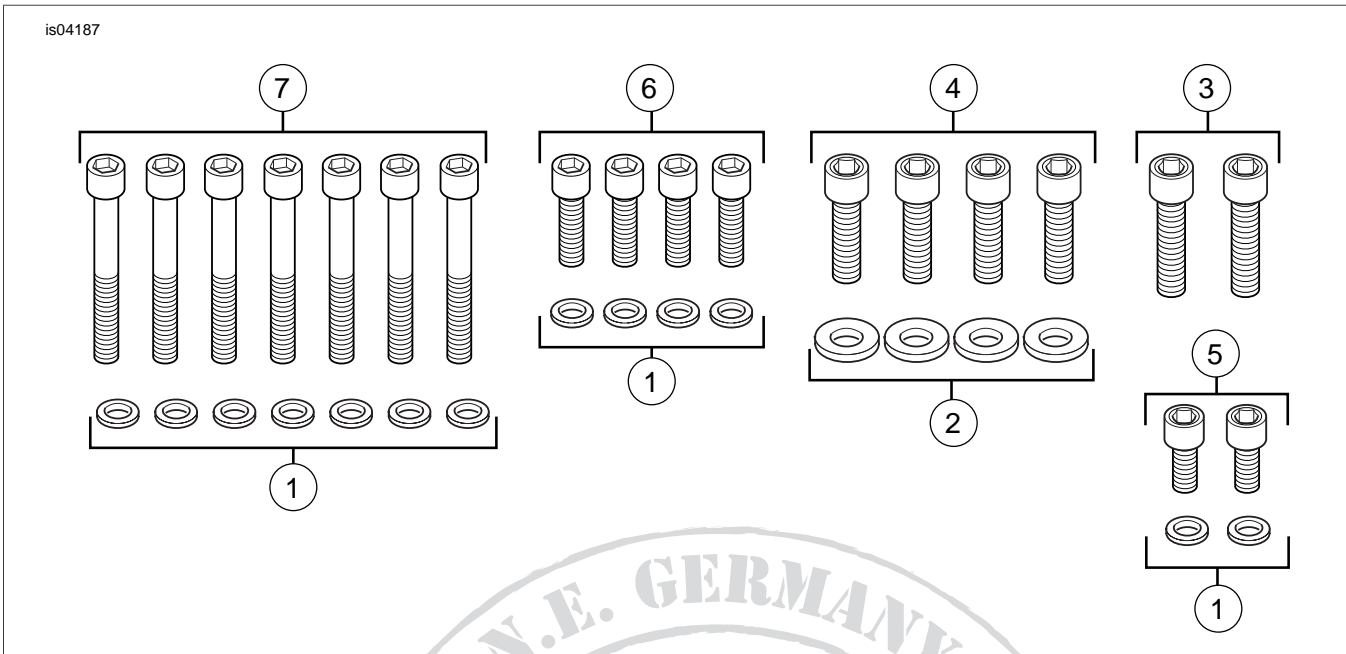

Figure 1. Service Parts: Transmission Cover Chrome Hardware Kit

Table 1. Service Parts Table

Item	Description (Quantity)	Part Number
1	Washer, chrome 0.255/0.240 I.D. x 0.415/0.430 O.D. x 0.06 thk (13)	94062-03
2	Washer, chrome 0.344 I.D. x 0.688 O.D. x 0.062 thk (4)	94070-03
3	Screw, chrome 5/16-18 x 1.50 (2)	91336-91TS
4	Screw, chrome 5/16-18 x 1.25 (4)	94335-91TS
5	Screw, chrome 1/4-20 x 1.125 (2)	94308-93TS
6	Screw, chrome 1/4-20 x 1.25 (4)	94315-91TS
7	Screw, chrome 1/4-20 x 2.25 (7)	94319-91TS

Items 3, 4, 5, 6, and 7 are shipped with threadlock applied. If replacement screws are ordered, apply LOCTITE® Threadlocker 243 (blue) P/N 99642-97 to the threads before installing.

For FLSTF, FLSTS and FXSTD models, use these two screws (3) with two washers (2) at the exhaust bracket and use two screws (4) with two washers (2) at the bearing housing assembly. All other models use the four screws (4) and four washers (2) at the exhaust bracket and the bearing housing assembly. Remaining screws may be discarded.