



INSTRUCTIONS

-J02762

REV. 2006-12-18

TRANSMISSION COVER CHROME HARDWARE KIT

GENERAL

Kit Number

94054-03

Models

For model fitment information, please see the P&A Retail Catalog or the Parts and Accessories section of www.harley-davidson.com.

WARNING

The rider's safety depends upon the correct installation of this kit. Use the appropriate service manual procedures. If the procedure is not within your capabilities or you do not have the correct tools, have a Harley-Davidson dealer perform the installation. Improper installation of this kit could result in death or serious injury. (00333a)

NOTE

This instruction sheet references Service Manual information. A Service Manual for your model motorcycle is available from a Harley-Davidson Dealer.

Kit Contents

See Figure 1 and Table 1.

INSTALLATION

WARNING

To prevent accidental vehicle start-up, which could cause death or serious injury, disconnect negative (-) battery cable before proceeding. (00048a)

WARNING

Disconnect negative (-) battery cable first. If positive (+) cable should contact ground with negative (-) cable connected, the resulting sparks can cause a battery explosion, which could result in death or serious injury. (00049a)

1. Disconnect the negative (-) battery cable from the battery. Disconnect the positive (+) battery cable from the battery.
2. Follow the procedure found in the Service Manual to remove the hardware from the transmission top cover, bearing housing assembly and clutch release cover.
3. Consult the Service Manual for screw locations, torque values and recommended gasket replacement.

WARNING

Connect positive (+) battery cable first. If positive (+) cable should contact ground with negative (-) cable connected, the resulting sparks can cause a battery explosion, which could result in death or serious injury. (00068a)

4. Connect the positive (+) battery cable to the battery. Connect the negative (-) battery cable to the battery.

NOTE

Items 3, 4, 5 and 6 in the Service Parts table are shipped with LOCTITE® Threadlocker applied. If replacement screws are ordered, apply LOCTITE Threadlocker 243 (blue) (Harley-Davidson Part Number 99642-97) to the threads before installing.

SERVICE PARTS

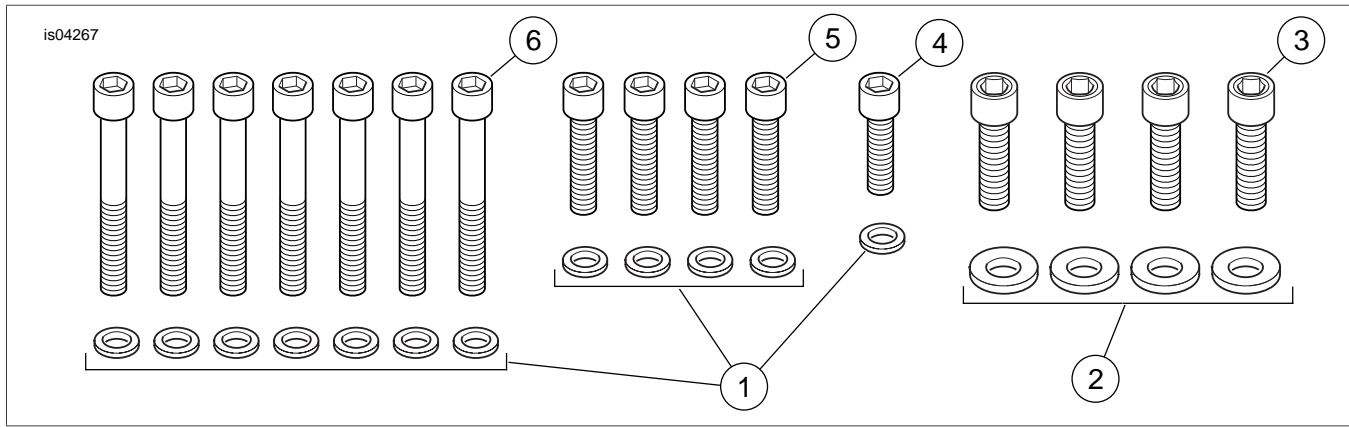

Figure 1. Service Parts: Transmission Cover Chrome Hardware Kit

Table 1. Service Parts Table

Item	Description (Quantity)	Part Number
1	Washer, chrome, 0.255/0.270 I.D. x 0.415/0.430 O.D. x 0.06 inch thick (12)	94062-03
2	Washer, chrome, 0.344 I.D. x 0.688 O.D. x 0.062 inch thick (4)	94070-03
3	Screw, chrome, 5/16-18 x 1.25 inch long (4)	94335-91TS
4	Screw, chrome, 1/4-20 x 1.125 inch long (1)	94308-93TS
5	Screw, chrome, 1/4-20 x 1.25 inch long (4)	94315-91TS
6	Screw, chrome, 1/4-20 x 2.25 inch long (7)	94319-91TS

