



INSTRUCTIONS

-J02489

REV. 2005-11-07

MIRROR KITS

GENERAL

Kit Number

91657-02, 92096-05, 91315-04, 91697-06, 91696-05

Models

These kits are designed to fit all 1982 and later Harley-Davidson motorcycles.

Kit Contents

See Figure 1 and Table 1.

INSTALLATION

1. Remove and discard the existing mirror. Discard any lockwashers and acorn nuts used to mount the original mirror.

NOTE

For step 2, on all kit except 91696-05, install small washer (3) to mirror stem before inserting into hand lever housing. For kit 91696-05, the stem does not require washer.

2. See the Service Parts illustration. **For motorcycles with turn signals mounted to the underside of the hand lever housings**, secure the left side mirror using only the small washer (3) and the acorn nut (6) from the kit.
3. Secure the right side mirror with the small washer (3) and acorn nut (6) from the kit and the turn signal retainer only. Do not use washers (4) or (5) on either side.
4. **For motorcycles with turn signals mounted away from the hand lever housings**, slip the small washers (3) onto the mirror studs. Insert the mirror studs into the holes in the hand lever housings, and secure the mirrors with the washers (4), lockwashers (5) and acorn nuts (6) from the kit.
5. Adjust the mirrors for proper field of vision and tighten the acorn nut to 12 ft-lbs (16 Nm). Check mirror adjustment and reposition if necessary.

SERVICE PARTS

See Figure 1 and Table 1.

is01883

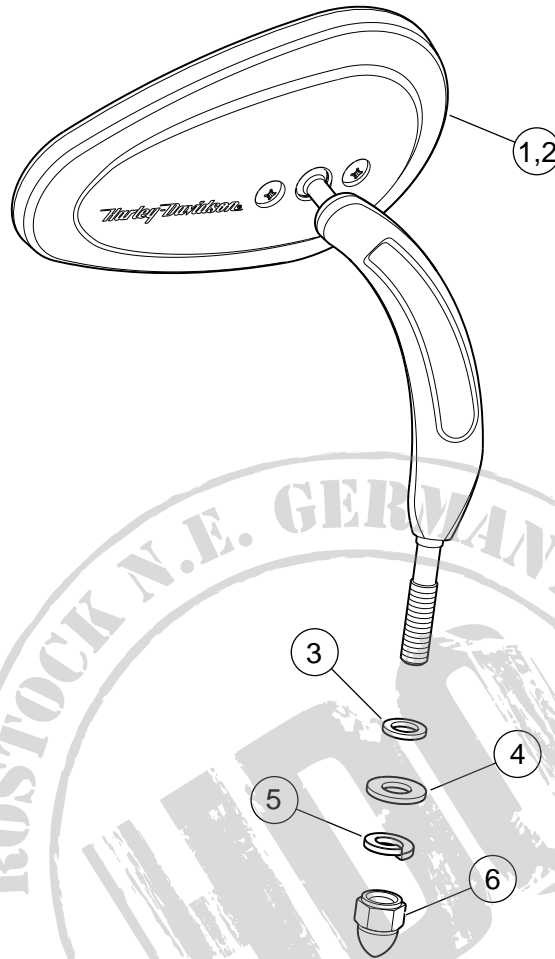

Figure 1. Service Parts: Bullet Style Mirror Shown

Table 1. Service Parts Table

Kit	Item	Description (Quantity)	Part Number
Kit 91657-02, Bullet Style	1	Mirror, right side	91927-03
	2	Mirror, left side	91928-03
	3	Washer, flat, 1/2 inch O.D. (2)	6771A
	4	Washer, flat, 11/16 inch O.D. (2)	6702
	5	Lockwasher, 5/16 inch (2)	7041
	6	Acorn nut, 5/16-24, (2)	7736
Kit 92096-05, Buck-shot Style	1	Mirror, right side	91987-05
	2	Mirror, left side	91949-05
	3	Washer, flat, 1/2 inch O.D. (2)	6771A
	4	Washer, flat, 11/16 inch O.D. (2)	6702
	5	Lockwasher, 5/16 inch (2)	7041
	6	Acorn nut, 5/16-24, (2)	7736

Table 1. Service Parts Table

Kit	Item	Description (Quantity)	Part Number
Kit 91315-04, Skull Style	1	Mirror, right side	91321-04
	2	Mirror, left side	91318-04
	3	Washer, flat, 1/2 inch O.D. (2)	6771A
	4	Washer, flat, 11/16 inch O.D. (2)	6702
	5	Lockwasher, 5/16 inch (2)	7041
	6	Acorn nut, 5/16-24, (2)	7736
Kit 91697-06, Profile Custom w/Slotted Stem Style	1	Mirror, right side	92062-06
	2	Mirror, left side	92063-06
	3	Washer, flat, 1/2 inch O.D. (2)	6771A
	4	Washer, flat, 11/16 inch O.D. (2)	6702
	5	Lockwasher, 5/16 inch (2)	7041
	6	Acorn nut, 5/16-24, (2)	7736
Kit 91696-05, Tailfin Style	1	Mirror, right side	92175-05
	2	Mirror, left side	92176-05
	4	Washer, flat, 11/16 inch O.D. (2)	6702
	5	Lockwasher, 5/16 inch (2)	7041
	6	Acorn nut, 5/16-24, (2)	7736

