



INSTRUCTIONS

-J00521

REV. 10-1-95

Kit Number 91820-85A

WINDSHIELD KIT

General

This kit is designed for installation on 1980 - 1986 FXWG, 1984 and later FXST, FXSTC and 1993 and later FXDWG model vehicles.

QTY	DESCRIPTION
2	Snap caps
1	Windshield
2	U-clamp, 1 in.
2	Nut, 3/8-16
4	Washer, beveled
2	Rod cup spacer
2	Eyebolt, 3/8-16
2	Washer, internal
2	Nut, #10-32
2	Washer, dished
4	Bushing, rubber
2	Screw, nylon, #10-32 x 1 in.
4	Washer, 3/4 in.
2	Ball end, upright
2	Bracket, slotted
2	Bracket, angled
2	Screw, 1/4-20 x 5/8 in.
2	Washer, flat, 5/16 in.
2	Bolt, hex, 5/16-24 x 1/2 in.
2	Nut, flanged, 1/4-20

⚠ WARNING

Check mounting hardware periodically. Never ride with loose mounts. A loose mounting causes extra stress on all other mounts, as well as the windshield itself and could result in premature failure of either or both.

⚠ WARNING

Inspect this windshield upon completion of installation to be sure windshield mounting does not restrict full left or full right movement of the front fork assembly. If restriction does occur, adjust windshield as needed until clearance is obtained. Have experienced Harley-Davidson service personnel correct any problems before riding with this accessory installed.

⚠ CAUTION

Do not clean Lexan polycarbonate in hot sun or high temperature. Powdered, abrasive or alkaline cleansers will damage the windshield. Never scrape the windshield with a razor blade or other sharp instruments because permanent damage will result.

⚠ CAUTION

Sunlight reflections off the inside curvature of the windshield can, at certain times of the day, cause extreme heat build-up on the motorcycle's instruments. Exercise care in parking. Park facing the sun, place an opaque object over the instruments or adjust the windshield to avoid this.

Installation

1. See Figure 1. Place U-clamps (1) around vertical portion of handlebar, with open end of clamp facing downward. Using a hand pliers, lightly squeeze ends of U-clamp together.
2. Place cup spacer (2) and internal lockwasher (3) on eyebolt (4). Start slipping eyebolt through U-clamp from outside of handlebar. Continue inserting eyebolt through two beveled washers (5) (placed between U-clamp prongs, bevels facing each other) and out through other side of handlebar clamp.
3. Install 3/8-16 nut (6) on eyebolt (4), but do not fully tighten. Repeat procedure on other side of handlebar.

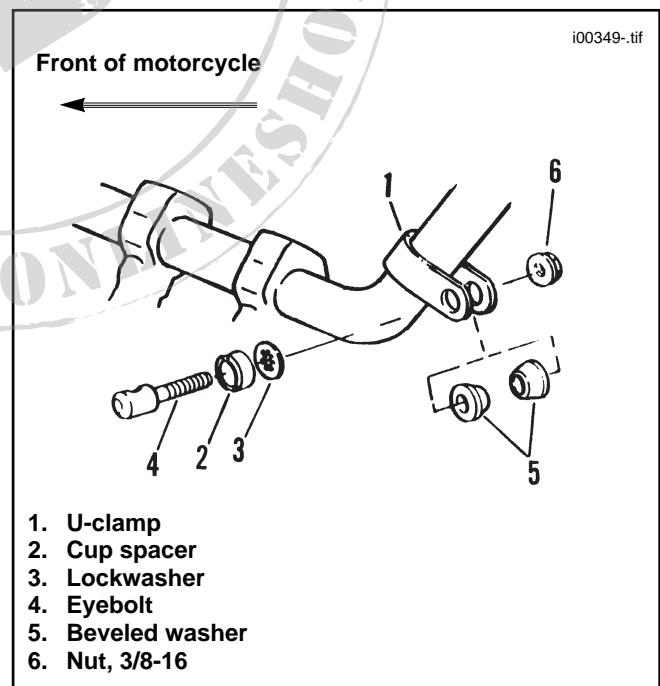

Figure 1. U-clamp Installation

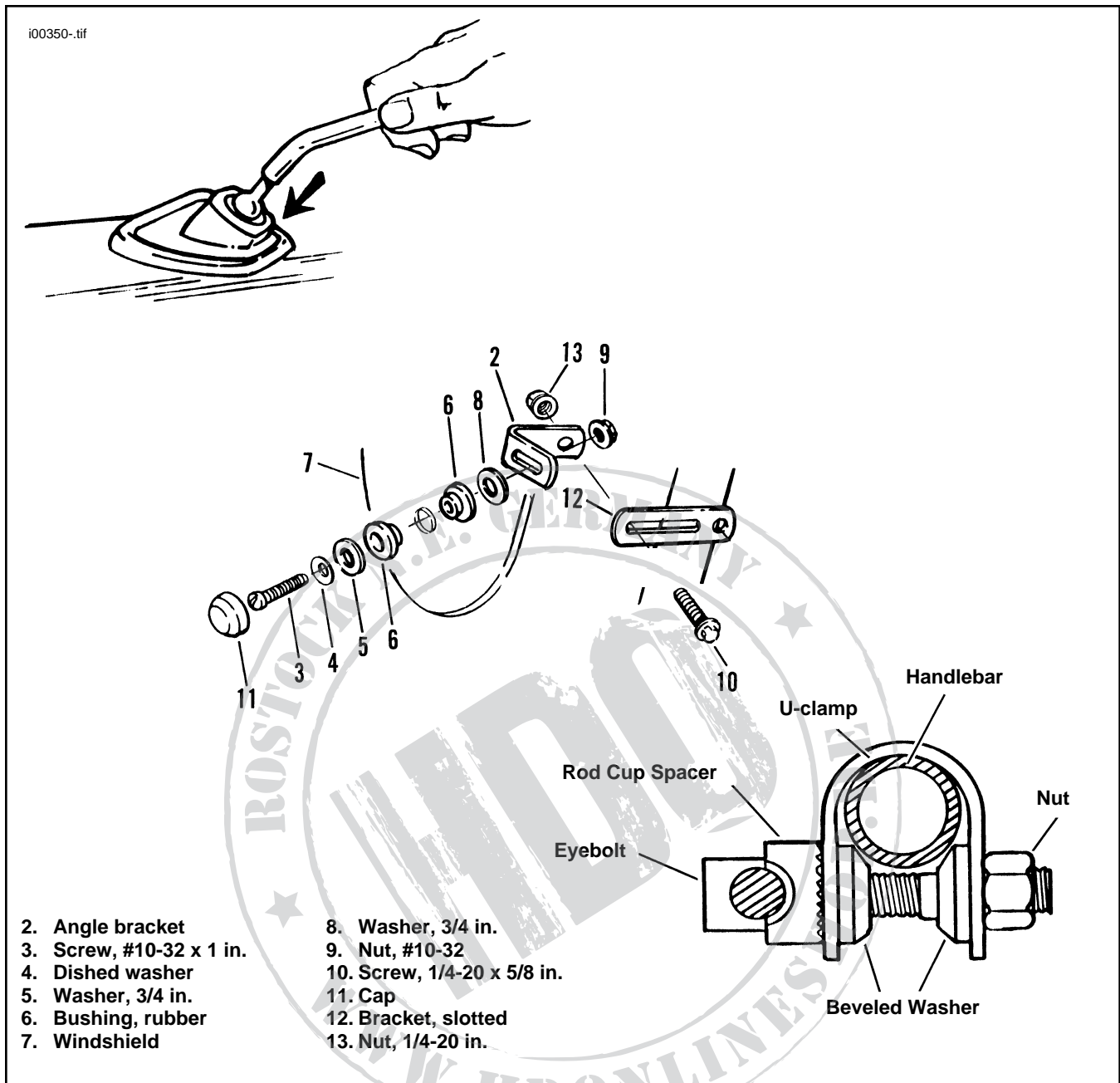

Figure 2. Windshield Brackets

4. See Figure 2. Assemble lower angle brackets (2), left and right, to windshield in the following order (front to rear): #10-32 x 1 in. screw (3), dished washer (4), 3/4 in. washer (5), rubber bushing (6), windshield (7), rubber bushing (6), 3/4 in. washer (8), angle bracket (2) and #10-32 nut (9). Do not fully tighten nut.
6. Slip uprights into eyebolt holes. Do not tighten nuts at this time.
7. Position windshield over top of headlight.

CAUTION

Do not use oil, grease or silicone as a lubricant for sliding ball into place. Use water or saliva only.

5. Position windshield's upper mounting socket directly on a non-abrasive flat surface. Firmly press ball end of upright into upper socket, left and right side. Ball will snap into place.

CAUTION

Be sure upright ends do not come in contact with the instrument cluster. The chrome will be damaged.

8. Fasten slotted bracket (12) to angle bracket using 1/4-20 x 5/8 in. bolt and 1/4-20 nut (13) as shown. Slot must go toward windshield on FXDWG models.
9. Bolt slotted bracket to triple clamp with 5/16-24 x 1/2 in. bolt supplied in kit.

10. Align windshield in desired position. Be sure it is centered, left to right.
11. Tighten hardware in the following sequence: eyebolts, #10-32 x 1 in. screw (just until snug), triple clamp bolt and 1/4 in. angle bracket screw.
12. See Figure 2. Install snap caps (11) over #10-32 x 1 in. screws (3).

NOTE

Your windshield is made of G.F. Lexan FMR polycarbonate sheet. Always pre-rinse windshield with water to remove grit and soften dirt. Wash with mild liquid soap, lots of warm water and a clean soft cloth or sponge. Rinse well to remove all soap residue. Dry with chamois, flannel or moist sponge to prevent water spots. For paint or grease, use cotton wad moistened with turpentine, followed with wash as described above. This also works on label residue.

NOTE

Covering windshield with a clean, wet cloth for approximately 15-20 minutes before washing will make dried bug removal easier. Use mild soap and warm water to wash the windshield. Wipe dry with a soft, clean towel.

NOTE

If your windshield gets a hairline scratch or abrasion, it can be reduced with a non-cleaning, non-silicone automotive polish. The polish will also make cleaning easier. Harley Glaze Polish and Sealant, Part No. 99701-84 is recommended.

CAUTION

Harley-Davidson windshields are made of Lexan. Lexan is a more durable and distortion-resistant material than other types of motorcycle windshield material, but still requires attention and care to maintain.

CAUTION

Do not use liquid windshield “protectors” on your windshield. Although they may work well on automobile safety glass, Harley-Davidson cannot ensure the results when used on Lexan Harley-Davidson windshields. If you want to use a windshield protectant on your windshield, try Harley Glaze Polish and Sealant.

DO NOT use benzene, paint thinner, gasoline or other types of harsh cleaner. They will damage the windshield surface.

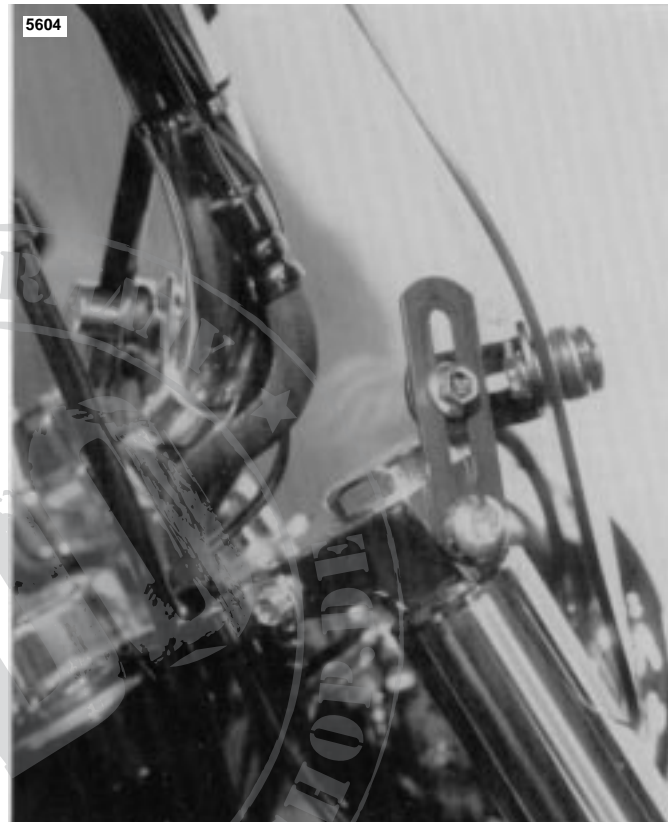

Figure 3. Windshield Assembly - FXDWG