



INSTRUCTIONS

-J03603

REV. 2005-01-05

PASSENGER HANDRAIL GRIP KIT

GENERAL

Kit Number

This instruction sheet applies to the following kit number(s):
91668-05.

Models

This kit fits all 1999 through 2005 Electra Glide model motorcycles with passenger handrail.

Kit Contents

See Figure 1 for a list of the kit contents. No Service Parts are available for this kit.

INSTALLATION

NOTE

The passenger handrail grips are side-specific. Install the grips so that the Bar-and-Shield logo is oriented properly.

1. See Figure 1. Obtain a rubber grip insert (4) from the kit.
2. Open up the rubber insert along the horizontal split (A), and fit it over the forward curve of the handrail. Ensure that the insert is positioned to fit the curve properly, with no kinks or gaps.
3. Obtain an inner grip (1), the correct-side outer grip (2 or 3), and six screws (5) from the kit.
4. Position the inner and outer grips over the insert, pressing them firmly together and lining up the holes.
5. Insert a screw through one of the holes in the inner grip, and carefully thread part way into the mating hole in the outer grip. Repeat for the remaining five screws.
6. Use the hex socket wrench (6) provided to tighten all six screws securely.
7. Repeat Steps 1 through 6 for the opposite side.

ITEMS IN KIT

is00039a

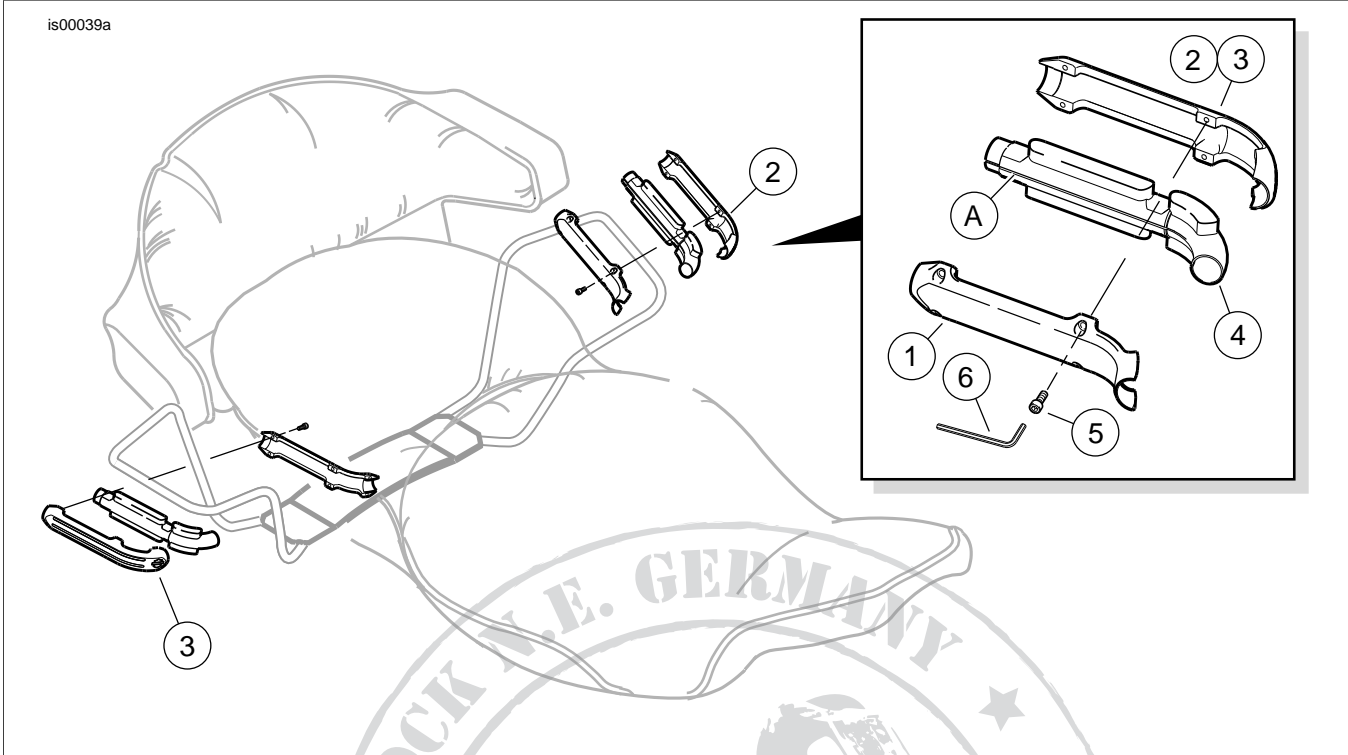

Figure 1. Passenger Handrail Grips

Table 1. Passenger Handrail Grips

ITEM	DESCRIPTION
Items included in kit:	
1.	Inner handrail grip (2)
2.	Left-side outer handrail grip
3.	Right-side outer handrail grip
4.	Rubber grip insert (2)
5.	Screw (12)
6.	Hex socket wrench
For reference only:	
A.	Horizontal split in grip insert