



INSTRUCTIONS

-J04376

REV. 2007-05-01

TRI-BAR REAR FENDER EXTENSION LIGHT

GENERAL

Kit Number

91067-07

Models

For model fitment information, please see the P&A Retail Catalog or the Parts and Accessories section of www.harley-davidson.com (English only).

WARNING

The rider's safety depends upon the correct installation of this kit. If the procedure is not within your capabilities or you do not have the correct tools, have a Harley-Davidson dealer perform the installation. Improper installation of this kit could result in death or serious injury. (00308a)

Kit Contents

See Figure 4 and Table 1.

REMOVE

1. See Figure 1. Remove two screws to disconnect tail lamp lens from chrome base (1). Save screws for reuse.
2. Disconnect fender tail lamp harness connector (2) from tail lamp socket.
3. Disconnect fender tip harness connector (3) from tail lamp socket.

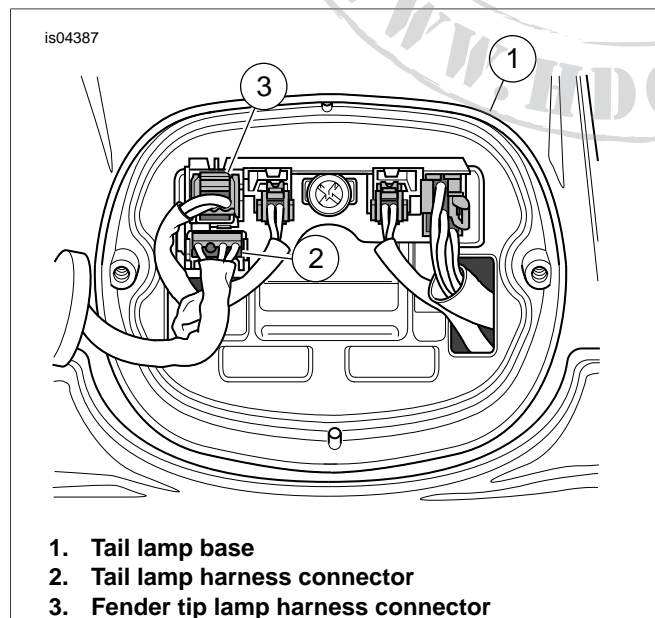

Figure 1. Tail Lamp Base

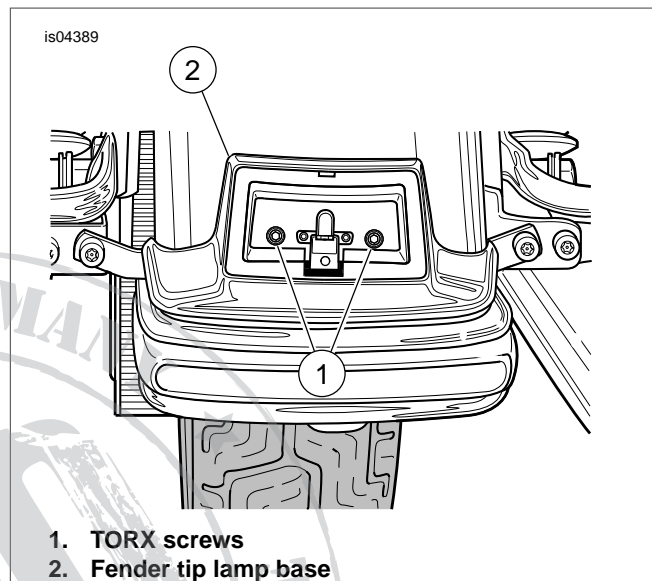

Figure 2. Fender Tip Lamp Base

4. Disconnect fender tip lamp harness from clip inside fender below left side of the tail lamp housing and from stamped fender clip.
5. Insert blade of small screwdriver into slot at top of fender lamp lens. Rotate screw driver to unsnap lamp lens
6. See Figure 2. Holding inner fender nuts behind fender tip lamp, remove two TORX® screws (1) to release fender tip lamp base (2). Pull lamp away from fender to draw out wire harness.

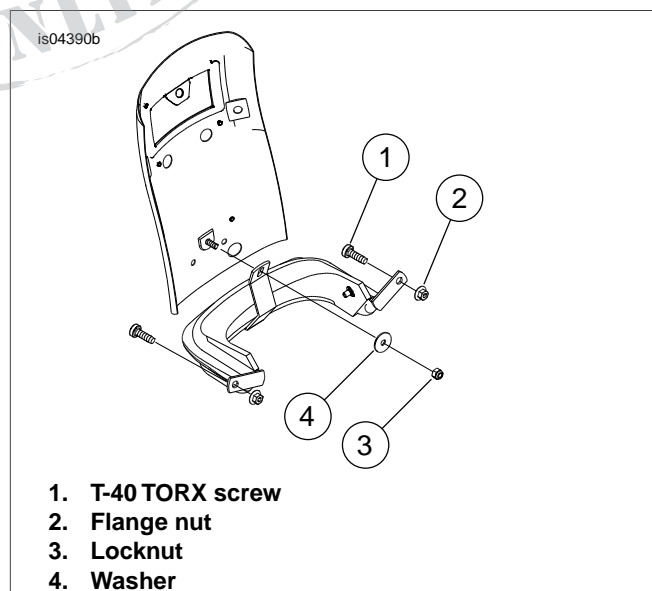

Figure 3. Rear Fender Bumper

7. See Figure 3. Reach underneath fender below bumper and remove locknut (3) and washer (4) from weld stud centered in lower fender.
8. Remove two T-40 TORX screws (1) and flange nuts (2) from bumper bracket at the saddlebag supports and remove bumper. Save TORX screws and nuts for reuse.

INSTALL

1. See Figure 4 and Table 1. Snap tabs of tri-bar fender lamp (6) into slots of tri-bar housing fascia (1).
2. Position mounting bracket (7) as shown and attach to housing fascia using two self-tapping screws (8). Tighten screws to 18-22 **in-lbs** (2.1-2.5 Nm).
3. Position fascia (1) on fender to slide it up so that tab of mounting bracket (7) catches inside of fender.
4. Attach fascia to fender using stud plate (2), washers (4) and nuts (5). Tighten nuts to 10-40 **in-lbs** (1.1-4.5 Nm).

5. Place center tab of fender-to-saddlebag support bracket (9) over fender weld stud and loosely attach washer (10) and locknut (11).
6. Attach fender bracket to saddlebag support using previously removed T-40 TORX screws and nuts. Alternately tighten TORX screws to 15-20 ft-lbs (20-27 Nm). Tighten center weld stud nut (11) to 45-85 **in-lbs** (5.1-9.6 Nm).
7. Route lamp harness inside fender attaching it to fender tang and up to harness clip near lower left of tail lamp housing.
8. See Figure 1. Slip harness connector through opening in lower left of tail lamp housing and connect to socket (3).
9. Install tail lamp lens to housing with screws previously removed and tighten to 20-24 **in-lbs** (2.3-2.7 Nm).

SERVICE PARTS

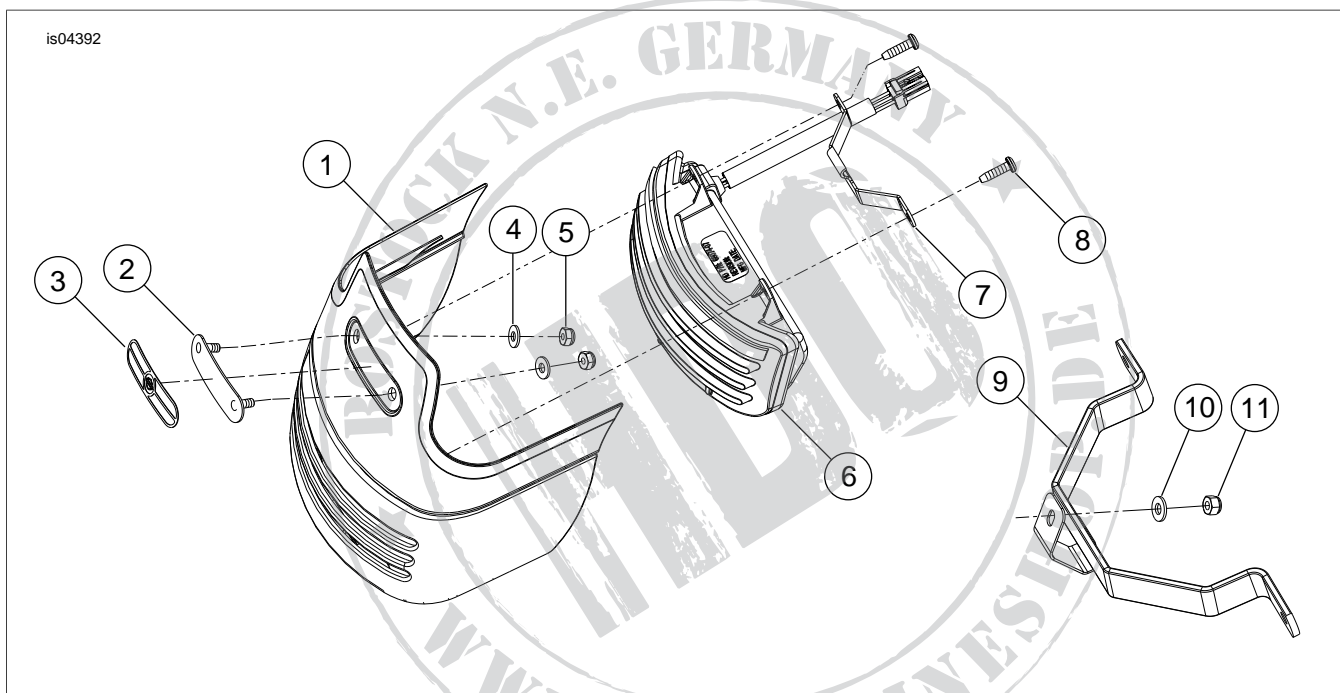

Figure 4. Service Parts: Tri-Bar Rear Fender Fascia Kit

Table 1. Service Parts Table

Item	Description (Quantity)	Part Number
1	Fascia, tri-bar housing	68097-07
2	Stud plate, tri-bar	68099-07
3	Medallion, tri-bar fender light	92004-07
4	Washer, plain 0.19 inch (2)	6716
5	Locknut, #10-32 (2)	7626W
6	Light, tri-bar, run/brake	68074-07
7	Bracket, mounting, tri-bar fender light	68156-07
8	Screw, #12-16, self tapping (2)	3596
9	Bracket, rear fender to saddlebag support	91140-04
10	Washer, plain 1/4-20	6703
11	Locknut, 1/4-28	7683