



INSTRUCTIONS

-J00839

REV. 7-3-01

Kit Number 90589-91D

SADDLEBAG SUPPORT KIT

General

This kit is designed for installation on all 1991 and later FXD Dyna Glide model vehicles (except FXDS-CONV, FXDXT) and 1996 and later FXDWG Dyna Wide Glide models. This kit does not fit with detachable sideplates.

2000 and 2001 FXDX models require separate purchase of hardware kit part number 90272-00.

2002 and later models require separate purchase of two directionals, part number 68425-01 (domestic) or 68420-01 (international).

See the Service Parts illustration for kit contents.

⚠ WARNING

A Service Manual is needed to install this kit. The rider's safety depends upon the correct installation of this kit. If the procedure is not within your capabilities or you do not have the correct tools, have your Harley-Davidson dealer perform the installation. Improper installation of this kit could result in death or serious injury. Installation – 1991 to 2001 Models

NOTE

A Service Manual for your vehicle is available at your local Harley-Davidson dealer.

Installation – 1991 to 2001 Models

⚠ WARNING

To protect against shock and accidental start-up of vehicle, disconnect the battery cables, negative cable first, before proceeding. Inadequate safety precautions could result in death or serious injury.

⚠ WARNING

Always disconnect the negative battery cable first. If the positive battery cable should contact ground with the negative cable installed, the resulting sparks may cause a battery explosion which could result in death or serious injury.

1. Remove lens from rear directional housing on right side of vehicle. Remove bulb from directional housing socket.
2. **1991 – 1998 models only:** See Figure 2. Trace right directional wire routing along underside of rear fender. Remove cable strap located on top side of rear fender near the rubber grommet. Gently pull wire rearward along underside of fender and into directional housing to allow for additional length of wire within directional housing.
3. **1999 – 2001 models only:** Cut wire within directional housing about 3/4 in. away from point where wire enters directional housing support. From underside of rear fender, withdraw end of wire that is within directional housing support.
4. **1992 and earlier models only:**
 - a. Remove (by turning counterclockwise) right rear directional housing and lockwasher from its support.
 - b. Remove the locknut and flat washer, from underside of rear fender, securing the right-rear directional housing support. Remove the directional-housing support from the right-rear fender support. Discard original directional housing support. Save mounting nut and washer.
5. **1993 and later models only:** Remove and discard 5/16 in. bolt and star washer securing rear directional to fender. Bolt and washer are located on inside of fender.
6. Remove the button-head screw and flat washer from middle of right-rear fender support. Discard screw; save flat washer.
7. See Figure 1. Install lockwasher and right-rear directional housing onto short threaded end (5/16-23 x 3/8 in.) of one rear-directional housing support from kit. Tighten securely. Take care to avoid scratching or marring component chrome finish.
8. **1993 and later models only:** Install chrome snap cap in fender-strut hole previously used for directional wire.
9. Position right saddlebag support bar from kit to right rear fender support. Insert long threaded end of rear directional housing support (now part of the directional housing/support assembly) through rear mounting hole in saddlebag support bar, rear fender support, sissy bar side plate and rear fender. See service parts page for exact hole locations.
10. Install original flat washer and locknut onto directional housing on underside of rear fender. Tighten finger tight.
11. Insert one chrome button head bolt (from kit) with one original flat washer through front mounting hole in saddlebag support bar, rear fender support, sissy bar side plate and rear fender and into rear fender strut bracket. Tighten bolt to 15 ft-lbs (20 Nm).
12. Align rear directional housing so that its lens, when installed, will be aimed rearward for proper visibility. While holding directional housing in position, tighten locknut to 22 ft-lbs (29 Nm).

13. Insert loose right directional wire (beneath fender) through hollow directional housing support and into directional housing.
14. Reconnect right directional wires within directional housing using wire connector from kit. Wrap the connector with electrical tape. Tuck wire connector assembly within available space alongside lamp socket.
15. Install the bulb into the right directional-housing socket. Fasten the lens to the directional housing.
16. Repeat steps 1 – 15 for the left saddlebag support bar.
17. Gently pull wire forward along underside of fender through the grommet and into the area under the seat. Install cable strap from kit to replace strap removed in step 2.

⚠ WARNING

Always connect the positive battery cable first. If the positive cable should contact ground with the negative cable installed, the resulting sparks may cause a battery explosion which could result in death or serious injury.

18. Reconnect the battery cables to battery, positive cable first.

⚠ WARNING

Test directionals after finishing the installation. Weak, intermittent, or non-operational lights may indicate a poor connection or a short circuit in wires. The motorcycle must never be operated in this condition. Operating a motorcycle in this condition could result in death or serious injury.

Inspect bulb and socket. Examine wires for bare spots or loose connectors. After securing components, test directionals again for satisfactory operation.

19. Test both directionals for proper operation.
20. **1993 and later models only:** Install rubber plug in wire hole in directional housing.

Installation – 2002 and Later Models

⚠ WARNING

To protect against shock and accidental start-up of vehicle, disconnect the battery cables, negative cable first, before proceeding. Inadequate safety precautions could result in death or serious injury.

⚠ WARNING

Always disconnect the negative battery cable first. If the positive battery cable should contact ground with the negative cable installed, the resulting sparks may cause a battery explosion which could result in death or serious injury.

NOTE

The connection for directionals is inside the tail-lamp housing.

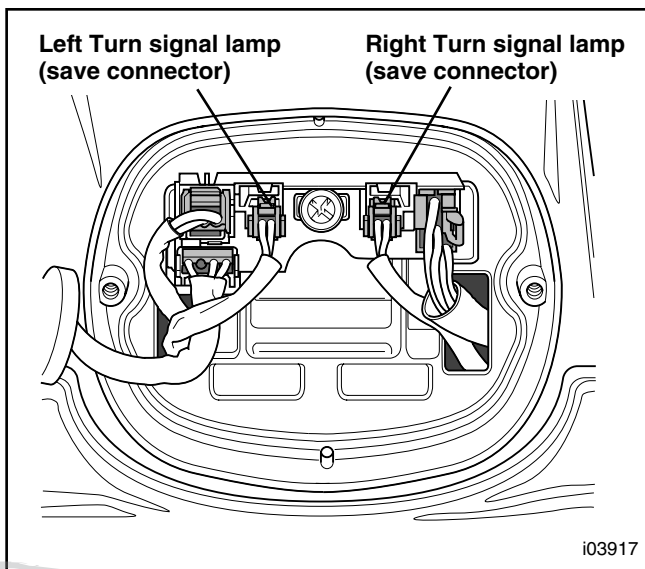

Figure 2. Turn-Signal Connectors

1. Remove the rear directionals from the vehicle according to applicable Service Manual instructions. Save the connector on the end of each set of wires, with a length of wire and conduit. Discard all other hardware. For installation, note how the wires are routed inside the fender.
2. See the Service Parts illustration. Remove the stock screw from the fender cover as indicated.
3. Feed the directional wires through the directional stalk and thread the directional lamp (separate purchase) onto the end of the directional stalk.

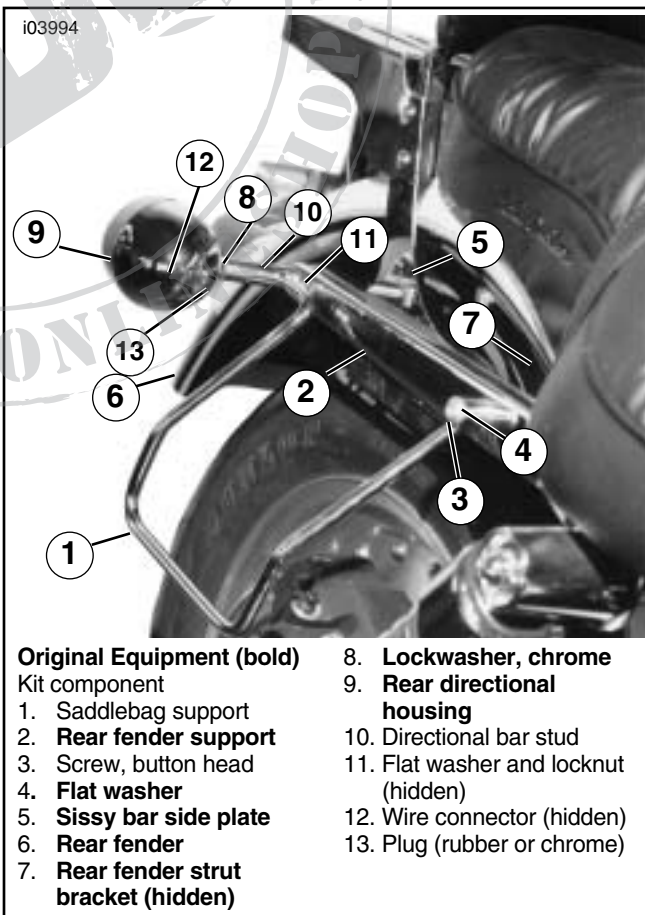

Figure 1. Right Saddlebag Support Bar Installed on FXD

4. Route the directional wires through the hole in the fender as shown in Figure 1. Measure the wires for length into the tail-lamp housing. Allow enough wire for termination. Remove the measured wires from the fender and cut the wires to length.
5. Install the chrome snap cap in the fender-strut hole previously used for directional wires.
6. Position right saddlebag support bar from kit to right rear fender support. Insert long threaded end of rear directional housing support (now part of the directional housing/support assembly) through rear mounting hole in saddlebag support bar, rear fender support, sissy bar side plate and rear fender. See service parts page for exact hole locations.
7. Install original flat washer and locknut onto directional housing on underside of rear fender. Tighten finger tight.
8. Insert one chrome button head bolt (from kit) with one original flat washer through front mounting hole in saddlebag support bar, rear fender support, sissy bar side plate and rear fender and into rear fender strut bracket. Tighten bolt to 15 ft-lbs (20 Nm).
9. Align rear directional housing so that its lens, when installed, will be aimed rearward for proper visibility. While holding directional housing in position, tighten locknut to 22 ft-lbs (29 Nm).
10. Reconnect right directional wires within directional housing using wire connector from kit. Wrap the connector with electrical tape. Tuck wire connector assembly within available space alongside lamp socket. Plug the connector back into the tail-lamp housing. Route the wires the same as the original equipment routing.

11. Repeat steps 1 – 10 for the left saddlebag support bar.

⚠ WARNING

Always connect the positive battery cable first. If the positive cable should contact ground with the negative cable installed, the resulting sparks may cause a battery explosion which could result in death or serious injury.

12. Reconnect the battery cables to battery, positive cable first.

⚠ WARNING

Test directionals after finishing the installation. Weak, intermittent, or non-operational lights may indicate a poor connection or a short circuit in wires. The motorcycle must never be operated in this condition. Operating a motorcycle in this condition could result in death or serious injury.

Inspect bulb and socket. Examine wires for bare spots or loose connectors. After securing components, test directionals again for satisfactory operation.

13. Test both directionals for proper operation.



Service Parts

Part No. 90589-91D

Date 9/98

Saddlebag Support Kit

sp90589c

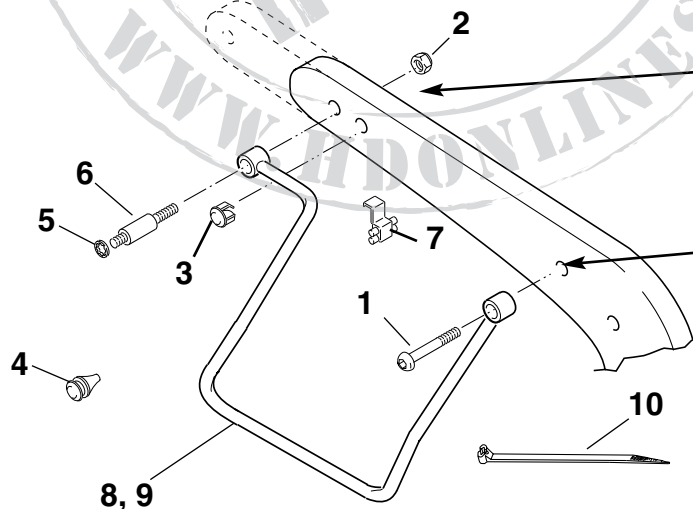

On FXD and FXDL models, the rear mounting point is the rear hole on the fender-support bracket. FXDWG mounts in the second to the last hole.

Remove stock screw from here.

Item	Description	Part Number	Item	Description	Part Number
1	Screw, button head (2)	4118	6	Directional bar stud (2)	68496-91
2	Locknut (2)	7776W	7	Wire connector (4)	70576-68
3	Plug (chrome) (2)	56239-93	8	Support, saddlebag - left	90590-91B
4	Plug (rubber) (2)	58758-93	9	Support, saddlebag - right	90591-91B
5	Lockwasher (2)	94081-90T	10	Cable strap	10006