



INSTRUCTIONS

-J05247

REV. 2011-02-11

SOFTAIL SWINGARM BAG

GENERAL

Kit Numbers

90200417, 90200456

Models

For model fitment information, see the P&A retail catalog or the Parts and Accessories section of www.harley-davidson.com (English only).

Kit Contents

Table 1. Service Parts

Item	Description (Quantity)	Part Number
	Swingarm bag kit, black	90200417
	Swingarm bag kit, brown	90200456
1	• Swingarm bag	Not sold separately
2	• Quick disconnect clip, male (2) (with buckle)	90200531
3	• Mounting strap/clamp (3)	90200577
4	• Protective tape (set of 2)	90200539
5	• Leather Care (0.75 oz.)	Not sold separately

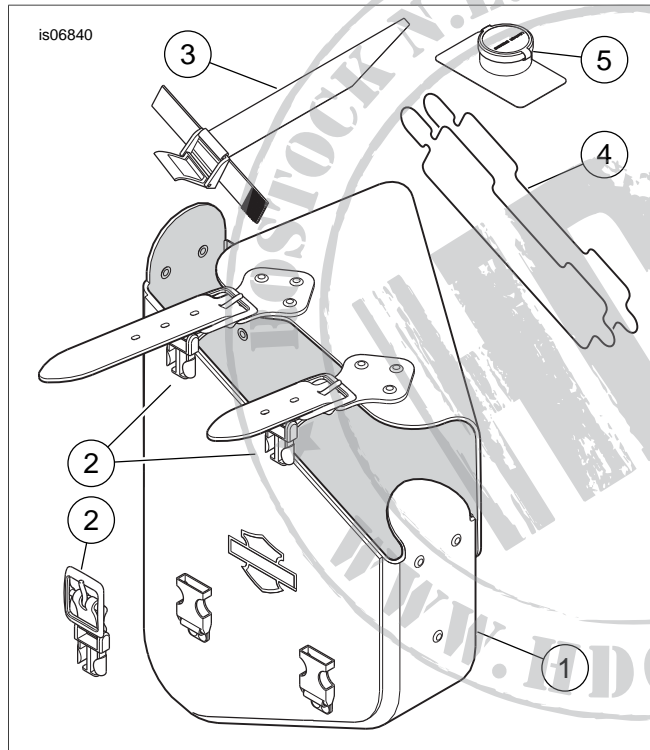

Figure 1. Service Parts, Softail Swingarm Bag

INSTALLATION

1. See Figure 2. Peel the backing from the protective tapes (1) and install to the swingarm (rear fork, 2) upper and lower bars.

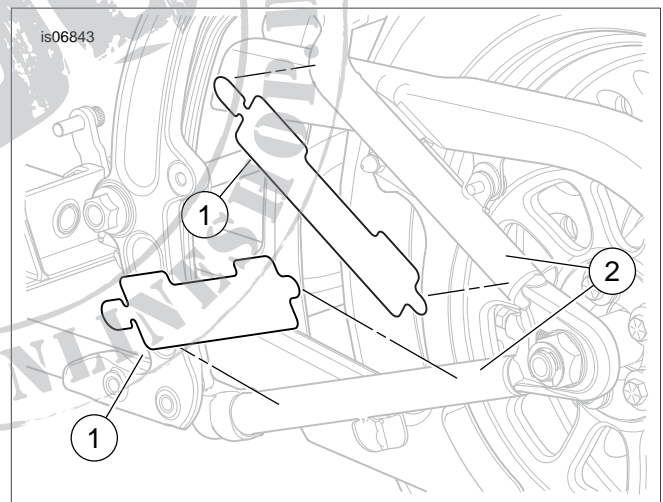

Figure 2. Install Protective Cover (2)

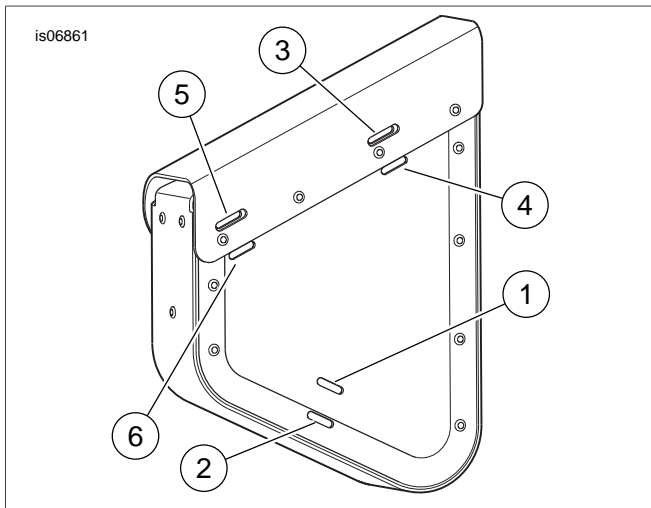

Figure 3. Bag Mounting Slots

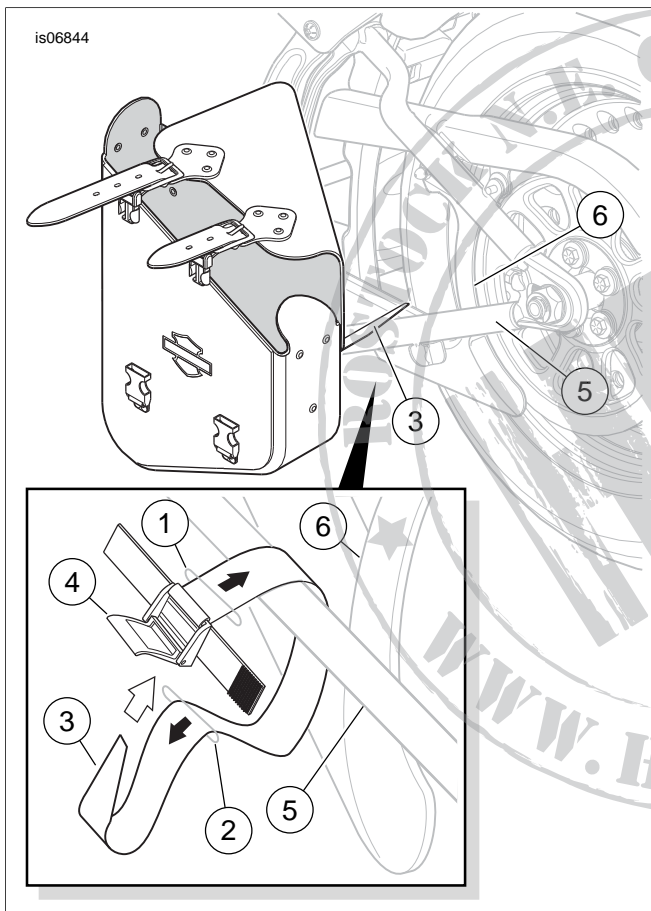

Figure 4. Attach Lower Strap

2. See Figure 3 and Figure 4. Open the bag and insert a mounting strap (3), from the inside, through the top slot (1) of the lower mounting point in the orientation shown. Wrap the strap around the lower swingarm bar (5) just in front of the debris deflector (6) and back through the bottom slot (2) in the bag. Attach the strap loosely to the clamp (4) to hold the saddlebag in place.

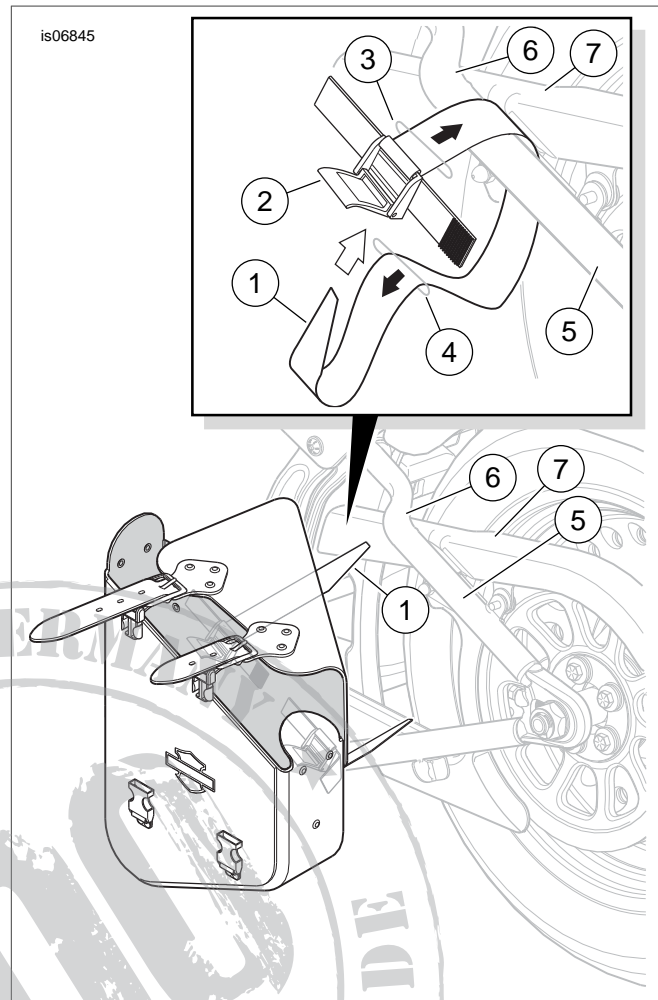

Figure 5. Attach Forward Strap

3. See Figure 3 and Figure 5. Insert a second strap (1) through the top slot (3) of the forward mounting point. Wrap the strap around the upper swingarm bar (5) just behind the bend (6). Work the strap rearward between the bar and the belt guard (7), and insert the strap end back through the bottom slot (4) in the bag. Attach the strap loosely to the clamp (2).

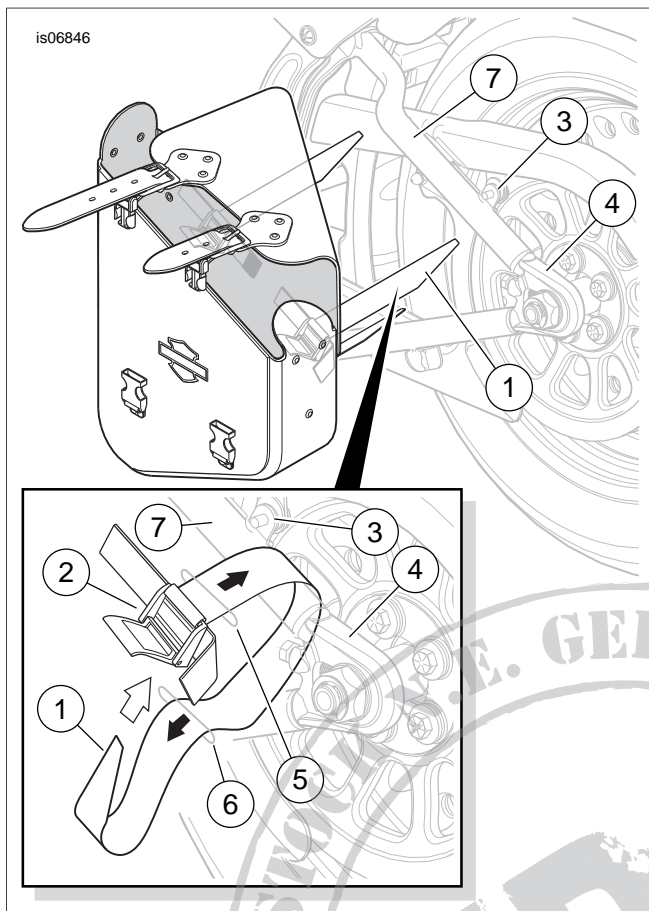

Figure 6. Attach Rearward Strap

- See Figure 3 and Figure 6. Insert the remaining strap (1) through the top slot (5) of the rearward mounting point. Wrap the strap around the upper swingarm bar (7) between the belt guard mount (3) and the swingarm end forging (4), and insert the strap end back through the bottom slot (6) in the bag. Attach the strap loosely to the clamp (2).

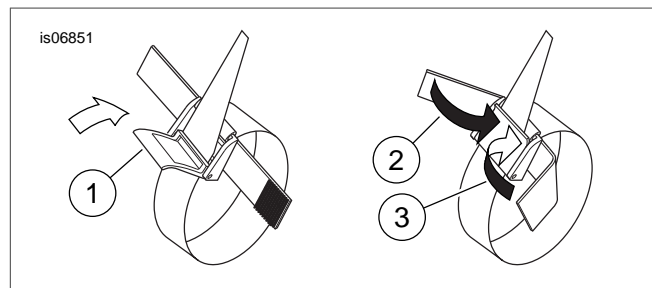

Figure 7. Lock Down and Secure Clamp

- See Figure 7. Tighten the forward strap as much as possible, and lock down the clamp (1). Fold the hook-and-loop straps (2 and 3) over the closed clamp to secure.
- Tighten the rearward strap as much as possible, and lock down the clamp. Fold the hook-and-loop straps over the closed clamp to secure.
- Tighten the lower strap as much as possible, and lock down the clamp. Fold the hook-and-loop straps over the closed clamp to secure.

NOTE

Even with the straps fully tightened, the saddlebag may still feel loose. This is normal.

IN USE

⚠ WARNING

Do not exceed swingarm bag weight capacity. Too much weight in swingarm bag can cause loss of control, which could result in death or serious injury. (00618c)

NOTE

Maximum swingarm bag weight capacity is 5 lbs. (2.3 kg).

Use the Leather Care from the kit regularly to preserve the appearance and extend the life of the swingarm bag. Additional leather care products are available from a Harley-Davidson dealer.