



INSTALLATION

INNER PRIMARY COVER

8397

PARTS INCLUDED

- 1 Inner Primary Cover (front)
- 1 Inner Primary Cover (rear)
- 1 Hardware Kit Containing:
 - 1 1/4"-20 x 5" Socket Head Cap Screw
 - 2 1/4"-20 x 1-1/2" Socket Head Cap Screw
 - 1 #10-24 x 1/2" Button Head Cap Screw
 - 3 Aluminum Locating Washers
 - 5 1/4" Hot Spots
- 1 Installation Instructions

Please read and understand entire instructions before starting installation.

THANK YOU FOR CHOOSING KÜRYAKYN!

IN ORDER TO PROTECT YOU AND OTHERS FROM POSSIBLE INJURY AND/OR PROPERTY DAMAGE OR LOSS, PLEASE PAY CLOSE ATTENTION TO ALL INSTRUCTIONS, WARNINGS, CAUTIONS AND ATTENTION NOTES REGARDING THE USE AND CARE OF THIS PRODUCT.

WARNING! THIS INDICATION ALERTS YOU TO THE FACT THAT IGNORING THE CONTENTS DESCRIBED HEREIN CAN RESULT IN POTENTIAL DEATH OR SERIOUS INJURY.

ATTENTION! This indication alerts you to the fact that ignoring the contents described herein may negatively affect product performance and functionality.

CAUTION! This indication alerts you to the fact that ignoring the contents described herein can result in potential injury or material damage.

TOOLS SUGGESTED

Set of Hex Wrenches, Torque Wrench (in/lbs) with Hex Sockets

STRICTLY OBSERVE THE FOLLOWING GUIDELINES IN ORDER TO USE THE PRODUCT PROPERLY AND AVOID POTENTIALLY DANGEROUS ACCIDENTS.

STEP 1 Read and understand all steps in the instructions before starting the installation. Park the motorcycle on a hard, level surface and turn off the ignition. Let cool.

WARNING! YOU WILL BE WORKING AROUND THE ENGINE AND EXHAUST SYSTEM DURING INSTALLATION. ENSURE THAT THE ENGINE AND EXHAUST SYSTEM HAVE FULLY COOLED TO PREVENT INJURY.

NOTE: The rear cover is intended primarily for use on bikes with staggered dual or 2-1 exhaust systems. Due to manufacturing variations in cross-over and true dual systems, it may not always be possible to utilize the rear cover. If it is determined that exhaust pipe clearance prevents the installation of the rear cover, disregard references to the rear cover for the remainder of the installation.

CUSTOMER SERVICE

877.370.3604 (toll free)

INSTALLATION QUESTIONS

techsupport@kuryakyn.com
or call 715.247.2983

LIMITED WARRANTY

Kuryakyn warrants that any Kuryakyn products sold hereunder, shall be free of defects in materials and workmanship for a period of one (1) year from the date of purchase by the consumer excepting the following provisions:

- Kuryakyn shall have no obligation in the event the customer is unable to provide a receipt showing the date the customer purchased the product(s).
 - The product must be properly installed, maintained and operated under normal conditions.
 - Kuryakyn makes no warranty, expressed or implied, with respect to any gold plated products.
 - Kuryakyn shall not be liable for any consequential and incidental damages, including labor and paint, resulting from failure of a Kuryakyn product, failure to deliver, delay in delivery, delivery in nonconforming condition, or for any breach of contract or duty between Kuryakyn and a customer.
- Kuryakyn products are often intended for use in specific applications. Kuryakyn makes no warranty if a Kuryakyn product is used in applications other than intended.
- Kuryakyn electrical products are warranted for one (1) year from the date of purchase by the consumer. L.E.D.'S contained in components of Kuryakyn products will be warranted for defects in materials and workmanship for 3 years from the date of purchase where as all other components shall be warranted for one(1) year. This includes, but is not limited to; control modules, wiring, chrome & other components.
- Kuryakyn makes no warranty of any kind in regard to other manufacturer's products distributed by Kuryakyn. Kuryakyn will pass on all warranties made by the manufacturer and where possible, will expedite the claim on behalf of the customer, but ultimately, responsibility for disposition of the warranty claim lies with the manufacturer.

ABOUT OUR CATALOG

For purchasing Kuryakyn® products, you can receive a complete catalog free of charge. Send the Proof-of-Purchase below with your address to: Kuryakyn, P.O. Box 339, Somerset, WI 54025. Please indicate either Accessories Catalog for Harley-Davidson® or GL & Metric Cruisers.

Be sure to ask your local dealer about other Kuryakyn® products, the motorcycle parts and accessories designed for riders by riders.

©2005 Kuryakyn USA® All Rights reserved.



kuryakyn.com

STEP 2 If you are able to use the rear cover, remove the fastener shown in PIC 1.

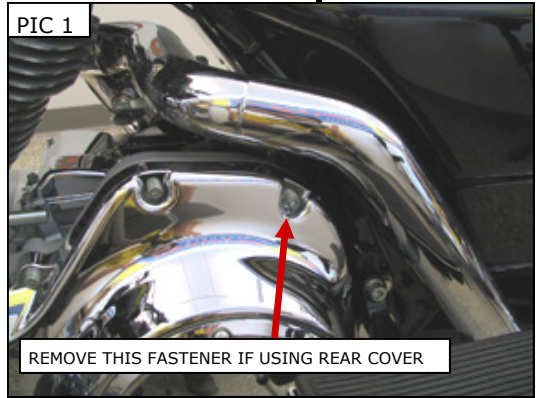

STEP 3 Remove the three stock fasteners shown in PIC.2.

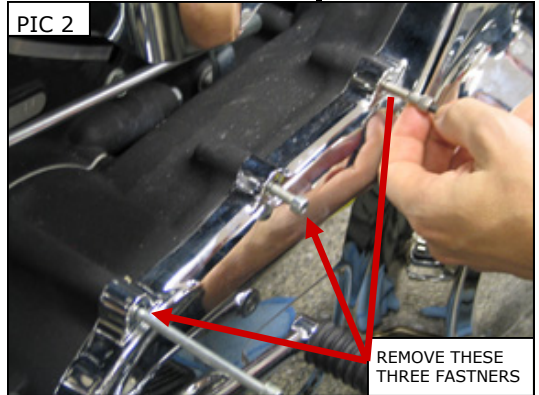

STEP 4 If using the rear cover: Position the cover assembly so that the tab in the front cover aligns with the slot in the rear cover. Fasten the front and rear covers together with the #10-24 X 1/2" button socket cap screw; leave the fastener loose for now.

STEP 5 Install the included 1/4"-20 x 5" socket head cap screw in the front hole on the cover. Install the included 1/4"-20 x 1-1/2" socket head cap screws in the next two holes. Place an aluminum locating washer over the protruding end of each 1/4"-20 fastener; ensure that the round side of the washer is facing toward the hole in the primary chain case. FIG 1

STEP 6 Position the cover assembly in place. Slide the rear section of the cover assembly into place and then pivot the front section into place. Be patient, this may take some finesse. Tighten the #10-24 fastener at this time.

STEP 7 Align the cover; push down on the inside edge of the Inner Primary Cover as you snug the 1/4"-20 fasteners. Reuse the OEM fastener, removed in Step 2, to fasten the rear cover to the primary cover.

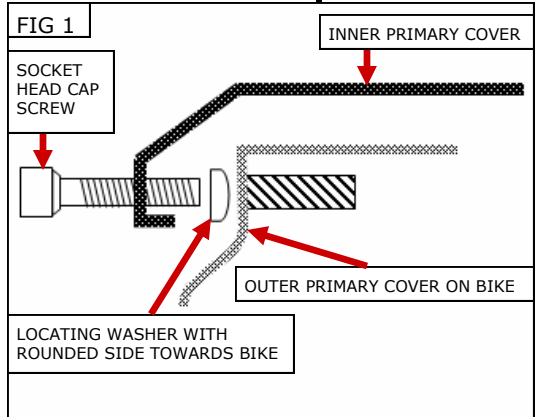

STEP 8 **Torque all of the primary cover fasteners to 108-120 in. lbs.** Check for proper shift-linkage operation and clearance before operating the motorcycle.

CAUTION! Ensure that the installation of this product does not interfere with the proper operation of the motorcycle before riding.

STEP 9 Install 1/4" Hot Spots in the top 5 primary cover screws.

ATTENTION ! It is the installers' responsibility to make sure all fasteners (including preassembled) are tightened before operation of motorcycle. Küryakyn will not warranty components that are lost due to improper installation. Periodic maintenance may be required.

Ride On!