



INSTRUCTIONS

-J01352

REV. 6-12-98

Kit Number 75012-82D

OIL PRESSURE GAUGE KIT

General

This kit is designed for installation on 1982 and later Shovelhead/Evolution 1340 models. Vehicles with a crossover connector or "S" shaped collector pipe must use Oil Gauge Mounting Kit, Part No. 75009-88A.

NOTE

Oil Pressure Gauge Mounting Kit, Part No. 75009-88A will not fit 1993 and later Evolution models that are equipped with a Screamin' Eagle air cleaner kit or Screamin' Eagle carburetor kit.

Installation

NOTE

Warning light for low oil pressure will function normally. Gauge installation will not affect warning light operation.

1. See Figure 1. for mounting location on right side of gearcase next to rear tappet guide housing.

NOTE

Notice the orientation of screen spring and screen before removal for proper orientation during reassembly.

2. Remove cap, O-ring, screen spring, and screen.

CAUTION

Make sure oil screen mesh is not plugged. It is possible for oil screen to be plugged or partially plugged with debris and still permit light to pass. Clean or replace plugged or partially plugged screen. See your Harley-Davidson dealer for replacement screen.

3. Reinstall oil screen spring and screen. Bend top of oil screen into a "V" shape to fit adapter fitting.

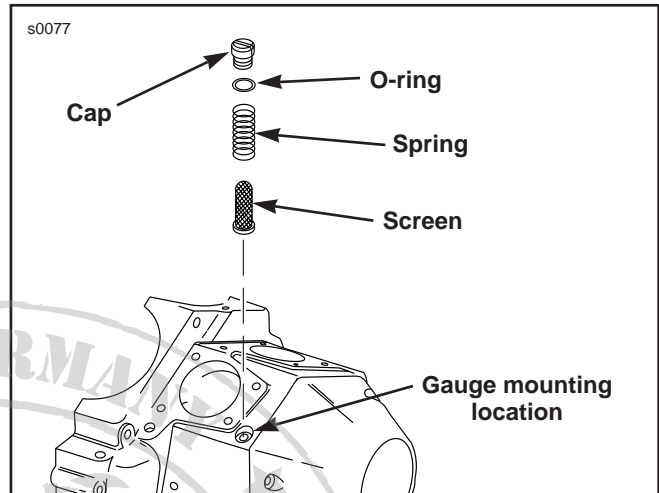

Figure 1. Gauge Mounting Location

4. Install new O-ring on adapter plug from kit and install in gearcase. Tighten to 3 ft-lbs.

IMPORTANT NOTES

- Use teflon tape or LOCTITE pipe sealant on all threads except adapter plug. Do not install tape over ends of threads as loose pieces of tape will clog gauge.
 - Pointer not at zero is a result of pressure inside the gauge from shipping by airplane. Burping the gauge by slightly lifting the rubber fill plug will relieve the pressure. Hold gauge so rubber plug is in the 12 O'Clock position to reduce oil spillage.
5. Install 45° fitting so that it is correctly positioned for installation of the gauge. Install gauge, but do not overtighten.



Service Parts

Part No. 75012-82D

Date 6/98

Oil Pressure Gauge Kit

sp75012-82D

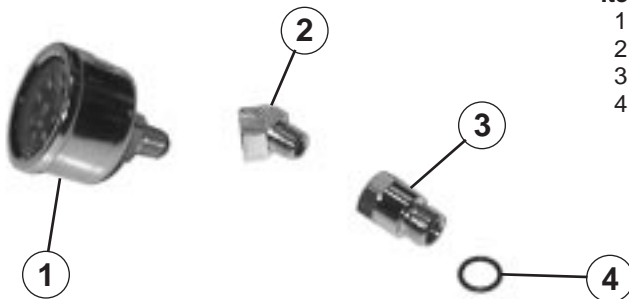

Item	Description	Part No.
1	Gauge	75082-94A
2	45 degree fitting	75085-94
3	Adapter fitting	75083-94
4	O-ring	11105