



# INSTRUCTIONS

-J01314

REV. 6-27-03

Kit Number 74615-01, 14619-01, 74618-01, 14620-01, 74621-01, 74615-01

## CHROME COIL COVER KIT FOR DYNA AND SOFTAIL

### General

This kit is designed for installation on all 1999 - 2003 Dyna and 2000 and later Softail (except those equipped with EFI) model motorcycles.

See Service Parts Page Illustration for kit content.

#### NOTE

A Service Manual for your motorcycle is available from your Harley-Davidson Dealer.

### Installation

#### WARNING

To prevent accidental vehicle start-up, which could cause death or serious injury, disconnect negative (-) battery cable before proceeding.

1. Disconnect the negative battery cable.
2. See Figure 1. Remove the two plug wires from the coil and note their position.
- 3a. If there is an existing coil cover, perform the following:
  1. Remove coil cover mounting screws, washers and spacer(s). Discard cover and spacers. Save mounting screws and washers for re-installation.
  2. Disconnect 3-place connector and remove coil.
- 3b. If there is not an existing coil cover, remove two coil mounting screws and washers, then disconnect 3-place connector. Save screws and washers for re-installation.
4. See Service Parts Page Illustration and Figure 2. Orient coil and rear coil cover (Part Number 74619-01) as shown. Reconnect 3-place connector and install coil and rear cover to electrical panel bracket using screws saved in Step 3. Tighten securely.

#### NOTE

To reduce the length of the exposed threads of the back side of the cover on FXDWG and FXDL models, the stock coil mounting screws can be replaced with HD part number 960.

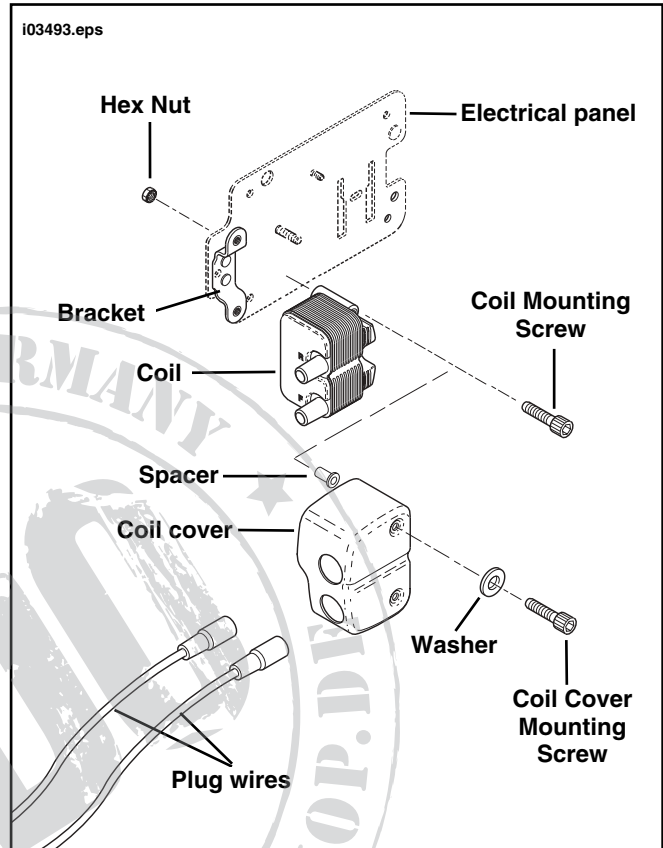

Figure 1. Stock Coil (Dyna Shown)

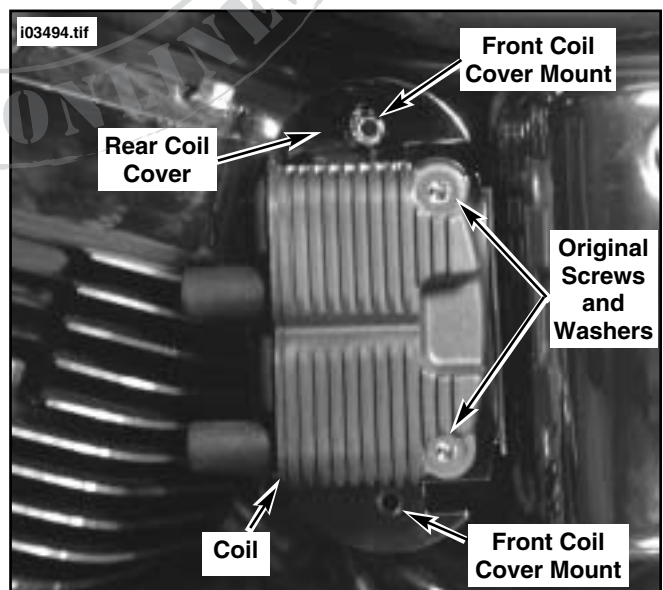

Figure 2. Install Rear Coil Cover and Coil (Dyna Shown)

- See Service Parts Page Illustration and Figure 3. Obtain spacers (Part Number 74621-01) and two 3 inch countersunk screws (Part Number 74620-01) from kit. Using spacers (with tapered side facing front cover), orient front coil cover (Part Number 74618-01) as shown and install over rear coil cover using screws. Do not tighten completely at this time.

**NOTE**

*Install screws through front cover, then slide spacers onto screws. Use hex wrench from kit to tighten screws.*

- Attach spark plug wire boots through coil cover holes and onto coil terminals.
- Adjust cover to center spark plug wire boots in coil cover holes.
- Tighten two screws to secure front coil cover to rear coil cover.
- Connect negative battery cables.

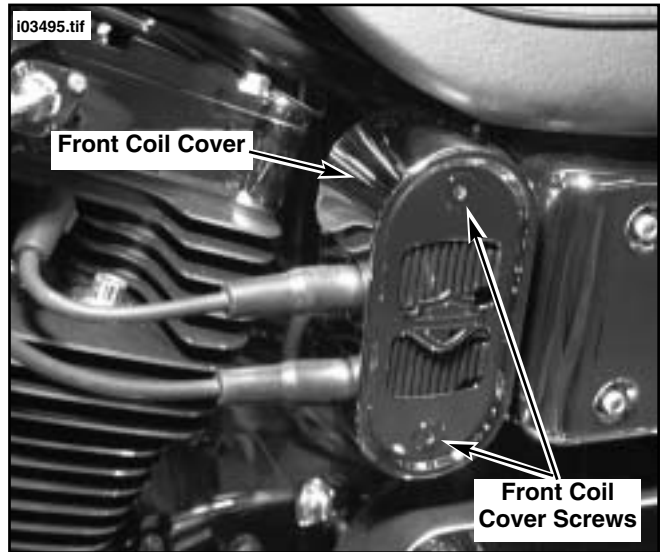

**Figure 3. Install Front Coil Cover (Dyna Shown)**



# Service Parts

Part No. 74615-01

Date 1/01

Dyna/Softail Coil Cover Kit

i03496.eps

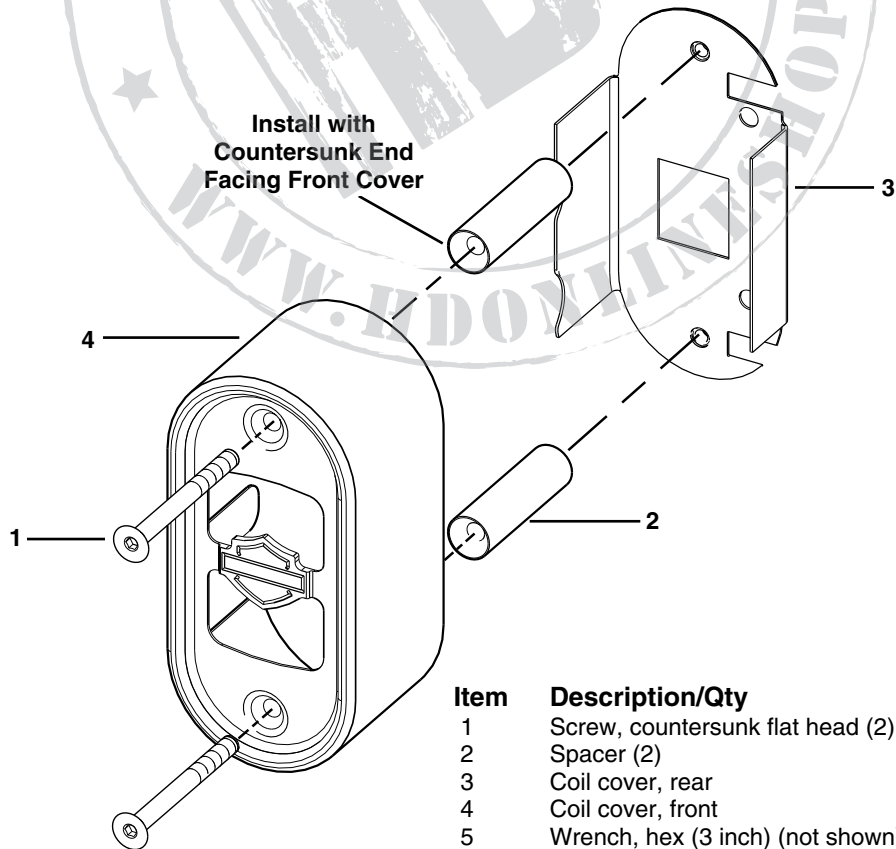

Item	Description/Qty	Part Number
1	Screw, countersunk flat head (2)	74620-01
2	Spacer (2)	74621-01
3	Coil cover, rear	Not sold
4	Coil cover, front	Not sold
5	Wrench, hex (3 inch) (not shown)	Not sold