



## BLACK LED SPEAKER BEZELS

# 7286

THANK YOU FOR CHOOSING KÜRYAKYN!

**PROTECT YOURSELF AND OTHERS FROM POSSIBLE INJURY AND PROPERTY DAMAGE OR LOSS. PAY CLOSE ATTENTION TO ALL INSTRUCTIONS, WARNINGS, CAUTIONS, AND NOTICES REGARDING THE INSTALLATION, USE, AND CARE OF THIS PRODUCT.**

	<b>THIS INDICATION ALERTS YOU TO THE FACT THAT IGNORING THE CONTENTS DESCRIBED HEREIN CAN RESULT IN POTENTIAL DEATH OR SERIOUS INJURY.</b>
	<b>This indication alerts you to the fact that ignoring the contents described herein can result in minor or moderate potential injury.</b>
	<b>This indication alerts you to the fact that ignoring the contents described herein may negatively affect product performance and functionality or damage the product itself or the product to which it is being attached.</b>

### MAKE SURE THE FOLLOWING PARTS HAVE BEEN INCLUDED IN THE KIT:

- 1 Right Speaker Bezel
- 1 Left Speaker Bezel
- 1 Speaker Light Hardware Kit containing:
  - 2 #10 X 1-1/4" Pan Head Screws — **TYPICAL INSTALLATION ONLY**
  - Hardware Kit containing:
    - 2 3-Pin Female Connectors
    - 1 3-Wire 6-Pin Adapter
    - 2 Turn Signal Pigtales — **4-PIN ADAPTERS**
    - 1 Dielectric Grease Pack
    - 4 4" Cable Ties
    - 1 Tube of Silicone
  - Hardware Kit containing:
    - 2 #10 X 1-3/8" Pan Head Screws — **BOOM!™ AUDIO INSTALL ONLY**
    - 4 #10 X 2-1/4" Pan Head Screws — **BOOM!™ AUDIO INSTALL ONLY**
    - 2 Spacers — **BOOM!™ AUDIO INSTALL ONLY**
    - 2 Speaker Mesh Inserts
    - 2 Mounting Plates
  - Hardware Kit containing:
    - 12 #4 Pan Head Hi-Lo Screws
- 1 Installation Instructions

**CHROME OR BLACK, INSTALLATION IS THE SAME.**

### TOOLS SUGGESTED:

Set of Torx drivers, #1 Phillips Head screwdriver, marker, round file, and a set of hex wrenches

	<b>These installation instructions contain important information. Ensure that the end user receives this copy and is aware of its importance for future reference.</b>
--	--

- STEP 1** Read and understand all steps in the instructions before starting the installation. Park the motorcycle on a hard, level surface and turn off the ignition.

**CUSTOMER SERVICE**  
877.370.3604 (toll free)

**INSTALLATION QUESTIONS**  
techsupport@kuryakyn.com  
or call 715.247.2983

### LIMITED WARRANTY

Kuryakyn warrants that any Kuryakyn products sold hereunder, shall be free of defects in materials and workmanship for a period of one (1) year from the date of purchase by the consumer excepting the following provisions:

- Kuryakyn shall have no obligation in the event the customer is unable to provide a receipt showing the date the customer purchased the product(s).
  - The product must be properly installed, maintained and operated under normal conditions.
  - Kuryakyn makes no warranty, expressed or implied, with respect to any gold plated products.
  - Kuryakyn shall not be liable for any consequential and incidental damages, including labor and paint, resulting from failure of a Kuryakyn product, failure to deliver, delay in delivery, delivery in nonconforming condition, or for any breach of contract or duty between Kuryakyn and a customer.
- Kuryakyn products are often intended for use in specific applications. Kuryakyn makes no warranty if a Kuryakyn product is used in applications other than intended.
- Kuryakyn electrical products are warranted for one (1) year from the date of purchase by the consumer. L.E.D.'S contained in components of Kuryakyn products will be warranted for defects in materials and workmanship for 3 years from the date of purchase where as all other components shall be warranted for one(1) year. This includes, but is not limited to; control modules, wiring, chrome & other components.
- Kuryakyn makes no warranty of any kind in regard to other manufacturer's products distributed by Kuryakyn. Kuryakyn will pass on all warranties made by the manufacturer and where possible, will expedite the claim on behalf of the customer, but ultimately, responsibility for disposition of the warranty claim lies with the manufacturer.

### ABOUT OUR CATALOG

For purchasing Kuryakyn® products, you can receive a complete catalog free of charge. Send the Proof-of-Purchase below with your address to: Kuryakyn  
454 County Road V V  
Somerset, WI 54025-9031  
Please indicate either Accessories Catalog for Harley-Davidson® or GL & Metric Cruisers.

Be sure to ask your local dealer about other Kuryakyn® products, the motorcycle parts and accessories designed for riders by riders.

©2005 Kuryakyn USA® All Rights reserved.



## NOTICE

Avoid damage to the motorcycle. Protect painted surfaces with a soft cloth or service cover.

Kuryakyn®

- STEP 2** Remove the left side-cover; remove the main fuse.
- STEP 3** Remove the outer fairing. Refer to the model specific service manual for more information.
- STEP 4** Refer to **PIC 1**. Remove both existing speaker and spacer assemblies; there will be two (2) long screws (they will be reused) and one (1) short one on each side (it will NOT be reused).
- STEP 5** Peel the OEM mesh off of the speaker assemblies; remove any adhesive tape from the front of the spacers.

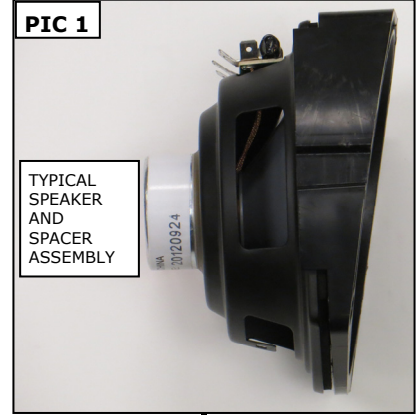

- STEP 6** Refer to **PIC 2**. Locate the included Right (brake-side) Mounting Plate; Position the Plate against the inside of the inner fairing as shown in **PIC 2**.

Align the screw holes with the screw bosses; using the notch on the top of the Mounting Plate as a guide, mark the inner fairing with a marker. Ensure that the Mounting Plate is oriented **exactly** as shown in **PIC 2**.

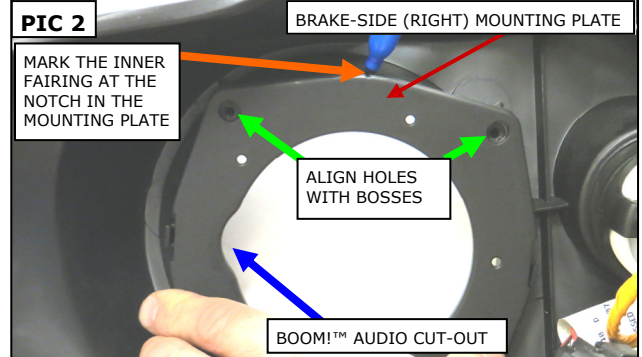

- STEP 7** Refer to **PIC 3**. Using a round file, remove about a 1/4" of material from the inner fairing at the mark made in **STEP 6**; the Speaker Bezel wiring will be routed through this notch between the Mounting Plate and inner fairing.

- STEP 8** Assemble an included Speaker Mesh in the recess of the Mounting Plate. The Mesh protrudes towards the rider when installed. Set the Mesh/Plate within arms reach of the work area.

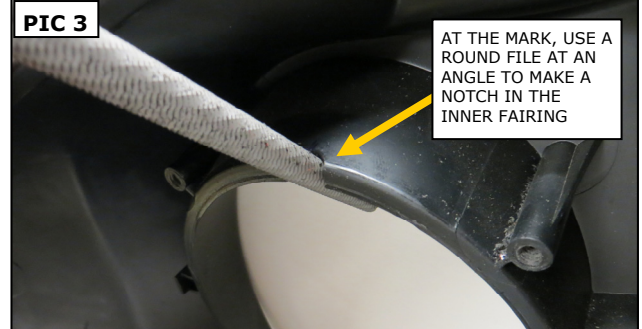

- STEP 9** Refer to **PIC 4**. Locate the Left and Right LED Speaker Bezels. Note that "LEFT" and "RIGHT" is molded into the backside.

**Left = Clutch side**  
**Right = Brake side**

- STEP 10** Refer to **PIC 5**. Position the Right LED Speaker Bezel in the inner fairing; route the wiring through the notch; align the Mesh/Plate with the five small screw holes in the Bezel and secure with five of the included #4 screws. **DO NOT OVERTIGHTEN THE SCREWS.**

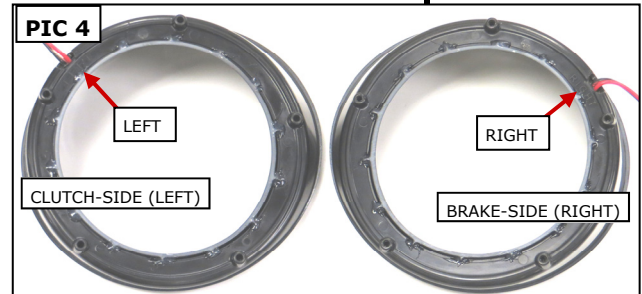

- STEP 11** Repeat **STEPS 6 through 10** for the other side.

**BOOM!™ Audio equipped installation skip to STEP 14.**

### **TYPICAL (NON-BOOM!™ AUDIO) INSTALL:**

- STEP 12** Reinstall the right side speaker assembly using two long screws (from **STEP 4**) and one of the included #10 X 1-1/4" Pan Head Screws.

- STEP 13** Repeat **STEP 12** for the other side. **DO NOT OVERTIGHTEN THE SCREWS!**

-cont.- Skip ahead to **STEP 18 or 20** (depending on model year).

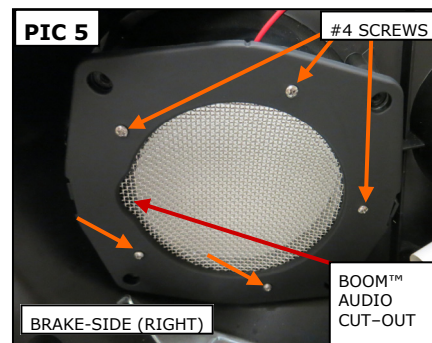

PAGE  
**2**

**BLACK LED SPEAKER BEZELS**

**INSTALLATION**

## BOOM!™ AUDIO TWEETER GRILL INSTALL:

**STEP 14** Locate the two (2) #10 X 1-3/8" Pan Head Screws, four (4) #10 X 2-1/4" Pan Head Screws, and the Spacers in the included hardware kit. Set them within arms reach of the work area.

**STEP 15** Align the BOOM!™ Audio Tweeter Grill with the Mounting Plate as shown in **PIC 6**. Ensure that the Tweeter fits in the cut out in the Mounting Plate.

**STEP 16** Secure the speaker assembly to the inner fairing using the two 2-1/4" screws in the top and one 1-3/8" screw in the bottom.

### **DO NOT OVER-TIGHTEN THE SCREWS!**

Locate and remove the screw shown in **PIC 7**; insert one of the included Spacers between the inner fairing and the metal inner-fairing brace; reinstall the screw.

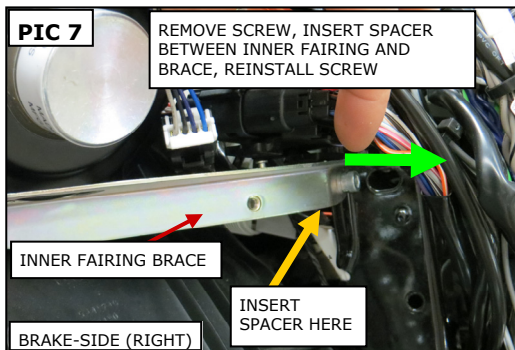
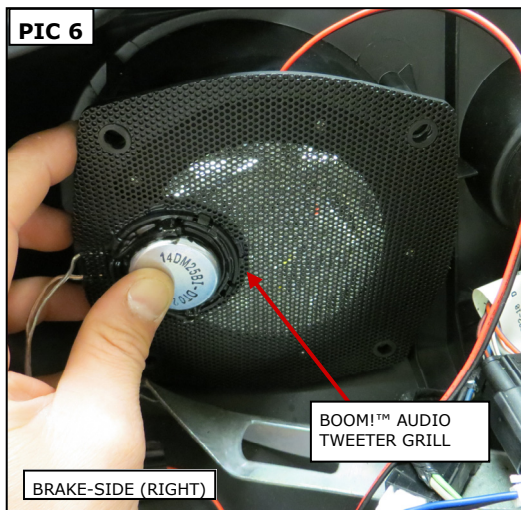

**STEP 17** Repeat **STEPS 15 and 16** for the other side. Move on to **STEP 18 or 20** (depending on the model year).

## 6-PIN ADAPTER FOR '00 THROUGH '05 MODELS:

**STEP 18** Refer to **PIC 8**. On the front-side of the inner fairing, locate the OEM 6-pin harness; it is generally located on the clutch-side. Disconnect the 6-pin harness.

**STEP 19** Locate the included 3-wire 6-Pin Adapter. Apply dielectric grease to each connector and connect it to the OEM harness. **SKIP TO STEP 22.**

## TURN SIGNAL PIGTAILS (4-PIN ADAPTERS) FOR '06 THRU '13 MODELS:

**STEP 20** Refer to **PIC 9**. Locate and separate the OEM right turn signal connector (4-pin). It is located close to the backside of the speaker. There will be one violet wire, one blue wire and one black wire coming out of the connector.

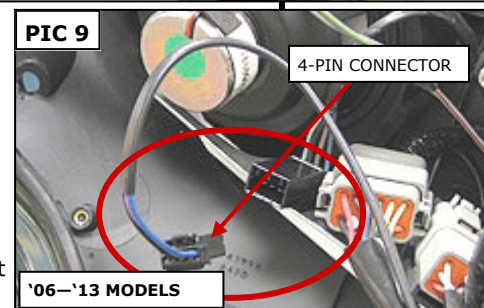
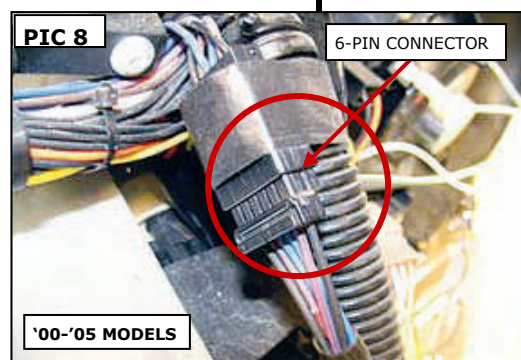



## NOTICE

Dielectric grease inhibits moisture and prevents corrosion. Kuryakyn recommends the use of the included dielectric grease on ALL electrical connections. Apply dielectric grease directly to mating surfaces.

**Kuryakyn**

- STEP 21** Apply dielectric grease to each connector. Connect one of the included Turn Signal Pigtails (4-Pin Adapters) as shown in **PIC 10**. Repeat **STEP 20 and 21** for the other side.

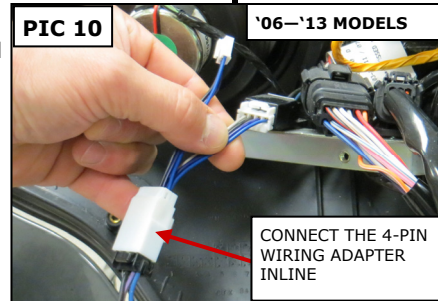

## BEZEL WIRING (ALL YEARS):

- STEP 22** Connect one of the included Black 3-Pin Connectors to one of the white 3-pin connectors on the Wiring Adapter (from **STEP 19 or 21**, depending on the model year).

- STEP 23** Refer to **PIC 11 and 12**. Push the pin terminal from the **RED** wire of the Speaker Bezel into the Black 3-Pin Connector across from the **BLUE** wire ('06 through '13 Wiring Adapter) or the **RED** wire ('00 through '05 Wiring Adapter). Ensure the lock tabs on the terminals lock into place in the connector.

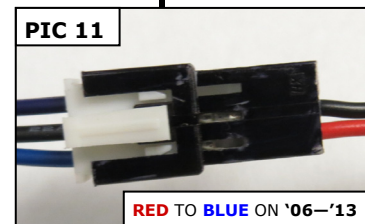

- STEP 24** Refer to **PIC 13**. Push the pin terminal from the **BLACK** wire into the 3-Pin Connector across from the **BLACK** wire on the Wiring Adapter. Ensure the lock tabs on the terminals lock into place in the connector. Repeat for the other side.

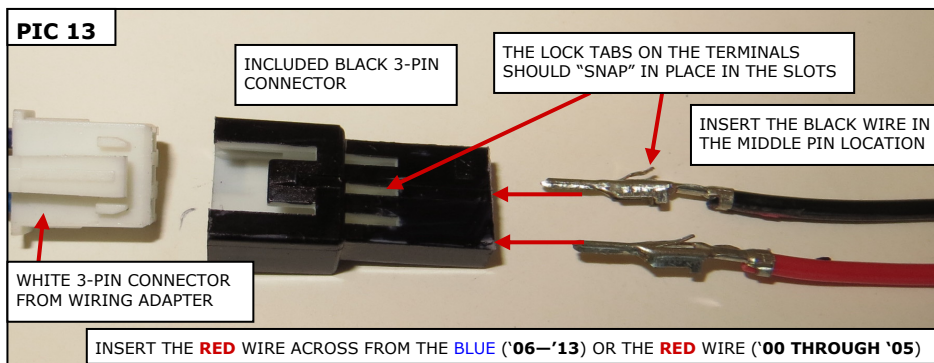
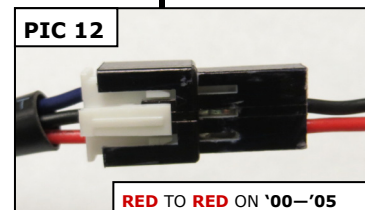

- STEP 25** Reinstall the main fuse. Turn the ignition on and make sure the Speaker Bezels and all other lights work properly; turn the ignition off when you are done checking. Reinstall the side cover.

- STEP 26** Secure the wires up and out of the way of pinch points with the included Cable Ties.

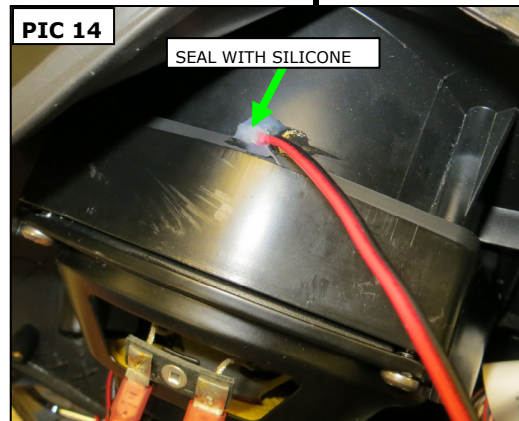

## NOTICE

Secure all wiring away from any moving parts, pinch points or extreme heat. Kuryakyn WILL NOT provide warranty coverage on any electrical component that fails due to pinched, crimped, broken, abraded, melted or frayed wires.

- STEP 27** Refer to **PIC 14**. Seal the notches drilled in the inner fairing with some of the included silicone. The silicone fully cures in 24 hours.

- STEP 28** Reconnect the headlight and reinstall the outer fairing in the reverse order it was removed.

## WARNING

VISIBILITY IS A MAJOR CONCERN FOR MOTORCYCLISTS. A LIGHT MALFUNCTION COULD RESULT IN DEATH OR SERIOUS INJURY. ENSURE PROPER LIGHT OPERATION BEFORE RIDING THE MOTORCYCLE.

## NOTICE

It is the end user's responsibility to ensure that all of the fasteners (including pre-assembled) are tightened before operation of the motorcycle. Kuryakyn will not provide warranty coverage on products or components lost or damaged due to improper installation or lack of maintenance. Periodic inspection and maintenance are required on all fasteners.

PAGE  
4

*Ride On!*

**BLACK LED SPEAKER BEZELS**

**INSTALLATION**