



INSTRUCTIONS

-J02636

REV. 7-18-02

Kit Number 71718-02

ROCKER SWITCH KIT FOR AUXILIARY ACCESSORY HOUSING

General

This kit is designed for use with all models using the Auxiliary Accessory Housing Kits (70256-02 [Right, Black], 70248-02 [Left, Black], 70255-02 [Right, Chrome] and 70213-02 [Left, Chrome]).

The rocker switch is designed to replace the existing switch for the following accessory kits:

Chrome Lamp Kit (Kit Numbers 68307-00 and 68320-00)

Passing Lamp Kit (Kit Number 68253-88A)

Fog Lamp Kit (Kit Number 68248-98)

Fog Lamp Kit (Kit Number 68913-98)

Pursuit Lamp Kit (Kit Number 68746-03)

NOTE

See Service Parts illustration for a list of kit contents.

NOTE

A Service Manual for your model motorcycle is available from your Harley-Davidson Dealer.

Installation

1. Remove the seat according to the applicable Service Manual instructions.

⚠ WARNING

To protect against shock and accidental start-up of vehicle, disconnect the negative battery cable before proceeding. Inadequate safety precautions could result in death or serious injury.

⚠ WARNING

Always disconnect the negative cable first. If the positive cable should contact ground with the negative cable installed, the resulting sparks may cause a battery explosion resulting in death or serious injury.

2. Disconnect battery cables, negative cable first.
3. Determine the desired location of the switch in the housing.
4. Remove two screws and the auxiliary accessory housing cover.
5. Remove the mounting bracket.
6. See Figure 1. Route the switch wires (1) through the opening in the mounting bracket (2), and engage the groove (3) on the bottom of the switch with the edge of the opening opposite the locking tab (4). Seat the switch in the opening.
7. See Figure 2. Secure the switch to the mounting bracket by bending the locking tab over the flange at the front of the switch.

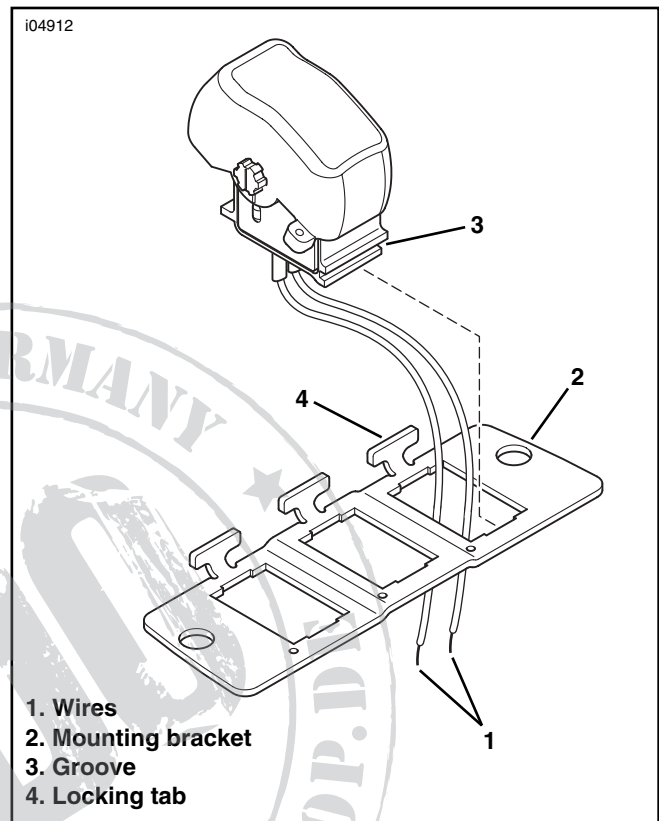

Figure 1. Install Rocker Switch in Mounting Bracket

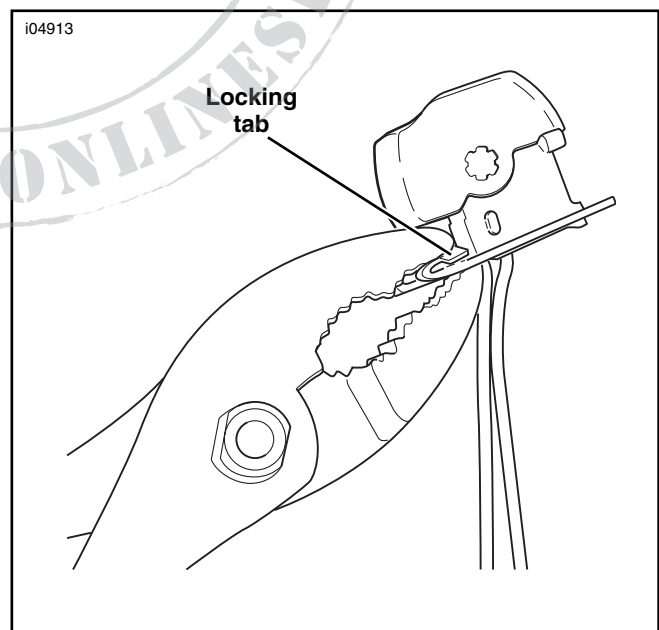

Figure 2. Bend Locking Tab

NOTE

A length of conduit is supplied with the kit. If installing several switches/accessories, a larger diameter conduit may be required to enclose all wires and connections from the auxiliary switch housing. The following conduit sizes are available from your Harley-Davidson Dealer:

| Conduit | Diameter | Part No. |
|---------|-------------------|----------|
| No. 8 | 0.133 in. (3 mm) | 70559-71 |
| No. 2 | 0.263 in. (7 mm) | 70554-69 |
| 5/6 | 0.312 in. (8 mm) | 70556-71 |
| 3/8 | 0.375 in. (10 mm) | 70552-69 |
| 7/16 | 0.438 in. (11 mm) | 70553-69 |
| 1/2 | 0.500 in. (13 mm) | 70558-71 |

8. See Figure 3. Slide the conduit over the switch wires until the conduit is as close to the bottom of the switch as possible. Secure the conduit using a cable strap.

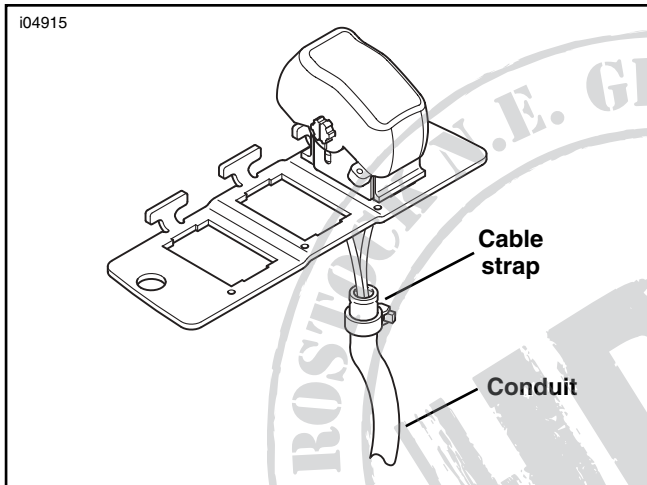

Figure 3. Install Conduit

NOTE

If several switches/accessories are being installed, wires/conduit may be routed through both the upper and lower holes in the lower housing. Always route wires/conduit through the lower hole first and use the upper hole as needed.

Kits for right side applications will not require a housing plug or allow wires/conduit to be routed through the upper hole in the lower housing.

9. See Figure 4. Install the switch bracket with switch(es) and/or accessories in the lower housing. Route the wires/conduit through the holes in the lower housing. (See Figure 5.)
10. See Figure 5. Install the housing plug (supplied with Auxiliary Accessory Housing Kit) in the upper hole if it is not being used.

NOTE

If installing multiple switches and/or accessories, hole plugs will need to be removed to allow installation. Refer to switch/Accessory kit installation instructions for specific location information.

In single switch/Accessory installation applications, hole plugs may need to be relocated to allow installation of the switch/Accessory in the desired position.

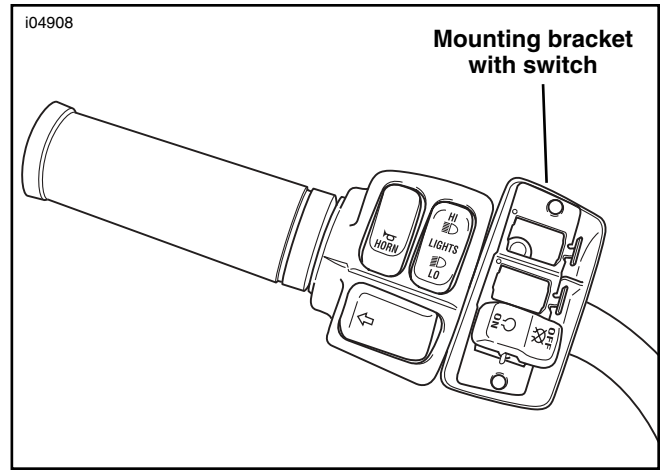

Figure 4. Install Mounting Bracket

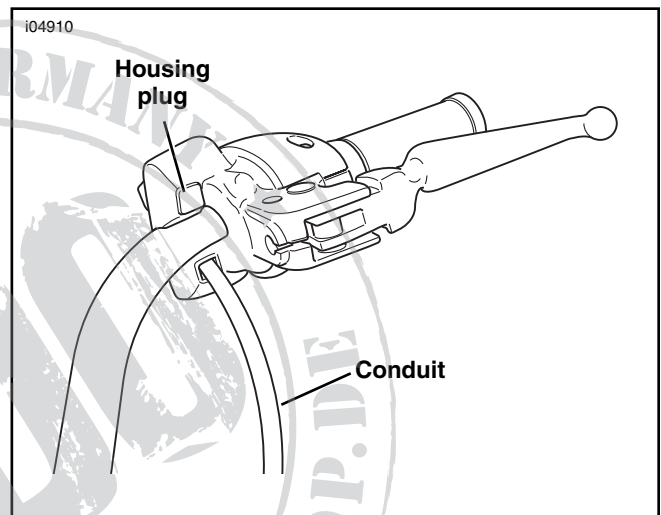

Figure 5. Switch/Accessory Wire/Conduit Routing

11. See Figure 6. Using a flat-bladed screwdriver, carefully compress the tab and remove the hole plug from the housing cover. If relocating the hole plug, snap the plug in the desired new location.

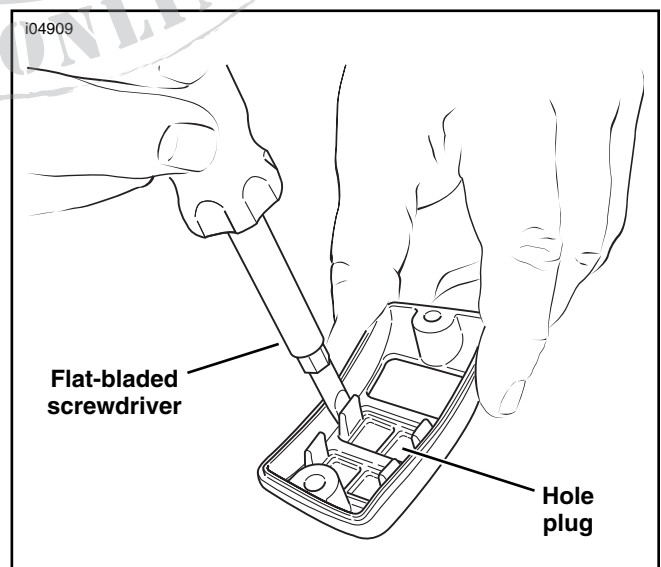

Figure 6. Remove/Reposition Hole Plug(s)

- See Figure 7. Install the housing cover using two button-head screws. Using a T-25 TORX driver, tighten screws to 35-45 **in-lbs** (4-5 Nm).

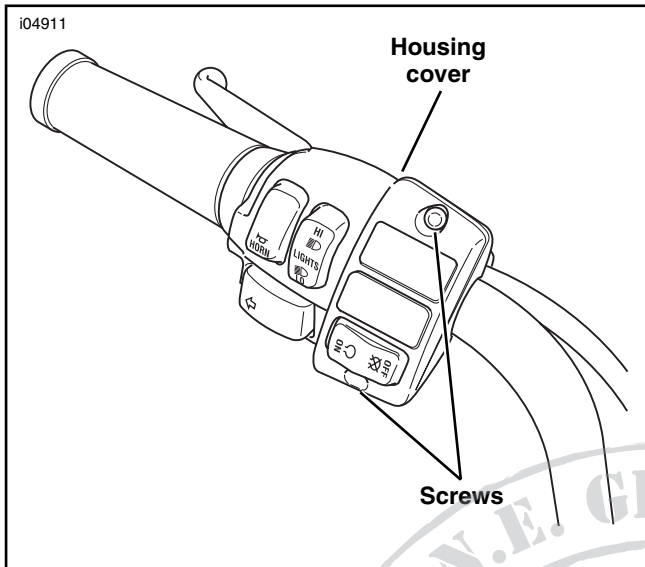

Figure 7. Install Housing Cover

- Determine the desired location of the rocker switch-to-accessory wire splice point(s) before cutting any wires. Allow enough slack in the wires to properly route the wires and to allow for fork movement.
- Trim the switch and accessory wires at the splice point, allowing approximately 1-2 in. (25-50 mm) of overlap on each wire.
- Remove approximately 3/8 in. (10 mm) of insulation from the ends of the switch and accessory wires.
- See Figure 8. Slide the heat-shrink tubing (1) over the accessory wire (2), and crimp the electrical connector (3) to the wire using an HD 38125-8 Crimping Tool.
- See Figure 8. Insert the end of the switch wire (4) into the electrical connector (3), and crimp the wire to the electrical connector (3) using an HD 38125-8 Crimping Tool.

⚠ WARNING

Use extreme caution when operating the UltraTorch UT-100 or any radiant heating device. Read the manufacturer's instructions carefully before using the tool. Improper tool handling can result in death or serious injury.

- Always keep hands away from the tool tip area and heat-shrink attachment.
- Avoid directing the heat toward any fuel system components. Extreme heat can cause fuel ignition/explosion.
- Avoid directing the heat toward any electrical system components other than the connectors on which the heat-shrink work is being performed.
- Be sure to turn the "ON/OFF" switch to the "OFF" position after use.

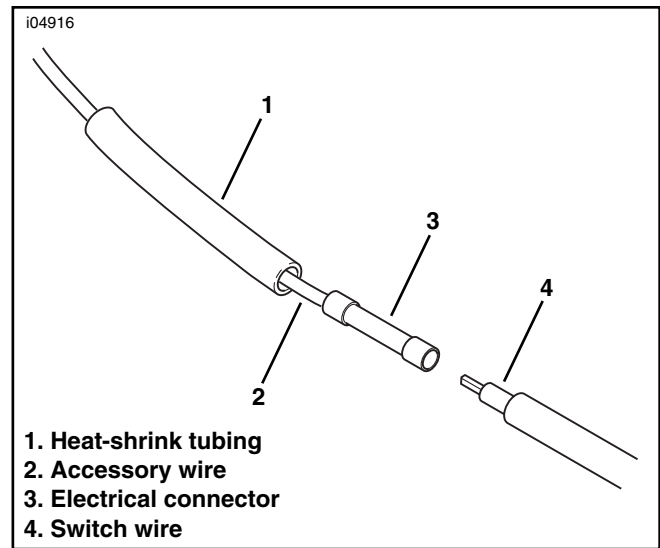

Figure 8. Connect the Rocker Switch Wires to the Accessory Wires

NOTE

Protect the heat-shrink tubing from the heat source while applying heat to the electrical connector.

- See Figure 8. Slide heat-shrink tubing (1) away from the splice and, using the UltraTorch UT-100 (HD 39969), Robinair Heat Gun (HD 25070) with Heatshrink Attachment (HD 41183), or radiant heating device, heat the crimped electrical connector (3). Apply heat from the center of the crimp out to each end until the meltable sealant exudes out of both ends of the connector. Let the connector cool.
- See Figure 8. Slide heat-shrink tubing (1) over the splice and, using the UltraTorch UT-100 (HD 39969), Robinair Heat Gun (HD 25070) with Heatshrink Attachment (HD 41183), or radiant heating device, heat the heat-shrink tubing to encapsulate the electrical connector. Apply heat from the center of the crimp out to each end.
- Repeat steps 16-19 for each switch wire-to-accessory wire connection.
- Remove the switch provided with the accessory kit, reference on page 1.
- Secure (or do not install) the switch/accessory wires to the frame using cable straps as needed.

⚠ WARNING

Always connect the positive battery cable first. If the positive cable should contact ground with the negative cable installed, the resulting sparks may cause a battery explosion resulting in death or serious injury.

- Install battery cables, positive cable first.

⚠ WARNING

After installing the seat, pull upward on the front of the seat to be sure it is locked in position. If the seat is loose, it could shift during vehicle operation and startle the rider, causing loss of control and death or serious injury.

- Install the seat according to the applicable Service Manual instructions.



Service Parts

Part No. 71718-02

Date 7/02

Rocker Switch Kit

104914

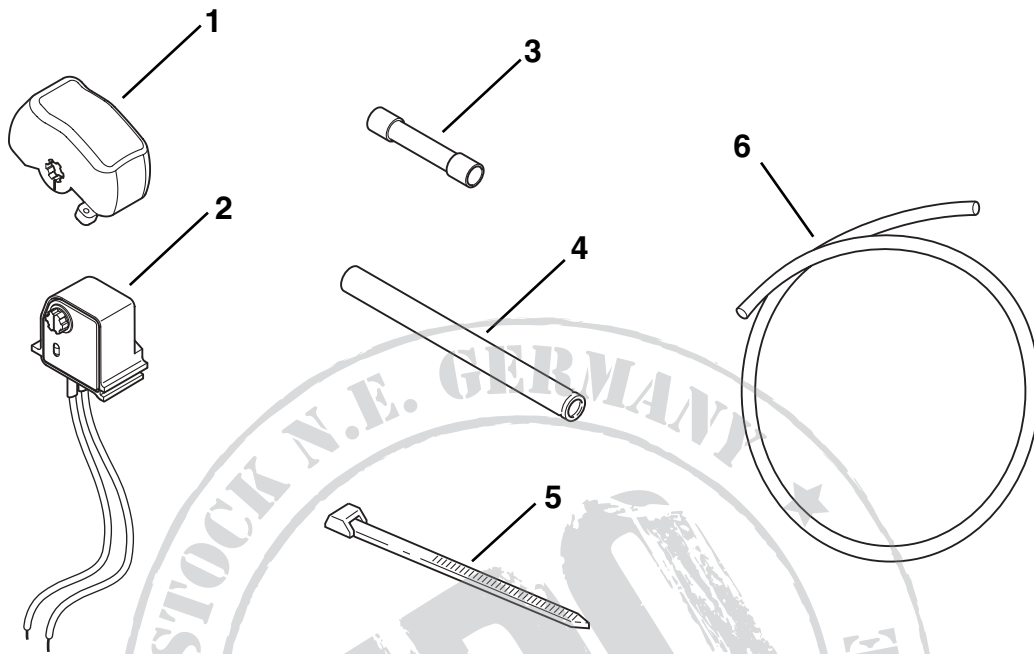

| Item | Description | Part No. |
|------|---|---------------------|
| 1 | Switch Cap, Rocker | 71608-02 |
| 2 | Switch, Rocker | 71607-02 |
| 3 | Connector, Pre-Insulated, Seal Splice (2) | 70586-93 |
| 4 | Heat-Shrink Tube, 2" (2) | 70585-93 |
| 5 | Strap, Cable (6) | 72266-94 |
| 6 | Conduit, Black PVC, 25" | Not sold separately |