



INSTRUCTIONS

-J00737

REV. 2007-08-17

TURN SIGNAL TRIM RINGS

GENERAL

Kit Number

69740-01 and 69749-05

Models

For model fitment information, please see the P&A Retail Catalog or the Parts and Accessories section of www.harley-davidson.com (English only).

Kit Contents

See Figure 1 and Table 1.

INSTALLATION

1. Remove turn signal lens
2. Place O-ring (4) in groove between lens and turn signal housing.
3. Reinstall signal lens.
4. Install the trim ring (3) onto the turn signal. Notches on turn signal lens must be aligned with notches on trim ring.
5. Secure trim ring with the provided screw (1) and nut (2). Tighten securely.
6. Repeat Steps 1-5 for the other turn signal.

SERVICE PARTS

See Figure 1 and Table 1.

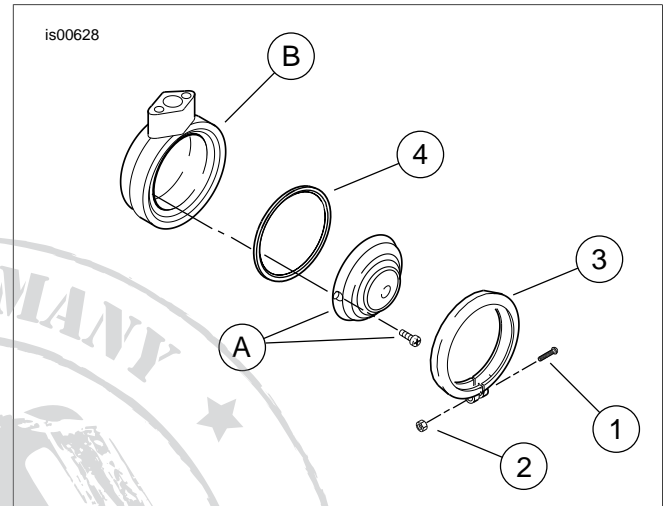

Figure 1. Service Parts: Turn Signal Trim Rings

Table 1. Service Parts: Turn Signal Trim Rings

| Item | Description (Quantity) | Part Number |
|---|-------------------------|---------------------|
| 1 | Screw | 3824 |
| 2 | Nut | 8006 |
| 3 | Trim Ring | Not Sold Separately |
| 4 | O-ring | 11371 |
| Items mentioned in text but not included in kit: | | |
| A | Original lens and screw | |
| B | Turn signal housing | |