



# INSTRUCTIONS

-J01599

REV. 2007-08-13

## 5-3/4 INCH HEADLAMP TRIM RING

### GENERAL

#### Kit Number

69624-99A, 69738-05

#### Models

For model fitment information, please see the P&A Retail Catalog or the Parts and Accessories section of [www.harley-davidson.com](http://www.harley-davidson.com) (English only).

#### Kit Contents

See Figure 2 and Table 1.

### INSTALLATION

1. Loosen screw from original equipment headlamp trim ring and remove ring. Save screw for later installation. Disconnect electrical connector from back of glass lens assembly temporarily to ease installation. Set mounting ring aside.
2. See Figure 1. If not already installed, place one rubber strip (2) in trim ring (1).
3. See Figure 2. Insert glass lens assembly (A) inside trim ring (2) as shown.

#### NOTE

*Rotating lens may help insertion.*

*Make sure the four gasket tabs (B) are placed inside trim ring or else they will interfere with final assembly.*

4. Replace mounting ring (C) by aligning mounting ring tab notches with main lamp housing (D) tabs. Reconnect electrical connector.
5. Install trim ring onto main lamp housing and mounting ring while aligning lug on glass lens assembly with lug notch on mounting ring. Assemble trim ring mounting screw and tighten securely.

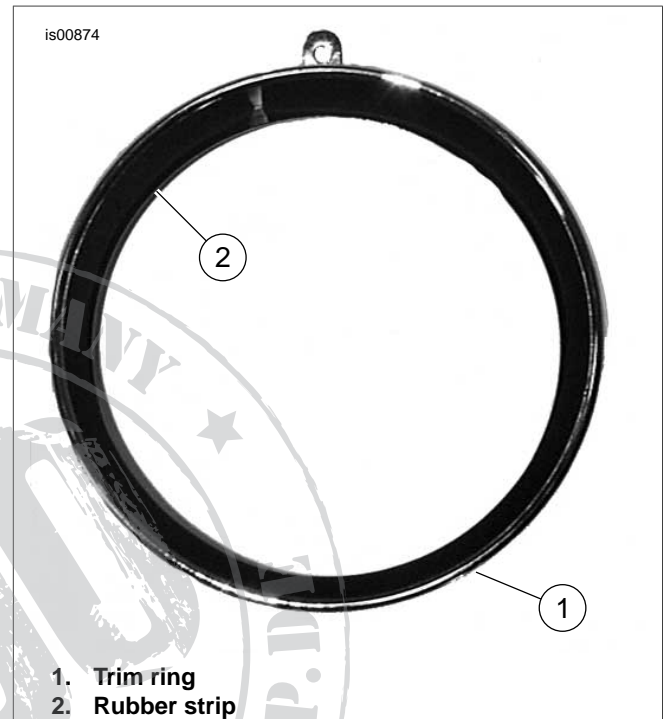

Figure 1. Trim Ring with Gasket

### WARNING

**Be sure that all lights and switches operate properly before operating motorcycle. Low visibility of rider can result in death or serious injury. (00316a)**

6. For safety, check headlamp operation to confirm that electrical connector was reconnected properly. Check the "on", "high beam", "low beam" and "off" functions.

# SERVICE PARTS

is00876a

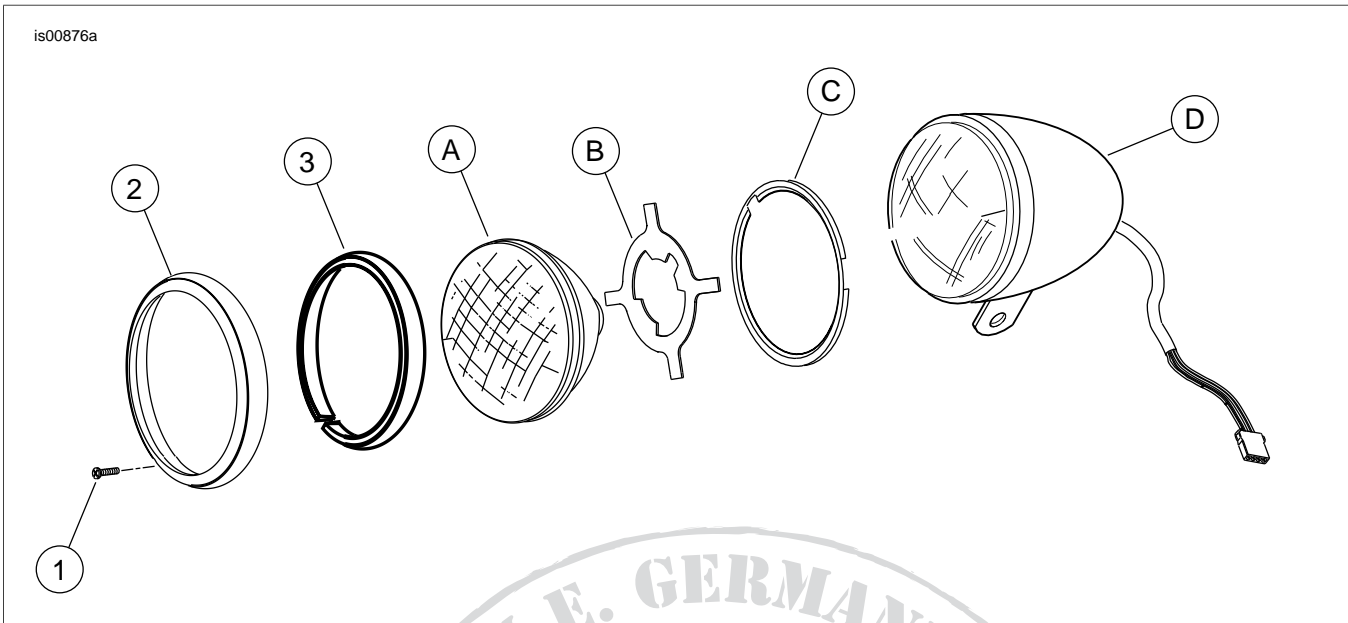

Figure 2. Service Parts: Headlamp Trim Ring

Table 1. Service Parts Table: Headlamp Trim Ring

Item	Description (Quantity)	Part Number
1	Original equipment screw	Not sold
2	Trim ring	Not sold
3	Rubber strip (1.25 in. x .39 inch)	69680-00
<b>Items mentioned in text, but not included in kit:</b>		
A	Glass lens assembly	
B	Gasket	
C	Mounting ring	
D	Main lamp housing	