



INSTRUCTIONS

-J04184

REV. 2006-05-21

V-ROD CHROME REAR TURN SIGNAL

GENERAL

Kit Number

69374-05A

Models

This kit fits 2002 and later domestic VRSCA, VRSCB, VRSCD, and VRSCX models.

Additional Parts Required

WARNING

The rider's safety depends upon the correct installation of this kit. Use the appropriate service manual procedures. If the procedure is not within your capabilities or you do not have the correct tools, have a Harley-Davidson dealer perform the installation. Improper installation of this kit could result in death or serious injury. (00333a)

NOTE

This instruction sheet references Service Manual information. A Service Manual for your model motorcycle is required for this installation and is available from a Harley-Davidson Dealer.

Kit Contents

See Figure 9 and Table 2.

INSTALLATION

Prepare the Motorcycle

1. Remove the right cover and the maxi-fuse.
2. Follow Service Manual instructions to remove the air box cover.

Remove the Existing Rear Turn Signals

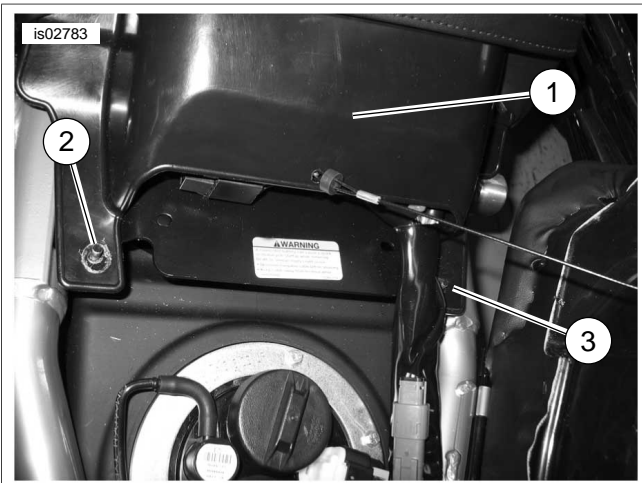
1. **For 2006 and Earlier Models:** See Figure 1. Insert a screwdriver into middle of hole of license plate light cover. Push forward to release tail lamp housing retaining clip.
2. See Figure 3. Identify the white left [19] (1) and black right [18] (2) 2 pin rear turn signal connectors.
3. See Figure 6. To separate the rear turn signal connector, press the button (1) and separate the pin terminal housing from the socket terminal housing.
4. On the socket terminal housing, press the latch (2) aside and open the secondary lock (3).
5. To remove the rear turn signal wires from the socket terminal housing, insert a pin (6) into the front socket cavity. Compress the tang (4) while gently pulling the wire and socket terminal (5) from the back.
6. See Figure 7. Inside the fender, remove the fasteners (1) and the turn signal support plate (2). Pull the turn signal

wiring through holes in license plate mounting bracket and remove turn signals.

7. Repeat for the opposite turn signal.
1. **For 2007 and Later Models:** See Figure 2. Open seat and remove the nut and washer (3), seat post (2), passenger pillion and passenger seat (1) per the instructions in the Service Manual.
2. See Figure 4. Identify the left (1) and right (2) rear turn signal wires and 6 pin rear turn signal connector [94].
3. See Figure 6. To separate the rear turn signal connector, press the button (1) and separate the pin terminal housing from the socket terminal housing.
4. On the socket terminal housing, press the latch (2) aside and open the secondary lock (3).
5. See Figure 5. Remove the turn signal wires from the 6 pin socket terminal housing. To remove the wires, insert a pin (6) into the front socket cavity. Compress the tang (4) while gently pulling the wire and socket terminal (5) from the back. Repeat for all four turn signal wires. Do not remove the license light wires from the socket terminal housing.
6. Gently pull the loose turn signal wires through the sheath toward the rear of the vehicle until completely removed from the sheath.
7. See Figure 7. Inside the fender, remove the fasteners (1) and the turn signal support plate (2). Pull the turn signal wiring through holes in license plate mounting bracket and remove turn signals.
8. Repeat for the opposite turn signal.

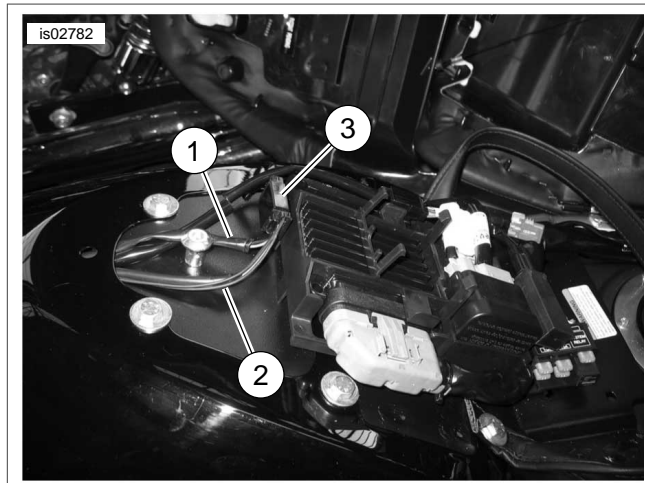


Figure 1. Release Tail Lamp Housing



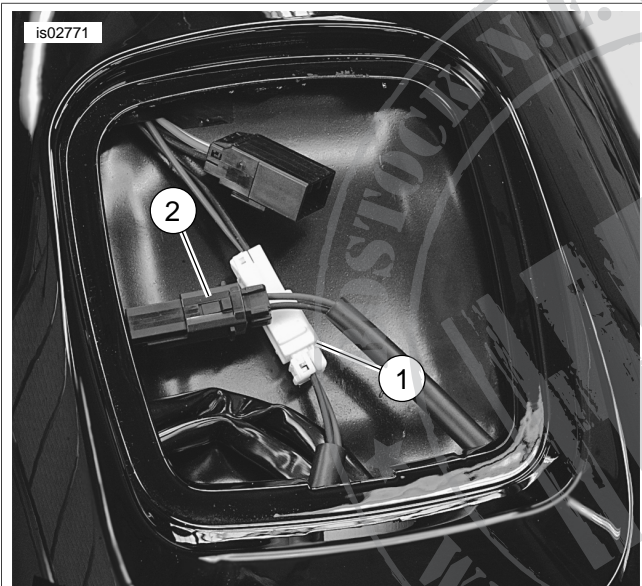
1. Passenger pillion
2. Seat post
3. Nut and washer

Figure 2. Rear Turn Signal Connector Access



1. Left turn signal wires
2. Right turn signal wires
3. Rear turn signal connector [94]

Figure 4. 2007 and Later Models



1. Left turn signal connector [19] (white)
2. Right turn signal connector [18] (black)

Figure 3. Rear Turn Signal Connectors

Install Chrome Rear Turn Signals

1. See Figure 9. Measure the wire lengths of the OE (Original Equipment) turn signals. Cut the wire lengths on the **new** chrome turn signals (1) to match the length of the wires on the OE turn signals.
2. See Figure 8. Assemble a chrome turn signal assembly (1) to a chrome lamp support (2) by feeding the wire leads through the wire hole in the lamp support.
3. Feed the wire leads and conduit through the front hole in the license plate bracket and through hole in the support plate (4) towards the front of the vehicle.
4. Thread the bolt (3) through the center hole in the support plate, through the center hole in the license plate bracket, and through the hole in the chrome lamp support into the chrome turn signal.
5. Tighten the bolt to 11.3-16.9 Nm (100-150 **in-lbs**).
6. **For 2006 and Earlier Models:** Route the turn signal wires between the license plate bracket and the inner fender. Access the wires through the tail lamp opening in the outer fender.
7. Crimp socket terminals (4) to the ends of the turn signal wires. Refer to Service manual for crimping instructions.
8. Refer to Table 1. Identify the left and right connector socket housings and match the socket terminated colored leads to the cavities in the socket housing which mate to the colored leads in the pin housing.
9. Install terminated wires to appropriate cavities in socket connectors. Close secondary lock to engage side latches in connectors.
10. Arrange all electrical connectors and wiring harnesses (between inner and outer fender) to either side of tail lamp opening in outer fender and away from tail lamp bulb housing.

11. Install tail lamp assembly.
 - a. Insert tabs of front of housing under forward edge of fender opening.
 - b. Carefully push tail lamp assembly toward front.
 - c. Engage retaining clip with rear edge of fender. Gently press down on assembly until clip locks in place.

NOTE

Retaining clip must engage rear fender opening for tail lamp to remain locked into position in rear fender.

12. **For 2007 and Later Models:** Combine the wires from the rear turn signals together and wrap with electrical tape. Use fish tape to pull turn signal wires through sheathing towards front of vehicle and up to 6 pin turn signal connector.
13. Crimp the socket terminals onto the turn signal wires. Refer to your Service Manual for Crimping Instructions.
14. See Figure 5. Identify left and right turn signal wires and install terminated wires in appropriate cavity in 6 pin socket connector. Close secondary lock to engage side latches.
15. Connect the pin terminal housing to the socket terminal housing.

Table 1. 2006 and Earlier Models

Connector	Cavity Number 1	Cavity Number 2
Left (white) [94]	V to V	BK to BK
Right (black) [94]	V to BN	BK to BK

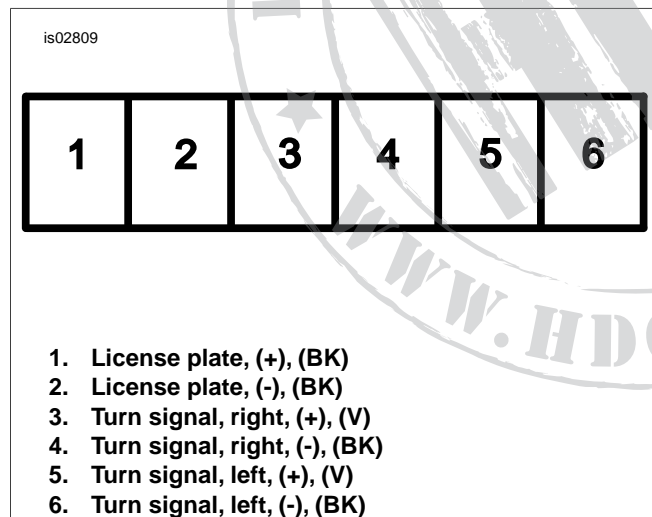


Figure 5. Turn Signal Pin Connector Locations

16. See Figure 2. Reinstall connector, passenger pillion (1), seat stud (2), nut and washer (3) and seat per instructions in the Service Manual.

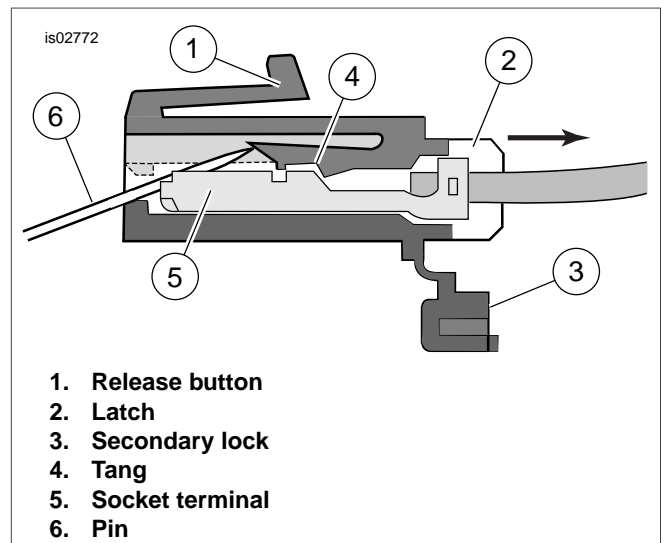


Figure 6. Turn Signal Connector Cross Section

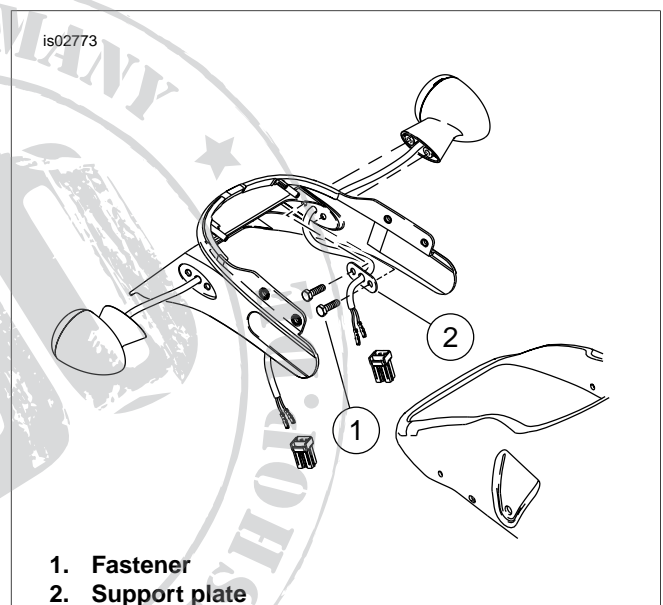
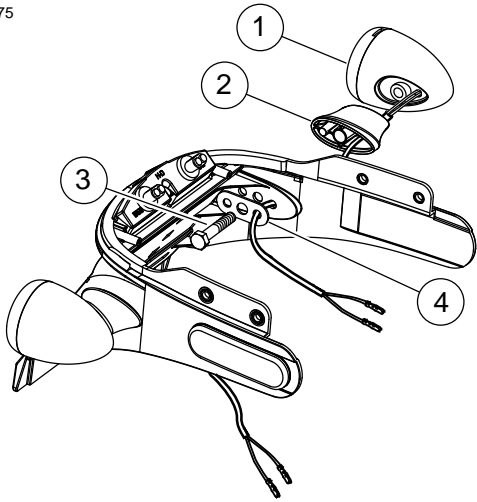


Figure 7. Turn Signal Mounting

is02775



- 1. Turn signal
- 2. Lamp support
- 3. Bolt
- 4. Support plate

Figure 8. Turn Signal to Support

Return the Motorcycle to Service

1. Install the maxi-fuse and right side cover.

WARNING

Be sure that all lights and switches operate properly before operating motorcycle. Low visibility of rider can result in death or serious injury. (00316a)

2. Turn IGN to ON and test rear lights.
 - a. Rear brake light
 - b. Rear tail lamp
 - c. Left and right turn signals

SERVICE PARTS

is02774

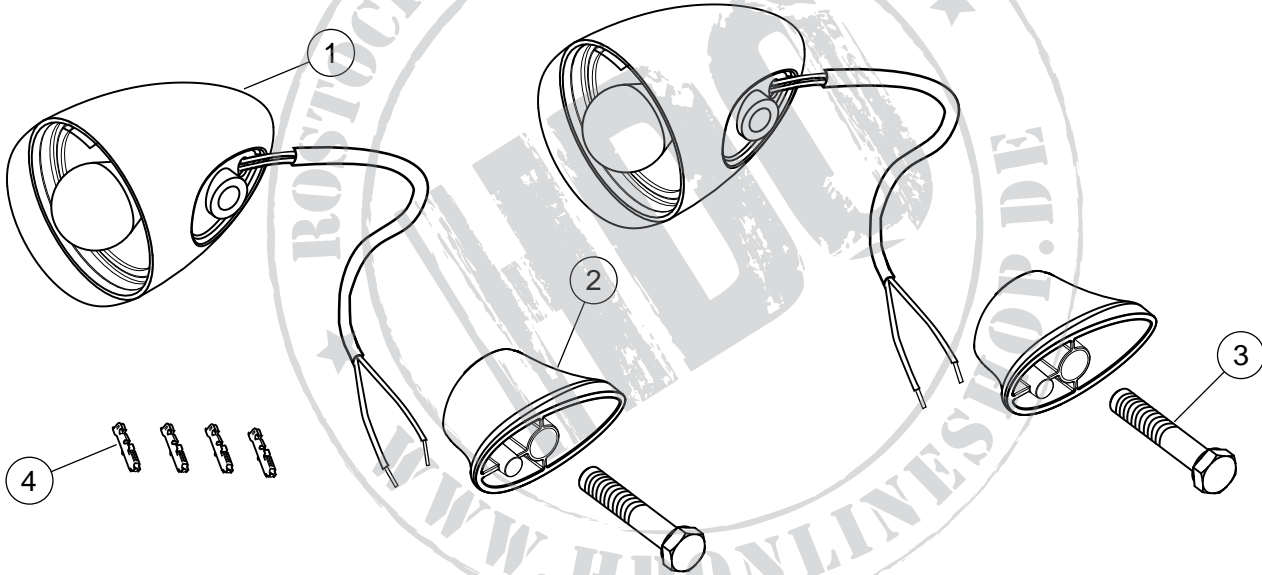


Figure 9. Service Parts: V-Rod Chrome Rear Turn Signals

Table 2. Service Parts Table

Item	Description (Quantity)	Part Number
1	Chrome turn signal assembly (2)	68977-00
2	Lamp support (2)	68829-05
3	Bolt (2)	2887WA
4	Socket terminals (4)	73191-96