



INSTRUCTIONS

-J05940

2014-05-15

LED BULLET FOG LAMP HARNESS

GENERAL

Kit Number

69200863

Models

For model fitment information, see the P&A retail catalog or the Parts and Accessories section of www.harley-davidson.com (English only).

Installation Requirements

Separate purchase of an Engine Guard Mounted LED Bullet Fog Lamp Kit and an LED Bullet Fog Lamp Mounting Kit are required for proper installation of this kit.

Electrical Contact Lube (H-D Part No. 99861-02) or equivalent is required after battery cable disconnection.

These items are available from a Harley-Davidson dealer.

An Ultratorch UT-100 (Part No. HD-39969), Robinair Heat Gun (Part No. HD-25070) with Heatshrink Attachment (Part No. HD-41183), or other suitable radiant heating device is required for the proper installation of this kit.

▲ WARNING

The rider's safety depends upon the correct installation of this kit. Use the appropriate service manual procedures. If the procedure is not within your capabilities or you do not have the correct tools, have a Harley-Davidson dealer perform the installation. Improper installation of this kit could result in death or serious injury. (00333a)

NOTE

This instruction sheet refers to service manual information. A service manual for this year/ model vehicle is required for this installation. One is available from a Harley-Davidson dealer.

Kit Contents

See Figure 3 and Table 1.

PREPARATION

▲ WARNING

To prevent accidental vehicle start-up, which could cause death or serious injury, remove main fuse before proceeding. (00251b)

▲ WARNING

To prevent accidental vehicle start-up, which could cause death or serious injury, disconnect negative (-) battery cable before proceeding. (00048a)

NOTE

- **2007- later vehicles WITH security siren:** With security fob present, turn ignition switch ON. See the service manual. After system is disarmed, turn ignition switch OFF. **IMMEDIATELY** remove the main fuse.
- **2006- earlier vehicles WITH security siren:** Disarm the siren with the key fob or security code. See the service manual to remove the main fuse or negative battery cable.
- **Vehicles WITHOUT security siren: Models with main fuse:** See the service manual. Remove main fuse. **Models with main circuit breaker:** See the service manual. Remove seat. Disconnect negative battery cable. Turn ignition switch OFF unless already done.

INSTALLATION

1. Install the fog lamps and mounting brackets to the vehicle per the instructions in **those** kits.

▲ WARNING

When routing wires and harnesses, ensure that they are clear of moving parts, heat sources and pinch points to avoid wire damage or a short circuit, which could cause loss of control resulting in death or serious injury. (00554b)

2. See Figure 1. Remove the lower screw (1) and washer from the clutch control clamp (3). Install the lamp switch and bracket assembly (2). Install the screw and washer. Tighten to 7–9 N·m (60–80 in-lbs).
3. Route the lamp switch wires down the handlebar to the steering head. Secure the wires to the handlebar with the wire harness retainers already on the vehicle. Snap the retainers into the holes in the handlebar. **Models without retainers:** Use cable straps from the kit to secure the wires to the handlebar.
4. Route the **black** switch wire with ring terminal rearward down the vehicle backbone to the area under the seat. Leave enough slack in the black wire to allow the handlebar to operate freely from full left to full right.
5. Install the ring terminal to the negative battery cable. Coil up any excess black wire with a cable strap if needed. Secure in a protected location.
6. Locate a wire providing **accessory** or **switched** power near the steering head. Cut **that** wire in an accessible location.
7. Cut the excess length from the **white** switch wire.



8. Get the sealed splice connector (5) from the kit. See Figure 2. Splice the white switch wire to the two accessory or switched power wires on the vehicle per the service manual appendix.

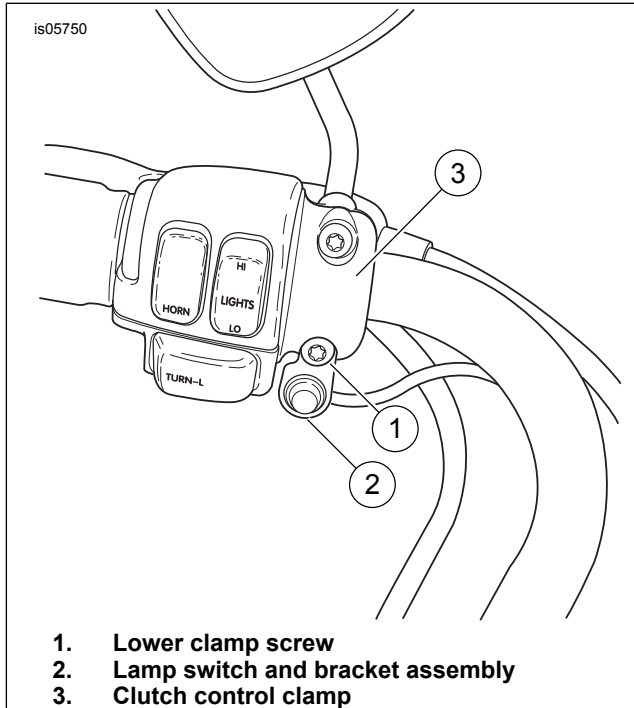

1. Lower clamp screw
2. Lamp switch and bracket assembly
3. Clutch control clamp

Figure 1. Install Lamp Switch On Clutch Control Clamp

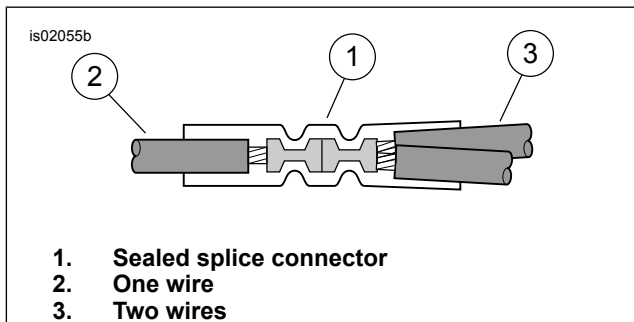

1. Sealed splice connector
2. One wire
3. Two wires

Figure 2. Splice Configuration (One Into Two)

9. Route the two harness legs and connectors (7): Plug the harness into the fog lamps.
 - a. downward to the base of the front downtube,
 - b. outward across the bottom of each side of the engine guard, and
 - c. upward to each fog lamp connector.
10. Coil up any excess wire. Use cable straps (9) to secure the harness legs to the engine guard.

COMPLETION

NOTE

Verify that the ignition is **OFF** before installing the main fuse or attaching the negative battery cable.

1. **Models with main fuse:** See the service manual. Install main fuse. **Models with main circuit breaker:**
 - a. **ALL models except XL:** See the service manual. Attach negative battery cable. Apply a light coat of petroleum jelly or corrosion retardant material to battery terminals.
 - b. **XL models only:** See the service manual. Connect negative battery cable at engine crankcase.

⚠ WARNING

After installing seat, pull upward on seat to be sure it is locked in position. While riding, a loose seat can shift causing loss of control, which could result in death or serious injury. (00070b)

2. **ALL models:** See the service manual. Install seat.

SERVICE PARTS

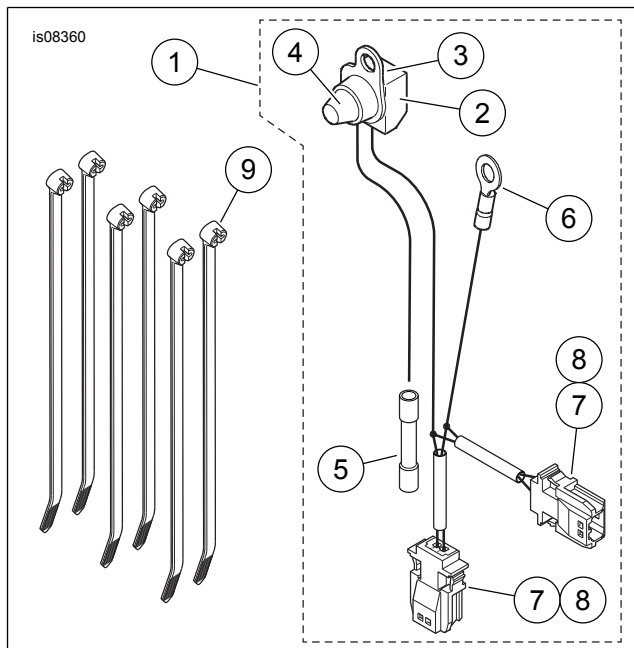

Figure 3. Service Parts, LED Bullet Fog Lamp Harness

Table 1. Service Parts

Item	Description (Quantity)	Part Number
1	Wire harness, LED bullet fog lamp (includes items 2-8)	69201110
2	• Switch, pushbutton	Not sold separately
3	• Mounting bracket, switch	Not sold separately
4	• Boot, switch	Not sold separately
5	• Sealed splice connector, #18-20AWG (red)	Not sold separately
6	• Ring terminal	Not sold separately
7	• Pin housing, two-way (2)	Not sold separately
8	• Pin terminal, #20-22 AWG (4)	Not sold separately
9	Cable strap (6)	10006