



# INSTRUCTIONS

-J05534

2011-12-14

## FLHT FRONT AUXILIARY LAMP INDEPENDENT CONTROL WIRE HARNESS

### GENERAL

#### Kit Number

69200441

#### Models

For model fitment information, see the P&A retail catalog or the Parts and Accessories section of [www.harley-davidson.com](http://www.harley-davidson.com) (English only).

#### Installation Requirements

Electrical Contact Lube (H-D Part No. 99861-02) or equivalent is required after battery cable disconnection. This item is available from a Harley-Davidson dealer.

#### ⚠ WARNING

The rider's safety depends upon the correct installation of this kit. Use the appropriate service manual procedures. If the procedure is not within your capabilities or you do not have the correct tools, have a Harley-Davidson dealer perform the installation. Improper installation of this kit could result in death or serious injury. (00333a)

#### NOTE

This instruction sheet refers to service manual information. A service manual for this year/model motorcycle is required for this installation and is available from a Harley-Davidson dealer.

### ELECTRICAL OVERLOAD

#### NOTICE

It is possible to overload your vehicle's charging system by adding too many electrical accessories. If the combined electrical accessories operating at any one time consume more electrical current than the vehicle's charging system can produce, the electrical consumption can discharge the battery and cause damage to the vehicle's electrical system. See an authorized Harley-Davidson dealer for advice about the amount of current consumed by additional electrical accessories or for necessary wiring changes. (00211c)

#### ⚠ WARNING

When installing any electrical accessory, be certain not to exceed the maximum amperage rating of the fuse or circuit breaker protecting the affected circuit being modified. Exceeding the maximum amperage can lead to electrical failures, which could result in death or serious injury. (00310a)

The front auxiliary lamps require up to **4.56 amps** additional current from the electrical system when illuminated.

### Kit Contents

This kit consists of a new wire harness and these instructions. There are no service parts available for this kit.

### PREPARATION

#### NOTE

*For vehicles equipped with security siren:*

- **2007 and later:** Verify that the Hands-Free Fob is present. Turn the ignition key switch to IGNITION.
- **2006 and earlier:** Disarm the siren with the key fob.

### For Vehicles With Main Fuse:

#### ⚠ WARNING

To prevent accidental vehicle start-up, which could cause death or serious injury, remove main fuse before proceeding. (00251b)

1. See the service manual and remove the main fuse.

### For Vehicles With Main Circuit Breaker:

#### ⚠ WARNING

To prevent accidental vehicle start-up, which could cause death or serious injury, disconnect negative (-) battery cable before proceeding. (00048a)

1. See the service manual to remove the seat and disconnect the negative (black) battery cable from the negative (-) battery terminal. Retain all seat mounting hardware.
2. **For ALL models:** Turn the ignition key switch OFF if not already done.

### INSTALLATION

1. Remove the outer fairing per the service manual.
2. See Figure 1. Unplug the twelve-way fairing cap switch connector [105], located on the inner fairing support alongside the right (brake-lever side) fairing support bracket.
3. Plug the auxiliary lamp independent control wire harness into the inner fairing cap harness socket housing [105B] and the interconnect harness pin housing [105A].



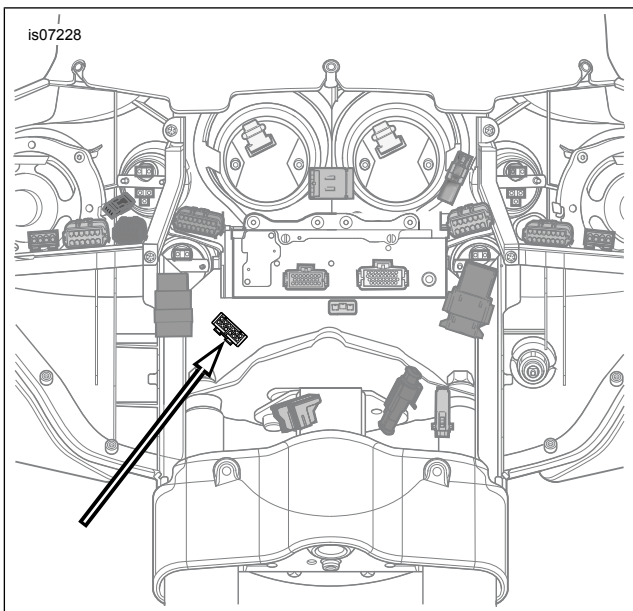

**Figure 1. Fairing Cap Switch Connector [105]**

4. Partially install the outer fairing per the service manual by starting the three screws with flat washers just below the windshield.
5. **Models with main fuse:** See the service manual and install the main fuse. **Models with main circuit breaker:** See the service manual and attach the negative battery cable. Apply a light coat of Harley-Davidson electrical contact lubricant (Part No. 99861-02), petroleum jelly or corrosion retardant material to the negative battery terminal
6. Test the operation of the auxiliary lamps.
  - Turn the ignition key switch to IGNITION, but do not start the motorcycle. The low beam headlamp should turn ON.
  - Operate the auxiliary lamp switch on the fairing cap ON and OFF. The auxiliary lamps should turn ON and OFF with switch operation.
  - Toggle the headlamp dimmer switch on the left handlebar control to HI to activate the high beam. Operate the auxiliary lamp switch on the fairing cap ON and OFF. The auxiliary lamps should turn ON and OFF with switch operation.
  - Turn the ignition key switch to ACCESSORY. The headlamp should turn OFF. Operate the auxiliary lamp switch on the fairing cap ON and OFF. The auxiliary lamps should turn ON and OFF with switch operation.
  - Turn the ignition key switch to OFF. Operate the auxiliary lamp switch on the fairing cap ON and OFF. The auxiliary lamps should not illuminate.
7. Complete the outer fairing installation per the service manual.

**⚠ WARNING**

**After installing seat, pull upward on seat to be sure it is locked in position. While riding, a loose seat can shift causing loss of control, which could result in death or serious injury. (00070b)**

8. **Models with main circuit breaker:** See the service manual, and install the seat. **Models with main fuse:** Install the side cover.