



INSTRUCTIONS

-J04337

2013-12-15

HORN KIT

GENERAL

Kit Number

69060-90H

Models

This kit fits all 1991 and later model motorcycles that have a "snail" style horn (see Figure 1). It will not fit models equipped with a "pancake" style horn.

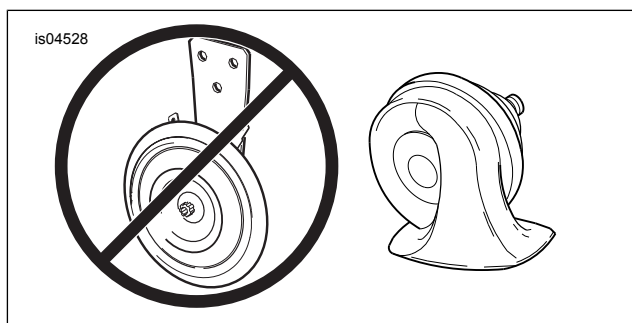

Figure 1. "Pancake" and "Snail" Style Horns

Additional Parts Required

On 1995 and earlier Dyna models, Loctite® 271 Threadlocker and Sealant - Red (H-D Part No. 99671-97) is required for the proper installation of this kit.

Kit Contents

See Figure 2 and Table 1.

INSTALLATION

▲ WARNING

To prevent accidental vehicle start-up, which could cause death or serious injury, disconnect battery cables (negative (-) cable first) before proceeding. (00307a)

▲ WARNING

Disconnect negative (-) battery cable first. If positive (+) cable should contact ground with negative (-) cable connected, the resulting sparks can cause a battery explosion, which could result in death or serious injury. (00049a)

NOTE

For 2004 and later XL (Sportster®) models, the negative battery cable is most easily disconnected at the engine crankcase.

1. Refer to the owner's manual and follow the instructions given to remove the seat and disconnect the battery cables, negative cable first. Retain all seat mounting hardware.

NOTE

Take note of the orientation and sequence of original equipment (OE) horn mounting components to aid in assembly.

2. Remove the elbow terminals from the two spade contacts on the horn.

NOTE

For further information on the 1991 through 1993 Dyna model horn installation, have a Harley-Davidson dealer refer to Tech Tip #35.

3. See Figure 2. Remove the currently installed horn (1), nut (A), and all the other horn mounting hardware from the horn mounting bracket (D or 4). Discard the horn, but retain the nut and all other horn mounting hardware.
4. **For 2002-2007 VRSC models:** Remove and discard the original horn mounting bracket, and install the **new** horn mounting bracket (4) from the kit. Install new horn with the O.E. flange nut (A) saved earlier. **For 1994 and 1995 Dyna models, and 1991 through 1993 Dyna models fitted with a 1994-style battery tray:** Insert the mounting stud of the **new** horn through the O.E. spacer (C) and grommet (B) in the horn mounting bracket with any hardware saved earlier. Obtain the spacer nut (3) from the kit. Apply a few drops of Loctite 271 - Red to the nut threads, and install the nut onto the horn mounting stud, and tighten to 11–13 N·m (100–120 in-lbs). Over-tightening or under-tightening the horn spacer nut may affect the sound quality of the horn. **For all models except VRSC:** Insert the mounting stud of the **new** horn (1) through the new kit washer (5). Obtain the O.E. horn cover (E), and assemble **new** horn (1) with washer (5) to horn cover (E) using O.E. flange nut (A).

If necessary, use the **new** copper step washer (2) from the kit.

NOTE

The step washer included in the kit is only needed when the horn bracket mounting hole is much larger than the horn mounting stud. Use the step washer to center the horn stud in the horn bracket mounting hole.

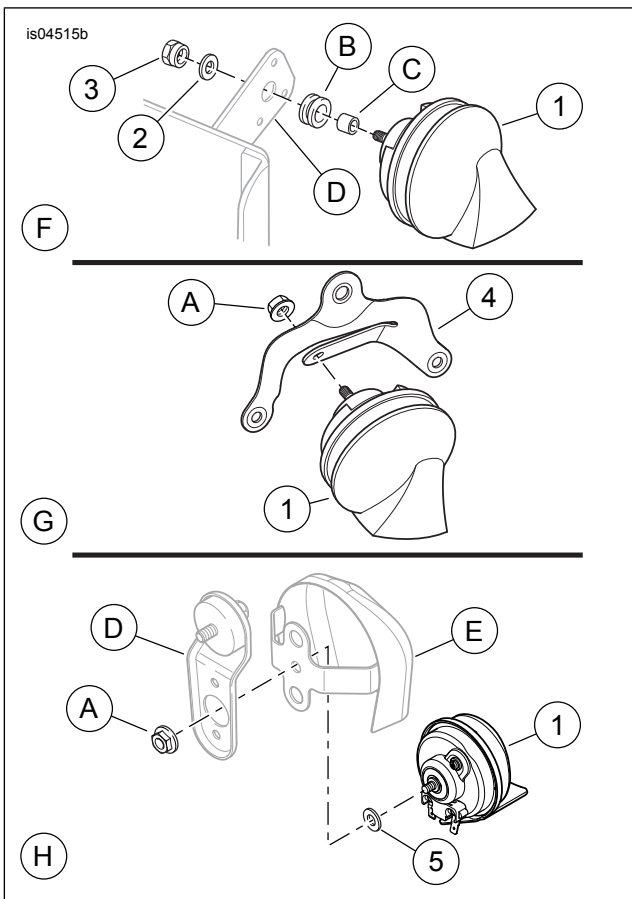

Figure 2. Horn Installation

Table 1. Horn Kit

Item	Description (Quantity)	Part Number
1	Horn	Not sold separately
2	Step washer (copper)	Not sold separately
3	Nut, spacer	Not sold separately
4	Bracket, horn mounting (VRSC)	69152-01A
5	Washer	10300085
Items mentioned in text, but not included in kit.		
A	Original equipment (O.E.) flanged nut	
B	O.E. grommet	
C	O.E. spacer	
D	O.E. horn mounting bracket	
E	O.E. horn cover	
F	Horn mounting, 1995 and earlier Dyna models	
G	Horn mounting, 2002 and later VRSC models	
H	Horn mounting, all other models	

NOTE

The horn is not polarity sensitive. The elbow terminals may be connected to either spade contact

5. Connect the horn ground and power wire elbow terminals from the vehicle harness to the two spade contacts on the horn.

⚠ WARNING

Connect positive (+) battery cable first. If positive (+) cable should contact ground with negative (-) cable connected, the resulting sparks can cause a battery explosion, which could result in death or serious injury. (00068a)

6. Verify that the ignition key switch is turned to the OFF position. Apply a light coat of Harley-Davidson electrical contact lubricant (H-D Part No. 99861-02), petroleum jelly or corrosion retardant material to the battery terminals. Refer to the owner's manual and follow the instructions given to attach the battery cables (positive cable first).
7. Turn the ignition key switch to ON/IGNITION, but do not start the motorcycle. Test for proper horn operation.
8. Refer to the owner's manual, and follow instructions to install the seat.

⚠ WARNING

After installing seat, pull upward on seat to be sure it is locked in position. While riding, a loose seat can shift causing loss of control, which could result in death or serious injury. (00070b)