



INSTRUCTIONS

-J04471

REV. 2007-06-14

HORN COVER KIT

GENERAL

Kit Number

69012-YYxxx

Models

For model fitment information, please see the P&A Retail Catalog or the Parts and Accessories section of www.harley-davidson.com (English only).

Additional Parts Required

Loctite® 271 (Red) Threadlocker and Sealant (H-D Part Number 99671-97) is required for the proper installation of this kit.

Some models will require separate purchase of a Horn Installation Kit (Part Number 69114-08). See Step 4 for details.

Kit Contents

This Kit consists of a horn cover and these instructions.

INSTALLATION

NOTE

Test the horn only when mounted on the vehicle. The sound may be muffled if tested when hand-held.

1. Refer to the Owner's Manual and follow the instructions given to remove the Maxi® Fuse (if so equipped) or disconnect the battery cables, negative cable first.
2. See Figure 1. Remove the acorn nut (1) and washer (2) to free the horn, cover and bracket assembly (3) from the rubber mounting stud (4). The rubber stud and large flat washer (5) remain installed to the vehicle.
3. Disconnect the elbow terminals from the two spade contacts on the horn. Release the main harness conduit from the J-clamp (10) (if present).

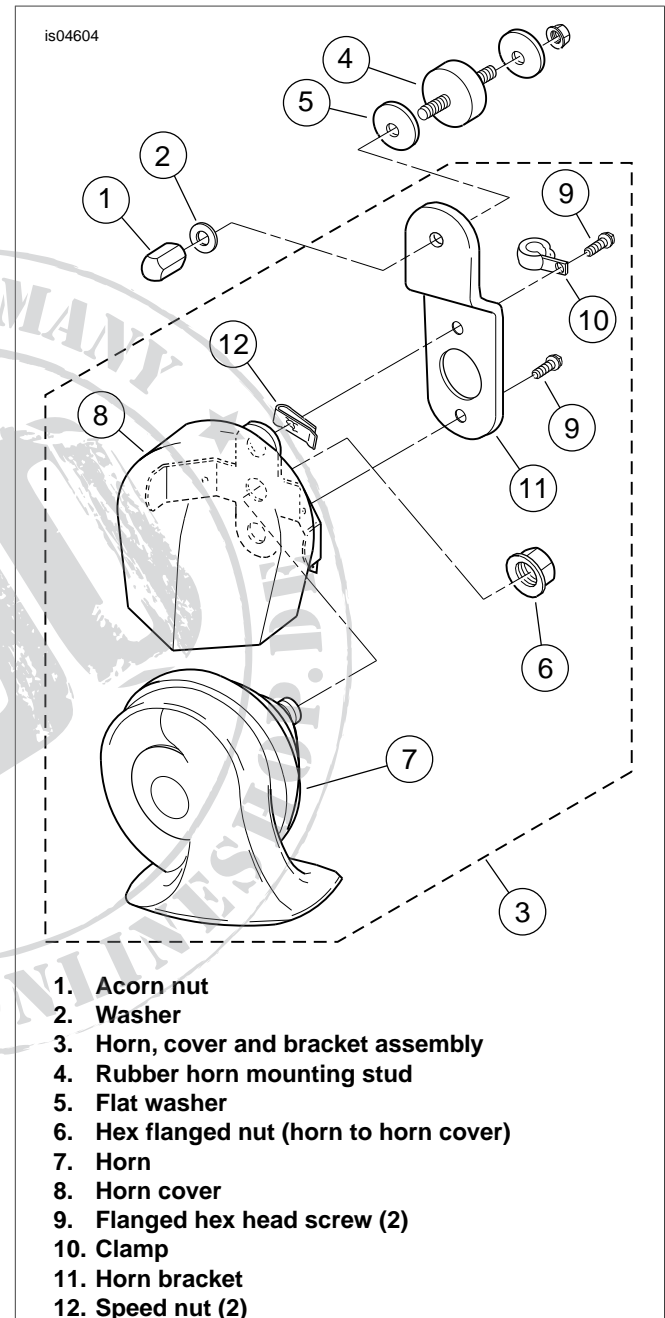

Figure 1. Original Horn Cover Removal

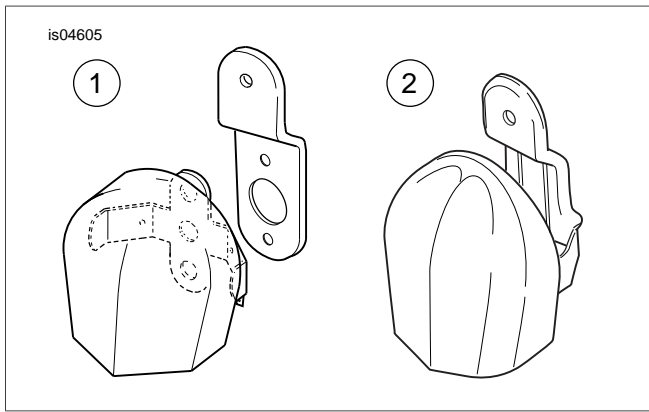

Figure 2. Horn Cover Types

4. Use a 10 mm wrench to remove the flanged hex nut (6) from the horn (7) mounting stud. Remove the horn from the original equipment (O.E.) horn cover (8).

Upon disassembly, inspect the O.E. horn cover.

If the cover appears as shown in Figure 2, Item 1,

- a. note the location and orientation of the speed nuts (and clamp, if so equipped) attached to the cover.
- b. See Figure 1. Remove and retain the two flanged hex head screws (9) and clamp (10, if so equipped) from the horn bracket (11).
- c. Remove and retain the two speed nuts (12) pressed onto the ears of the horn cover bracket.
- d. Obtain the **new** horn cover from the kit, and the two speed nuts removed in Step 4c. Install the speed nuts onto the ears of the horn cover bracket.

If the cover appears as shown in Figure 2, Item 2,

- a. Obtain the **new** horn cover from **this** kit, and the Horn Cover Installation Kit (sold separately).
- b. See Figure 1. Install the two speed nuts (12) from the Installation Kit onto the ears of the **new** horn cover in the orientation shown.

NOTES

The Horn Cover Installation Kit consists of Items 1, 2, 6, 9, 10, 11 and 12 as shown in Figure 1. References to these items in the following instructions refer to those removed from the original horn assembly or from the Horn Cover Installation Kit, as appropriate.

Do not over-tighten the horn to horn cover flange nut (6). Over-tightening may result in permanent damage to the horn, resulting in reduced volume and tone quality.

5. Apply Loctite 271 (Red) to the threads of the flange nut (6). Fasten the horn (7) to the horn cover (8) with the nut, and tighten the nut to 80-100 **in-lbs** (9.0-11.3 Nm).
6. Obtain the two flanged hex head screws (9) and the clamp (10).
Fasten the horn cover to the horn bracket (11). Tighten the screws to 35-55 **in-lbs** (4.0-6.2 Nm).
7. Route the main harness conduit through the clamp (10, if present), and install the entire horn and cover assembly to the rubber mounting stud (4).
8. Obtain the acorn nut (1) and washer (2). Fasten the horn bracket (11) to the rubber mounting stud. Tighten the acorn nut to 80-100 **in-lbs** (9.0-11.3 Nm).

NOTE

The horn is not polarity sensitive. The ground and power wires may be connected to either terminal.

9. Connect the horn wire terminal clips from the main wire harness to the spade connections on the horn.

WARNING

Connect positive (+) battery cable first. If positive (+) cable should contact ground with negative (-) cable connected, the resulting sparks can cause a battery explosion, which could result in death or serious injury. (00068a)

10. Refer to the Owner's Manual and follow the instructions given to re-install the Maxi® Fuse (if so equipped) or re-connect the battery cables, positive cable first.

NOTE

Test the horn only when mounted on the vehicle. The sound may be muffled if tested when hand-held. A muffled sounding horn that is mounted to a vehicle may indicate permanent damage to the horn caused by over-tightening the horn to horn cover nut (see Figure 1, Item 6). Try adjusting the nut torque to resolve the sound quality. Replace the horn if necessary.

11. Test the operation of the horn.
12. Re-install the seat, if removed.

WARNING

After installing seat, pull upward on seat to be sure it is locked in position. While riding, a loose seat can shift causing loss of control, which could result in death or serious injury. (00070b)