



# INSTRUCTIONS

-J04543

REV. 2008-03-31

## AUXILIARY BRAKE/ RUN/TURN SIGNAL CONVERSION KIT

### GENERAL

#### Kit Number

68468-09

#### Models

For model fitment information, see the P&A Retail Catalog or the Parts and Accessories section of [www.harley-davidson.com](http://www.harley-davidson.com) (English only).

#### WARNING

The rider's safety depends upon the correct installation of this kit. Use the appropriate service manual procedures. If the procedure is not within your capabilities or you do not have the correct tools, have a Harley-Davidson dealer perform the installation. Improper installation of this kit could result in death or serious injury. (00333a)

#### NOTE

This instruction sheet references service manual information. A service manual for your model motorcycle is required for this installation and is available from a Harley-Davidson Dealer.

#### Kit Contents

See Figure 6 and Table 1.

#### WARNING

When installing any electrical accessory, be certain not to exceed the maximum amperage rating of the fuse or circuit breaker protecting the affected circuit being modified. Exceeding the maximum amperage can lead to electrical failures, which could result in death or serious injury. (00310a)

#### NOTE

Red turn signal lenses may not be legal in all states. Check your local regulations.

#### NOTE

This kit requires up to 4.5 amps additional current from the brake light circuit while brakes are applied.

### INSTALLATION

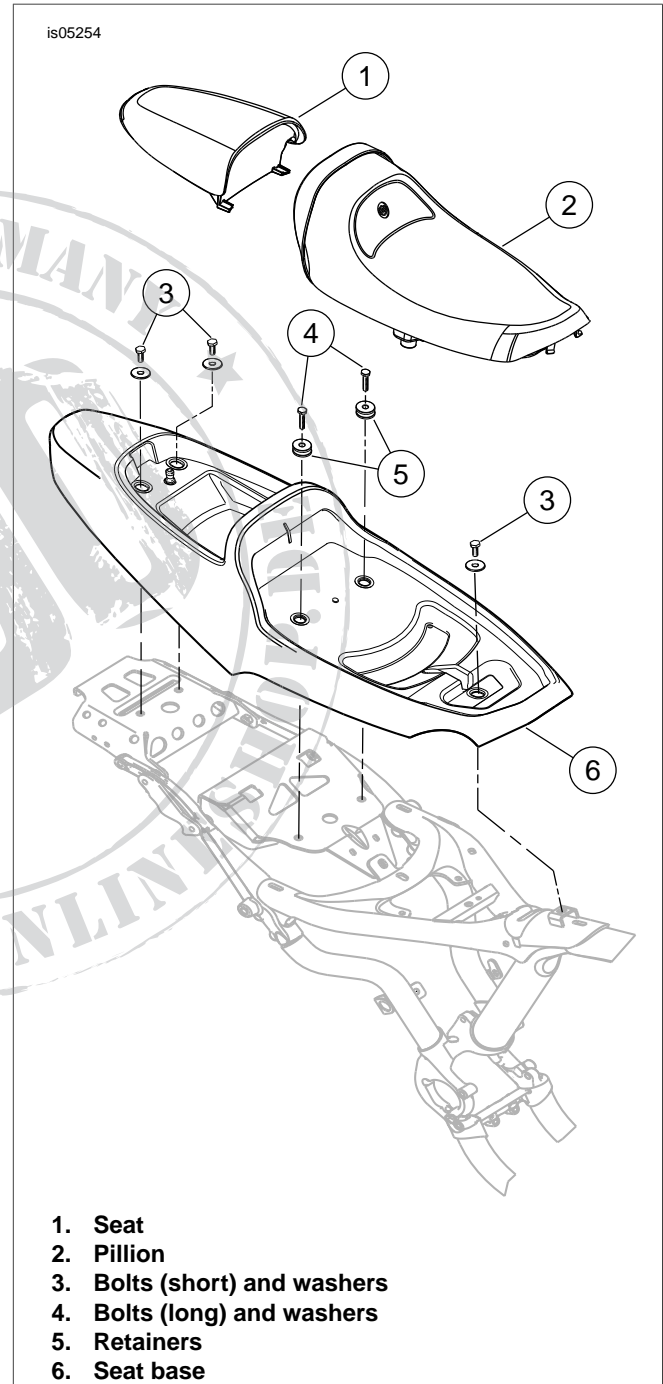

Figure 1. Remove Seat, Pillion and Seat Base

1. See Figure 1. Remove rider's seat (2) and passenger pillion (1).

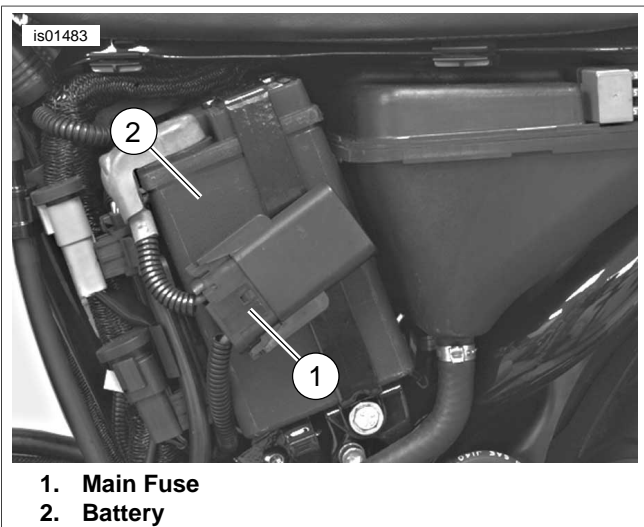

Figure 2. Disconnect Main Fuse

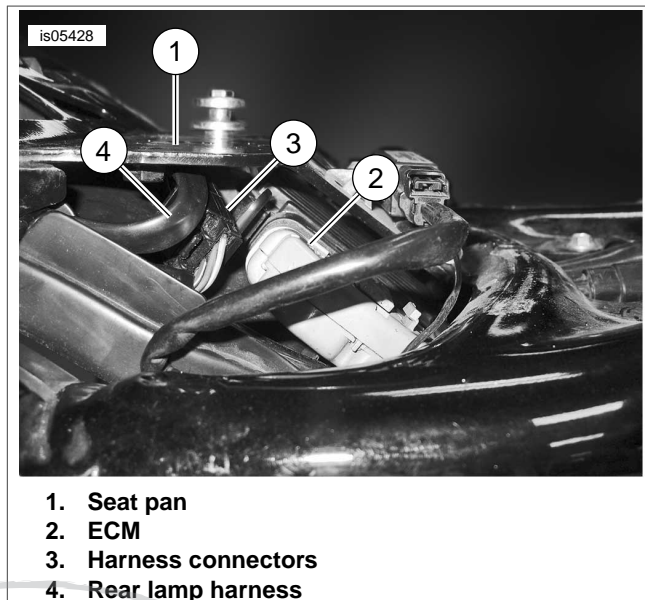

Figure 4. Rear Lamp Module Location

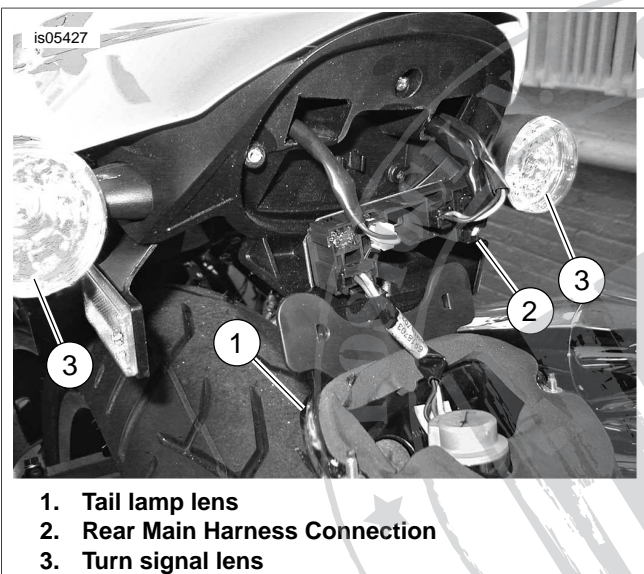

Figure 3. Rear Main Harness Connection

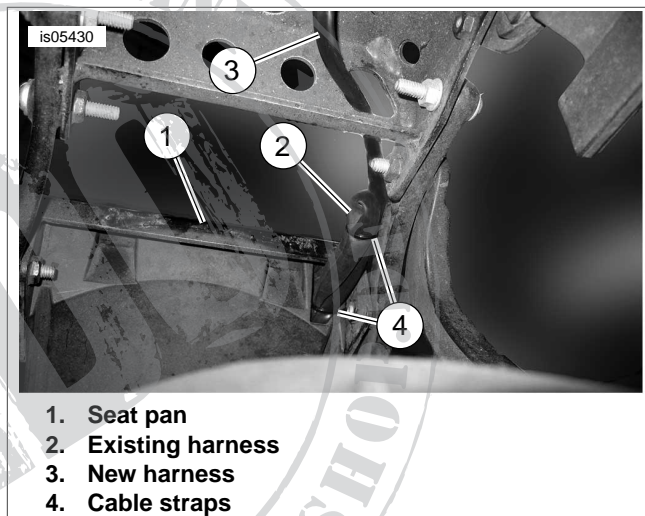

Figure 5. Securing Wire Harness

2. Remove short screws and washers (3) and long screws (4) and retainers (5) and lift seat base (6) from frame.
3. On the left side of the motorcycle, remove the side cover.
4. See Figure 2. Locate and disconnect the main fuse (1).
5. See Figure 3. Replace amber lenses the on rear turn signals with the red lenses (3) from the kit.
6. Remove two screws to disconnect tail light lens (1) from tail light housing.
7. Disconnect the existing rear main harness male connector (2) from tail light base assembly connector.
8. Pull back the rear main harness connector into the seat pan area. Do not pull back all of the wiring harness. It will be folded and strapped to the right side of the frame with the new harness.
9. Route the new harness six-pin connector along the same path as the existing harness back to the tail light base assembly. Plug in the connector to the six-pin receptacle.

10. Plug the existing harness connector into the pig-tail connector of the new harness.
11. See Figure 4. Tuck the new harness module and connector under the seat pan behind the electronic control module (ECM) and secure to frame with cable straps.
12. See Figure 5. Use cable ties to secure the wiring harnesses to the motorcycle.
13. Install main fuse and side cover.
14. Install seat base to frame.
15. Install rider's seat and passenger pillion.

### **WARNING**

**Be sure that all lights and switches operate properly before operating motorcycle. Low visibility of rider can result in death or serious injury. (00316a)**

16. Start the motorcycle and make sure that both left and right turn signals function properly and that both rear turn signal

lights work along with the original stop light when the brakes are applied.

## SERVICE PARTS

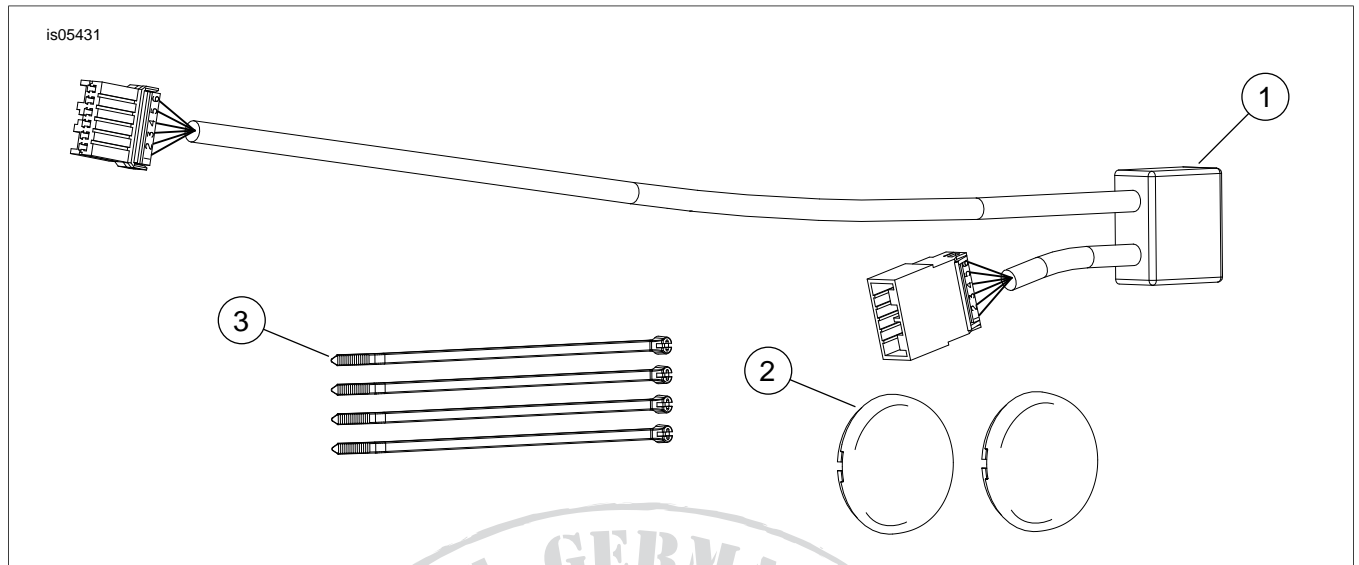

Figure 6. Service Parts: Conversion Module for Brake, Run and Turn Signal Lights

Table 1. Service Parts Table

Item	Description (Quantity)	Part Number
1	Conversion module for tail, run and turn signal lights	68469-09
2	Red lens (2)	69192-04
3	Cable strap (4)	10006