



INSTRUCTIONS

-J05290

REV. 2010-11-08

CURVED LICENSE PLATE MOUNTING KIT

GENERAL

Kit Numbers

67900007, 67900057

Models

For model fitment information, see the P&A Retail Catalog or the Parts and Accessories section of www.harley-davidson.com (English only).

WARNING

The rider's safety depends upon the correct installation of this kit. If the procedure is not within your capabilities or you do not have the correct tools, have a Harley-Davidson dealer perform the installation. Improper installation of this kit could result in death or serious injury. (00308a)

Kit Contents

There are no Service Parts available with this kit.

Table 1. Kit Contents

| Quantity | Item | Part Number |
|----------|-------------------------------|---------------------|
| 1 | Reflector assembly | Not Sold Separately |
| 1 | License plate bracket, curved | Not Sold Separately |
| 1 | License plate cover, curved | Not Sold Separately |
| 1 | Foam strip | Not Sold Separately |
| 2 | Acorn nut, #10-24 | Not Sold Separately |
| 2 | Spring lockwasher, #10 | Not Sold Separately |
| 2 | Button head screw, #10-24 | Not Sold Separately |
| 1 | Socket head screw, 1/4-20 | Not Sold Separately |
| 5 | Acorn nut, 1/4 -20 | Not Sold Separately |
| 5 | Spring lockwasher, 1/4-20 | Not Sold Separately |
| 4 | Flat head screw, 1/4-20 | Not Sold Separately |
| 1 | Support bracket | Not Sold Separately |

LICENSE PLATE INSTALLATION

- Remove the tail lamp connector cover located inside the rear fender.
 - Remove and retain fastener.
 - Pull to release cover from clip.
- See Figure 1. Remove reflector (1). Remove license plate bracket fasteners (6).

- Remove bolt (2), washer (4) and nut (5) securing clamp to license plate bracket.
- See Figure 2. Remove the tail lamp assembly by removing the fasteners securing the lens.
- Remove the stock license plate support. Retain the fasteners and the tail lamp connector cover clip.
- See Figure 3. Install the new license plate support and the tail lamp connector cover clip using the stock fasteners. Tighten fasteners to 60-90 **in-lbs** (6.8-10.2 Nm)
- Install the tail lamp connector cover removed in step 1 using the stock fastener.
- See Figure 4. Secure the backplate to the tail lamp assembly using the #10-24 button head fasteners, #10 lockwasher and acorn nuts.

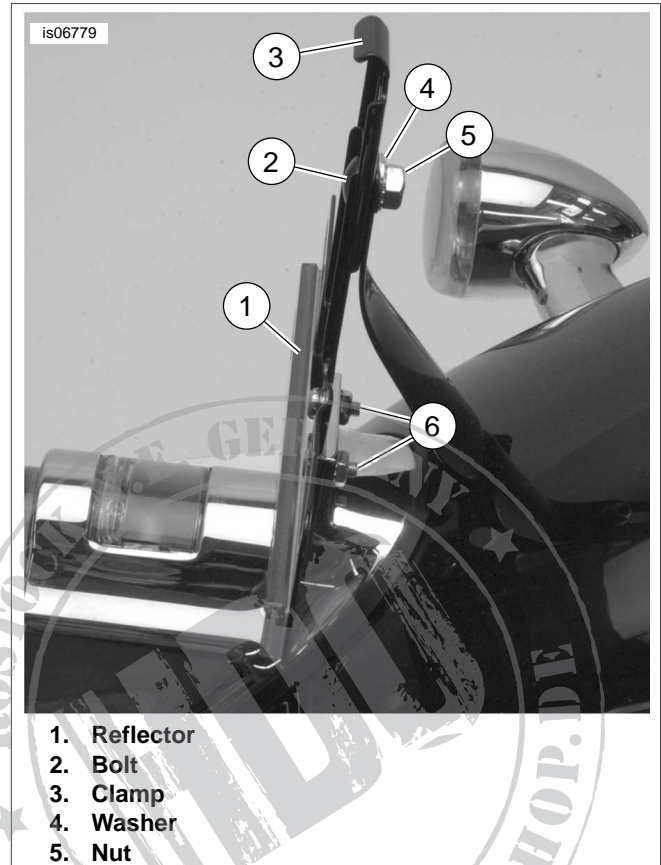

Figure 1. License Plate Bracket

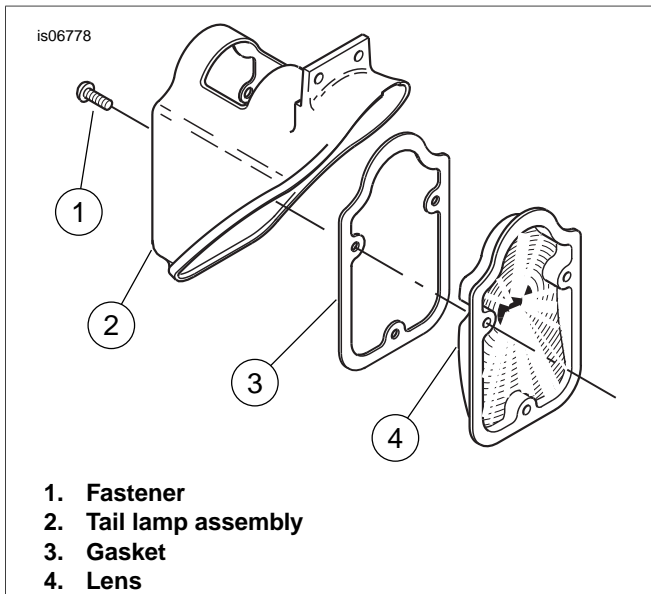

Figure 2. Tail Lamp

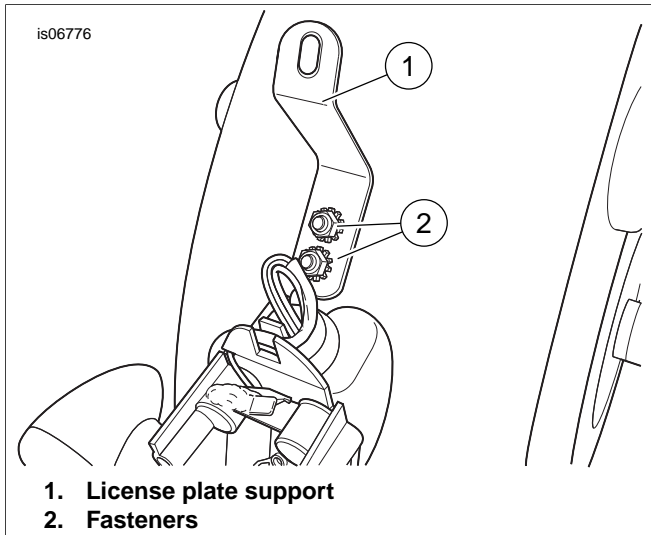

Figure 3. License Plate Support

9. Install the tail lamp/backplate assembly using the original fasteners.
10. Install the socket head fastener through the top hole in the backplate and into the license plate support. Secure with lockwasher and acorn nut.

NOTE

If movement or rattling of the license plate is observed, install the foam pad between the license plate and the backplate.

11. Place license plate on the backplate assembly. Place license plate frame over license and secure with remaining fasteners, lockwashers and acorn nuts.

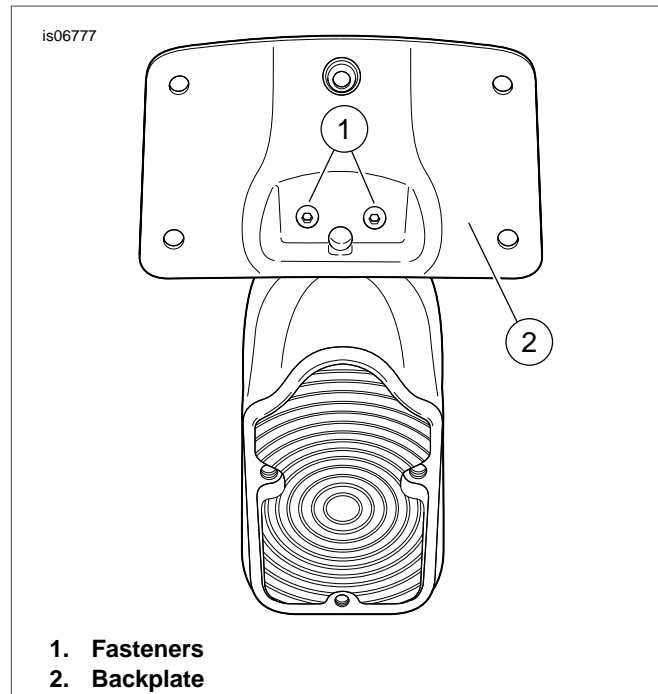

Figure 4. Backplate

REFLECTOR INSTALLATION

WARNING

Federal Motor Vehicle Safety Standard (FMVSS) 108 requires motorcycles to be equipped with rear and side reflectors. Be sure rear and side reflectors are properly mounted. Poor visibility of rider to other motorists can result in death or serious injury. (00336b)

NOTE

Ambient temperature should be **at least** 60 °F (16 °C) for proper adhesion of the reflector assembly (12) to the rear fender.

1. Clean the rear fender area beneath the tail light with a mixture of 50 to 70% isopropyl alcohol and 30 to 50% distilled water. Allow to dry thoroughly.
2. Before removing the adhesive backing of the reflector assembly, test fit the reflector to the fender, centered from left to right, so the reflector surface is parallel to the tail light. Mark the final location.
3. Peel the liner from the adhesive backing of the reflector assembly. Carefully position the reflector to the rear fender, and press firmly into place. Hold the reflector in position with steady pressure for one minute to permit proper adhesion.

NOTES

- Allow **AT LEAST 24 hours** after applying the reflector before exposing the area to vigorous washing, strong water spray or extreme weather.
- The adhesive bond will increase to maximum strength after about 72 hours at normal room temperature.