



# INSTRUCTIONS

-J04990

2011-03-22

## LED FRONT TURN SIGNALS

### GENERAL

#### Kit Numbers

67800060 (smoked), 67800061, (amber)

#### Models

For model fitment information, see the P&A retail catalog or the Parts and Accessories section of [www.harley-davidson.com](http://www.harley-davidson.com) (English only).

#### Tools and Supplies Required

Electrical Contact Lube (Part No. 99861-02) or equivalent is required after battery cable disconnection. This item is available from a Harley-Davidson dealer.

Some models will require use of an UltraTorch UT-100 (HD-39969), Robinair Heat Gun (HD-25070) with Heatshrink Attachment (HD-41183), or other suitable radiant heating device.

#### ⚠ WARNING

The rider's safety depends upon the correct installation of this kit. Use the appropriate service manual procedures. If the procedure is not within your capabilities or you do not have the correct tools, have a Harley-Davidson dealer perform the installation. Improper installation of this kit could result in death or serious injury. (00333a)

#### NOTE

This instruction sheet refers to service manual information. A service manual for this year/model motorcycle is required for this installation and is available from a Harley-Davidson dealer.

#### Kit Contents

See Figure 2 and Table 1.

### PREPARATION

#### NOTE

**For vehicles equipped with security siren:**

- Verify that the Hands-Free Fob is present.
- Turn the ignition key switch to IGNITION.

For EFI models:

#### ⚠ WARNING

To prevent spray of fuel, purge system of high-pressure fuel before supply line is disconnected. Gasoline is extremely flammable and highly explosive, which could result in death or serious injury. (00275a)

Follow service manual instructions to purge the fuel supply of high pressure gasoline and remove the fuel supply line.

For vehicles with main fuse:

#### ⚠ WARNING

To prevent accidental vehicle start-up, which could cause death or serious injury, remove main fuse before proceeding. (00251b)

1. Refer to the service manual and follow the instructions to remove the main fuse. Remove and retain the seat and all mounting hardware.

For ALL models:

#### ⚠ WARNING

When servicing the fuel system, do not smoke or allow open flame or sparks in the vicinity. Gasoline is extremely flammable and highly explosive, which could result in death or serious injury. (00330a)

2. Loosen the fuel tank. See the correct section (Carbureted or EFI Engine) of the service manual for instructions.

### FRONT TURN SIGNAL LAMP REMOVAL

#### NOTE

Cover the front fender with an H-D Service Cover or clean shop towel to prevent scratching the finish.

### Models With Fork-Mounted Turn Signals

1. Separate the turn signal connector halves under the fuel tank.
2. Make note of the wire colors and positions in each cavity of the Multilock **socket housing** leading from the turn signals. Refer to the wiring diagram and the Tyco/AMP MULTILOCK ELECTRICAL CONNECTORS section in the service manual. Remove the terminals from **only** the socket housing. DO NOT remove the terminals from the pin housing leading from the vehicle harness.
3. Make note of the turn signal wire routing, and the location of cable straps that must be replaced. Remove the front turn signals from the turn signal clamps or stalks. Retain the clamps or stalks and all mounting hardware. The lamps may be discarded.

### Models With Handlebar-Mounted Turn Signals With External Wiring Connected to Lower Turn Signal Connector

Perform the following:

1. Separate the turn signal connector halves under the fuel tank.

2. Make note of the wire colors and positions in each cavity of the Multilock **socket housing** leading from the turn signals. Refer to the wiring diagram and the correct section in the service manual appendix. Remove the terminals from **only** the socket housing. **DO NOT** remove the terminals from the pin housing leading from the vehicle harness.
3. Remove and discard the original equipment front turn signals from the vehicle handlebars.

## Models With Handlebar-Mounted Turn Signals Directly Wired to Hand Control Switches

Installation of protective shrink tubing over wire leads is necessary in the installation of the new turn signals to the motorcycle.

1. See Figure 1. Cut the turn signal wires and conduit flush with the grommet (1) on the underside of the handlebar lower switch housing (2).
2. Separate the upper (3) and lower switch housings per service manual instructions.
3. Remove the grommet from the end of the turn signal wire vinyl conduit (4) still connected to the switch housing.
4. Make about a one inch (25 mm) long slit in the end of the conduit. Cut one wire back about 1/2 inch (12 mm) from the end of the conduit. Cut the second wire back about 1/4 inch (6 mm) from the end of the conduit.
5. Slip the two-inch (50.8 mm) long section of encapsulating (dual wall) shrink tube (5) over the conduit and wires.

### ⚠ WARNING

**Be sure to follow manufacturer's instructions when using the UltraTorch UT-100 or any other radiant heating device. Failure to follow manufacturer's instructions can cause a fire, which could result in death or serious injury. (00335a)**

- Avoid directing heat toward any fuel system component. Extreme heat can cause fuel ignition/explosion resulting in death or serious injury.
  - Avoid directing heat toward any electrical system component other than the tubing on which heat shrink work is being performed.
  - Always keep hands away from tool tip area and heat shrink attachment.
6. Use a heat gun or suitable radiant-heating device to shrink the tubing to the wires and conduit.
  7. Assemble the switches and switch housings to the handlebar per service manual instructions, tucking the shrink-sealed wire ends back inside the switch housings. Repeat on the opposite side of the vehicle.

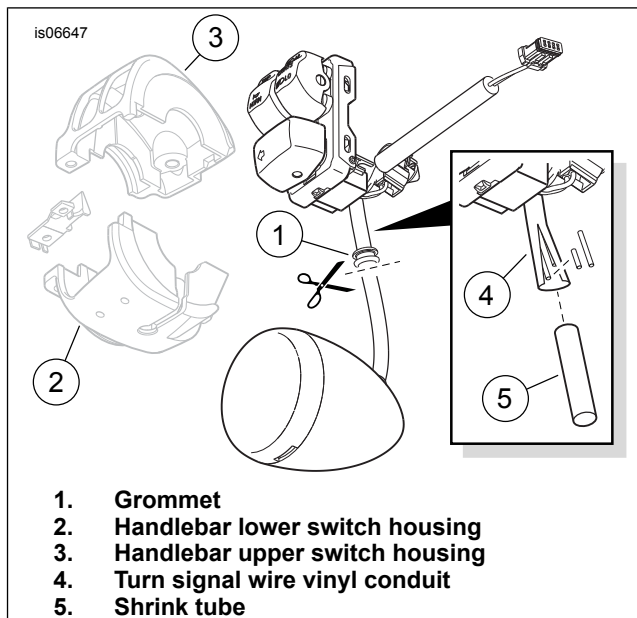

Figure 1. Cut Turn Signal From Switch Assembly

## NEW FRONT TURN SIGNAL LAMP INSTALLATION

### NOTE

Follow the steps below to connect the new turn signal wires into the turn signal connectors.

1. **ALL models:** See Figure 2. Obtain the **new** left- and right-front turn signal lamps from the kit.
2. Install the **new** right- and left-front turn signal lamps. **Models that HAD fork-mounted turn signals installed:** install the **new** right- and left-front turn signal lamps to the front forks using the clamps or stalks and mounting hardware removed earlier. Align the lamp housings so that the lenses will be aimed straight ahead for proper visibility. While holding each turn signal in position, tighten to 13.57–16.28 N·m (10–12 ft-lbs).
3. Route the turn signal wiring to the area under the fuel tank per the notes made earlier.
4. Install each terminal into the correct cavity of the socket housing per the notes made earlier. Note that the right-side lamp violet wire gets installed into the cavity that mates with a blue/orange wire. The left-side lamp violet wire gets installed into the cavity that mates with a blue/pink wire.
5. Connect the socket housing to the appropriate right or left main harness pin housing under the fuel tank. Install cable straps from the kit as needed to retain the turn signal wiring.

### ⚠ WARNING

**When servicing the fuel system, do not smoke or allow open flame or sparks in the vicinity. Gasoline is extremely flammable and highly explosive, which could result in death or serious injury. (00330a)**

6. Install the fuel tank per service manual instructions.

## FINAL ASSEMBLY

### NOTE

Verify that the ignition key switch is in the OFF position **before** installing the main fuse or attaching the negative battery cable.

### NOTE

Check for proper lamp operation before riding the motorcycle. Weak, intermittent, or non-operational lamps indicate a poor connection or a short in the wires.

1. **Models with main fuse:** Refer to the service manual and follow the instructions to install the main fuse.

### ▲ WARNING

Be sure that all lights and switches operate properly before operating motorcycle. Low visibility of rider can result in death or serious injury. (00316a)

## SERVICE PARTS

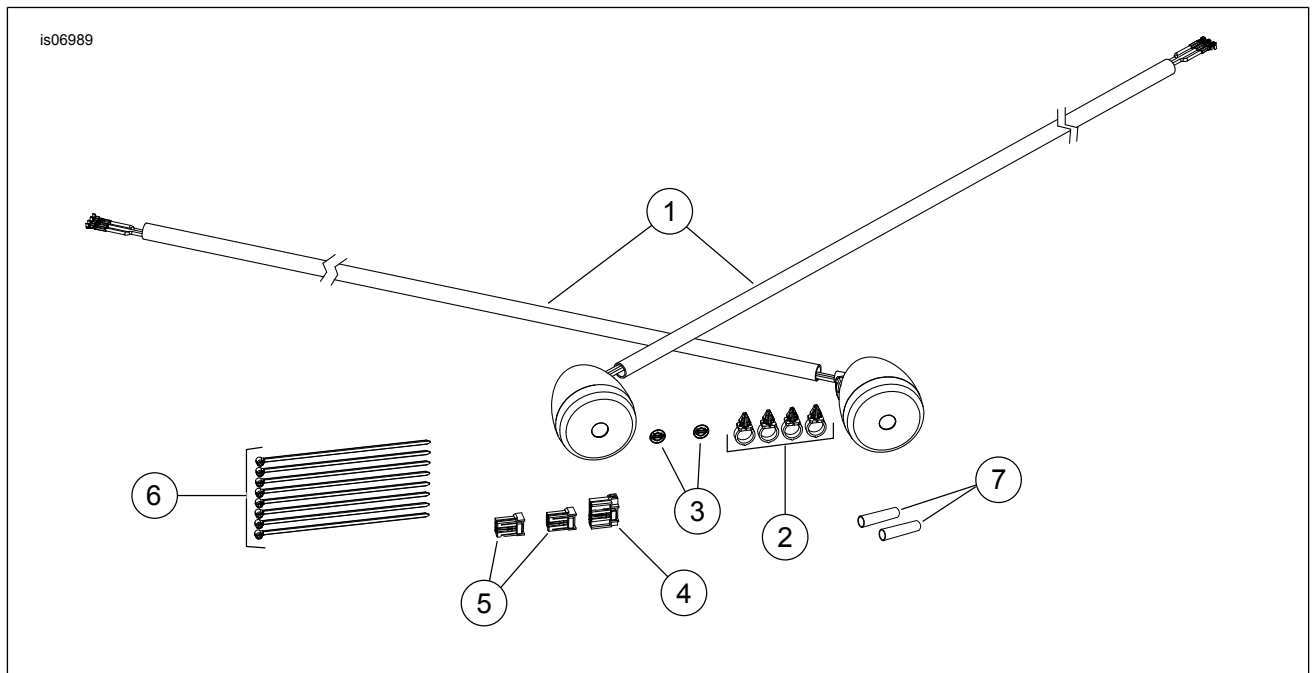

Figure 2. Service Parts: LED Front Turn Signals

Table 1. Service Parts Table

Item	Description (Quantity)	Part Number
1	Turn signal assembly (Smoked) (2)	67800063
	Turn signal assembly (Amber) (2)	67800062
2	Harness retainer (4)	70345-84
3	Bar and Shield logo (2)	14447-94
4	Socket housing, six position	73156-96BK
5	Housing receptacle, 3 position (2)	73153-96BK
6	Cable strap (8)	10065
7	Shrink tube (2)	72411-97

2. Hit the **Hazard** button and allow signals to flash 10 times to learn location of lights. Make sure that both turn signals function properly.

### NOTE

Allow **AT LEAST 24 hours** after applying the emblem before exposing the area to vigorous washing, strong water spray or extreme weather.

3. Peel the liner from the adhesive backing of one of the Bar & Shield emblems (3) from the kit. Orient the emblem with the logo upright, and carefully position the emblem to the recessed area in the center of the turn signal lens. Press firmly into place, ensuring that the edge is securely fastened all around. Repeat for the remaining turn signal.