



INSTRUCTIONS

-J02032

REV. 2006-03-21

DYNA BATTERY COVER

GENERAL

Kit Number

66192-99

Models

This kit is designed to fit 1991-2005 Dyna® model motorcycles.

Additional Parts Required

⚠ WARNING

The rider's safety depends upon the correct installation of this kit. Use the appropriate service manual procedures. If the procedure is not within your capabilities or you do not have the correct tools, have a Harley-Davidson dealer perform the installation. Improper installation of this kit could result in death or serious injury. (00333a)

NOTE

This instruction sheet references Service Manual information. A Service Manual for your model motorcycle is required for this installation and is available from a Harley-Davidson Dealer.

Kit Contents

See Figure 1 for kit contents.

There are no Service Parts available with this kit.

INSTALLATION

1. Remove seat.

⚠ WARNING

To prevent accidental vehicle start-up, which could cause death or serious injury, disconnect negative (-) battery cable before proceeding. (00048a)

⚠ WARNING

Disconnect negative (-) battery cable first. If positive (+) cable should contact ground with negative (-) cable connected, the resulting sparks can cause a battery explosion, which could result in death or serious injury. (00049a)

2. Disconnect battery cables, negative cable first.
3. Follow instructions in applicable Service Manual to loosen and lower battery tray.
4. Remove top and side covers and discard.

5. See Figure 1. Install cover from kit as follows:
 - a. Align bottom of cover with tray (2) making sure that three clips on bottom properly seat (center) on both sides of retaining lip (6) at the base of the battery tray.
 - b. Position top of cover (5) under the frame tube.
6. Raise tray and cover following instructions in Service Manual and tighten bolts (3,4) securely.

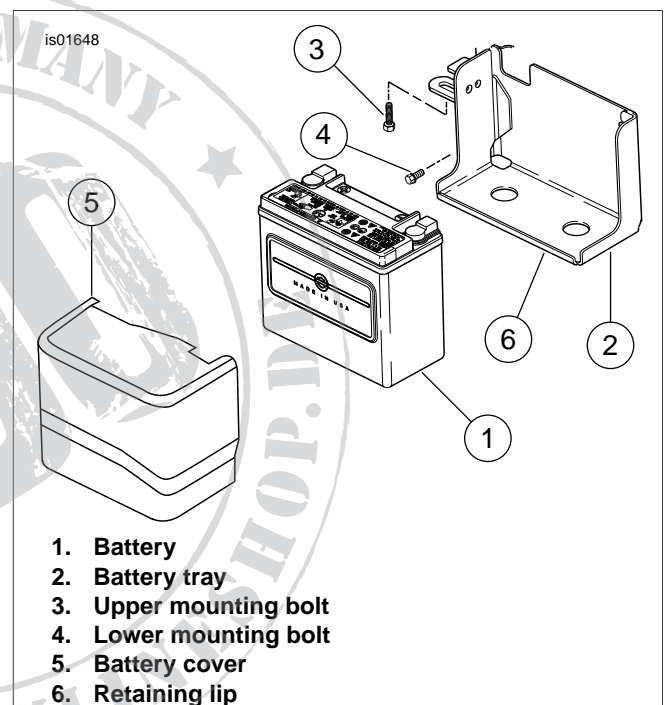

Figure 1. Battery Cover and Mounting Hardware

⚠ WARNING

Connect positive (+) battery cable first. If positive (+) cable should contact ground with negative (-) cable connected, the resulting sparks can cause a battery explosion, which could result in death or serious injury. (00068a)

7. Connect battery cables, positive cable first.
8. Install seat.

⚠ WARNING

After installing seat, pull upward on seat to be sure it is locked in position. While riding, a loose seat can shift causing loss of control, which could result in death or serious injury. (00070b)