



INSTRUCTIONS

-J00388

REV. 10-23-02

Kit Numbers 65245-96, 65252-96 and 65263-97

MUFFLER ENDCAP KIT

General

These kits are designed for installation on all Harley-Davidson Touring Mufflers and Softail exhaust systems with the following Part Numbers:

65259-00	1995 & later FLT models
65976-96	1995 & later FLT models
65255-96	1985-1994 FLT models
65281-96	1986 & later Softail models (dual exhaust)
65979-96	1986 & later Softail models (2 into 1 exhaust)
65980-97	1997 & later FLSTS

NOTE

Each kit contains one (1) endcap and one hardware pack, therefore, two kits may be needed to complete your exhaust system (2 into 1 exhaust only needs one). Part No. 65245-96 contains fishtail endcap; Part No. 65252-96 contains turnout endcap; Part No. 65263-97 contains Shark Fin endcap.

QTY	DESCRIPTION	PART NUMBER
1	Hardware kit, contains following:	65315-96
	(3) Countersunk screws	Not sold separately
	(3) U-nuts	Not sold separately
1	Endcap	Not sold separately

The only Service Part for this kit is the hardware kit.

Installation Of Endcaps

WARNING

Do not work on a hot exhaust system. Wait until system has cooled to avoid severe burns.

NOTE

Install endcaps on mufflers before installing mufflers on vehicle. A rawhide mallet or similar tool should be used to drive the end caps onto the muffler bodies. This is due to a tight fit which reduces carbon tracking and adds durability to the end cap joint.

1. See Figure 1, View A. Slide the three U-nuts onto the bosses of the inner cup on the muffler.
2. Slide endcap onto muffler body being careful to align holes in endcap with U-nuts.

NOTE

If turnout endcap is being installed, see Figure 2. The endcap may be installed in any of the three positions shown.

3. Install the three countersunk screws and tighten screws securely.
4. Wipe endcap and muffler to remove fingerprints and any other oils or dirt.

CAUTION

After installation, wipe all fingerprints off the exhaust system. Failure to thoroughly clean the system will result in oil from hands burning permanently into the finish of the exhaust system, damaging the cosmetic integrity of the exhaust pipes and end caps.

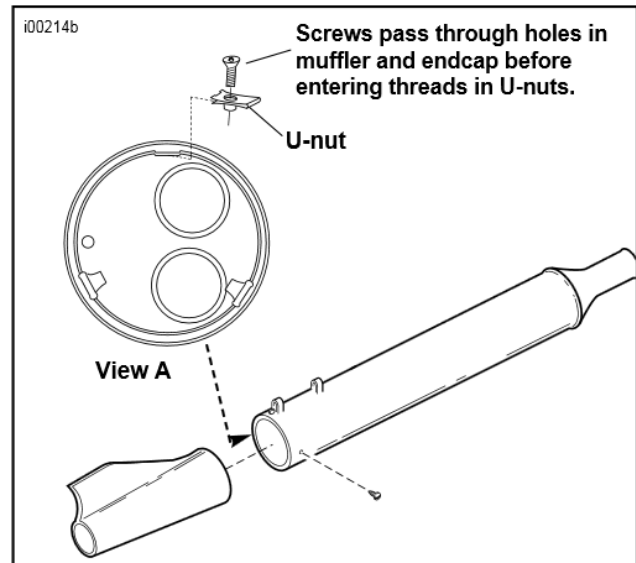

Figure 1. Installing Endcap

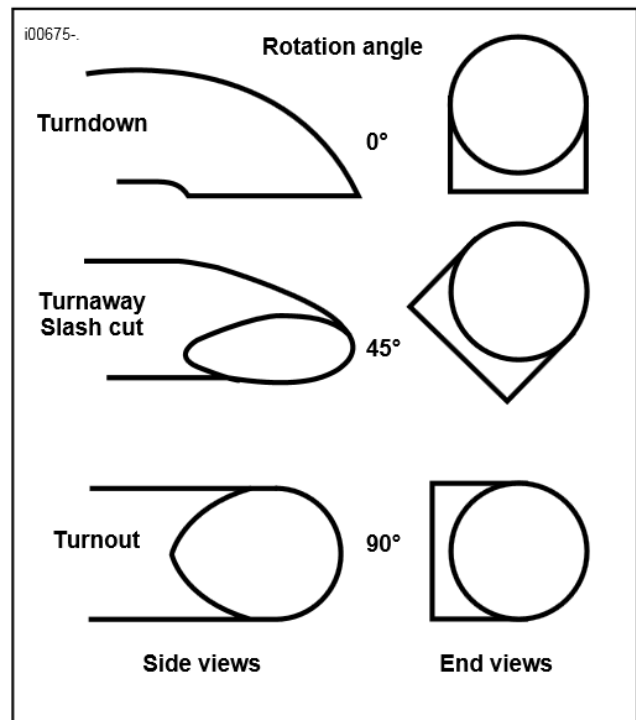

Figure 2. Positioning Turndown Endcap

5. Install muffler following the Instruction Sheet included in the muffler or exhaust system kit.