



# INSTRUCTIONS

-J02072

REV. 2006-12-21

## CHROME OIL FILLER SPOUT

### GENERAL

#### Kit Number

62470-02

#### Models

For model fitment information, please see the P&A Retail Catalog or the Parts and Accessories section of [www.harley-davidson.com](http://www.harley-davidson.com) (English only).

#### Additional Parts Required

Loctite® 243, Threadlocker and Sealant (blue)

#### Kit Contents

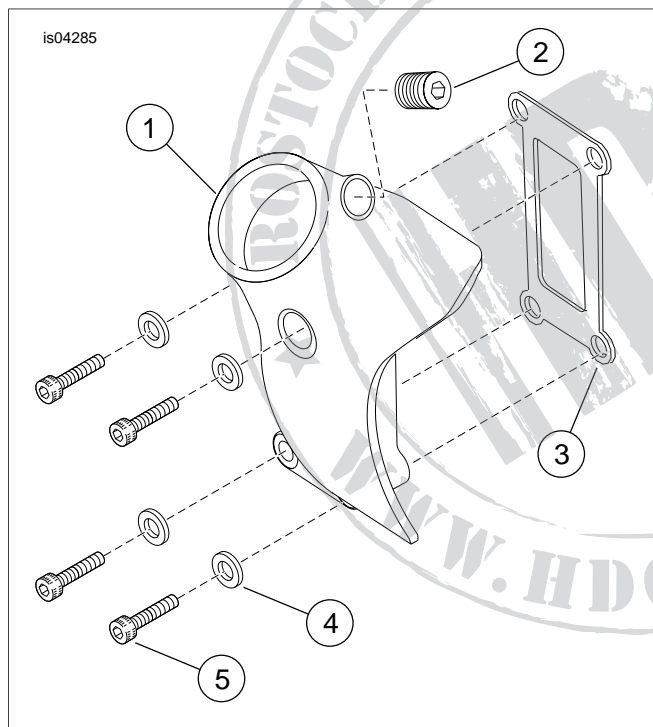

Figure 1. Service Parts: Chrome Oil Filler Spout

### INSTALLATION

1. See Figure 1 and Table 1. Remove the dipstick from the stock oil-filler spout. Save the dipstick for installation.
2. If the vehicle is **2002 or later**, go to Step 3. Otherwise, go to Step 4.
3. Remove the hose clamp and vent hose from the hose barb fitting. The hose barb fitting is located on the right side of the spout. Save the hose, hose clamp, and hose barb fitting for installation.
4. Remove the screws fastening the stock oil filler spout to the transmission housing.
5. Remove the stock oil spout gasket and carefully scrape all gasket material from the transmission housing, being sure not to cut into the gasket surface on the transmission housing.
6. Fasten the new gasket (3) and oil filler spout (1) onto the transmission housing using screws (5) and washers (4). Tighten the screws to 7-9 ft-lbs (9.5-12.2 Nm).
7. If the vehicle is **2002 or later**, go to Step 8. Otherwise, go to Step 11.
8. On **2002 or later** vehicles, clean the threads on the hose barb fitting and apply Loctite 243 sealant to the threads. Do not allow excess thread sealant to enter the oil tank.
9. Install the hose barb fitting, hose, and hose clamp removed from Step 3. Tighten the hose barb fitting to 10-14 ft-lbs (13.6-19.0 Nm).
10. Slide the hose clamp over the vent hose and install the hose on the hose barb fitting. Tighten the hose clamp. Go to Step 12.
11. For **2001 and earlier vehicles**. Install the 1/4-inch NPT plug (2) as shown below. Tighten the plug to 10-14 ft-lbs (13.6-19.0 Nm).
12. Replace the stock dipstick in the new oil filler spout.

Table 1. Kit Contents

Description (Quantity)	Part Number
Spout, oil filler, chrome	Not Sold Separately
Plug, 1/4 inch NPT	765
Gasket, oil spout	62432-93A
Washer (4)	6287
Screw (4)	94315-91T