



# INSTRUCTIONS

-J05927

2014-04-29

## PASSING LAMP TRIM RINGS

### GENERAL

#### Kit Number

61400255

#### Models

For model fitment information, see the P&A Retail Catalog or the Parts and Accessories section of [www.harley-davidson.com](http://www.harley-davidson.com) (English only).

#### ▲ WARNING

The rider's safety depends upon the correct installation of this kit. If the procedure is not within your capabilities or you do not have the correct tools, have a Harley-Davidson dealer perform the installation. Improper installation of this kit could result in death or serious injury. (00308a)

#### Kit Contents

See Figure 1 and Table 1.

### INSTALLATION

- Loosen the screw from one original equipment passing lamp trim ring. Remove the ring.
- See Figure 1. Remove the screw (2) from the accessory trim ring (1) and set aside temporarily.

#### NOTE

*Rotating the lamp unit may help insertion.*

- Insert the passing lamp sealed unit (B) inside the new trim ring.
- Position the bottom of the lamp unit to line up with the split in the trim ring.
- 2002 and later models:** Install the adapter ring (C) onto the passing lamp housing. Align the tab on the ring with the notch in the lamp housing. Install the trim ring and lamp assembly onto the adapter ring. Align the lug (or lugs) on the back of the glass lamp unit with the notches in the adapter ring. **1962 through 2001 models:** Install the trim ring and lamp assembly onto the passing lamp housing. Align the lug (or lugs) on the back of the glass lamp unit with the notches in the passing lamp housing.
- Assemble the screw into the trim ring. Tighten to 0.8–1 N·m (7–9 in-lbs).

### SERVICE PARTS

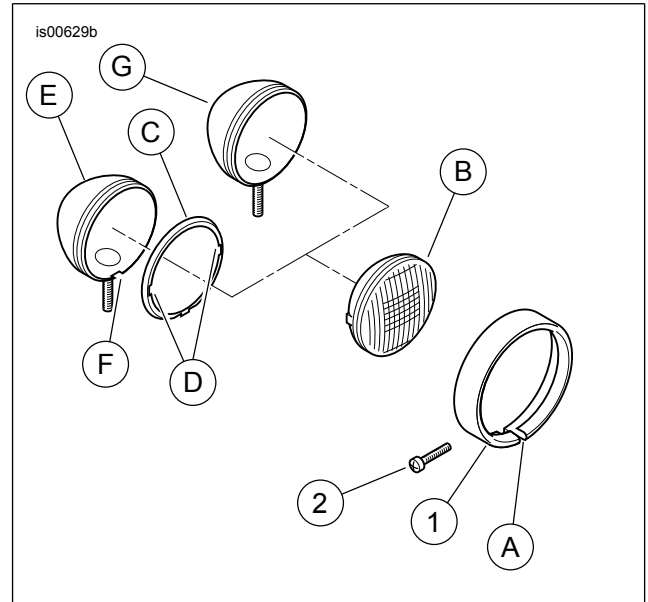

Figure 1. Passing Lamp Trim Rings

Table 1. Service Parts: Passing Lamp Trim Rings

Item	Description (Quantity)	Part Number
1	Trim Ring	Not Sold Separately
2	Screw (6-32 x .625)	10200394
A	Split in trim ring	Reference only
B	Passing lamp sealed unit	Reference only
C	Adapter ring (2002 and later)	Reference only
D	Alignment notches	Reference only
E	Passing lamp housing (2002 and later)	Reference only
F	Alignment notch	Reference only
G	Passing lamp housing (1962-2001)	Reference only

