



INSTRUCTIONS

-J06342

2016-04-06

MILWAUKEE-EIGHT - SCREAMIN' EAGLE AIR CLEANER MEDALLION

GENERAL

Kit Number

61300762

Models

For model fitment information, see P&A Retail Catalog or the Parts and Accessories section of www.harley-davidson.com (English only).

Installation Requirements

This kit requires the separate purchase of Loctite® 243 Medium Strength Threadlocker and Sealant - Blue (Part Number 99642-97)

▲ WARNING

The rider's safety depends upon the correct installation of this kit. Use the appropriate service manual procedures. If the procedure is not within your capabilities or you do not have the correct tools, have a Harley-Davidson dealer perform the installation. Improper installation of this kit could result in death or serious injury. (00333a)

NOTE

This instruction sheet references service manual information. A service manual for your model motorcycle is required for this installation. One is available from a Harley-Davidson dealer.

Kit Contents

See Figure 1 and Table 1.

REMOVAL

1. Remove main fuse. Refer to main fuse in service manual.
2. See Figure 1 and Table 1. Remove air cleaner cover.

INSTALLATION

Install Air Cleaner Cover and Insert.

NOTE

Whenever the air cleaner cover is installed, apply Loctite 243 (blue) to the air cleaner cover screw (2).

1. Carefully remove and discard the original air cleaner cover insert from air cleaner. Remove any residual adhesive on the cover with mineral spirits.

NOTE

The air cleaner cover insert in this kit utilizes 3M™ Dual Lock™ Reclosable tape. This tape can be separated and

pressed back together for service access to the air cleaner cover screw.

2. To verify surface cleanliness, clean the insert area with a mixture of 50/50 to 70/30 isopropyl alcohol and distilled water. Allow to dry completely.
3. Peel liner from adhesive backing of air cleaner cover insert (1). Position insert over air cleaner cover (A) without touching adhesive on cover surface. Line up insert with recess in air cleaner cover.

NOTE

Allow at least 24 hours after applying the insert before exposing the area to vigorous washing, strong water spray, or extreme weather. The adhesive bond will increase to maximum strength after about 72 hours at normal room temperatures.

4. Press air cleaner cover insert firmly against the cover all around, and hold pressure for 30 seconds. After releasing pressure, avoid direct contact with the insert for about 20 minutes.
5. Carefully pry air cleaner insert (1) off the air cleaner cover to access the air cleaner cover mounting screw hole.
6. Assemble and tighten the air cleaner cover screw (2) securely 4.1–8 N·m (36–60 in-lbs).

Final Assembly

1. Install main fuse.

Service Parts

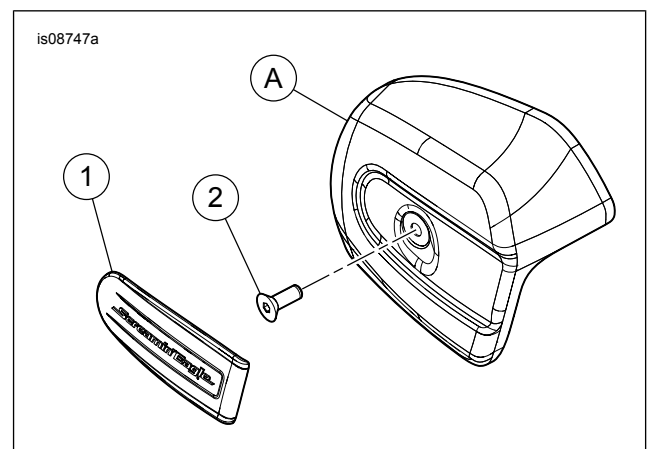

Figure 1. Screamin' Eagle Air Cleaner Medallion

-J06342



Many Harley-Davidson® Parts & Accessories are made of plastics and metals which can be recycled. Please dispose of materials responsibly.

1 / 2

Table 1. Service Parts Table

Item	Description (Quantity)	Part Number
1	A-C cover insert	Not Sold Separately
2	Air cleaner cover screw	3655A
Items mentioned in text, but not included in kit:		
A	Air cleaner cover	