



INSTRUCTIONS

-J04271

REV. 2007-09-05

STAINLESS STEEL SPLASHGUARD

GENERAL

Kit Number

60197-08

Models

For model fitment information, please see the P&A Retail Catalog or the Parts and Accessories section of www.harley-davidson.com (English only).

Additional Parts Required

Separate purchase and installation of additional parts or accessories may be required for proper installation of this kit on your model motorcycle. Please see the P&A Retail Catalog or the Parts and Accessories section of www.harley-davidson.com (English only) for a list of required parts or accessories for your model.

WARNING

The rider's safety depends upon the correct installation of this kit. Use the appropriate service manual procedures. If the procedure is not within your capabilities or you do not have the correct tools, have a Harley-Davidson dealer perform the installation. Improper installation of this kit could result in death or serious injury. (00333a)

NOTE

This instruction sheet references Service Manual information. A Service Manual for your model motorcycle is required for this installation and is available from a Harley-Davidson Dealer.

Kit Contents

See Figure 4 and Table 1.

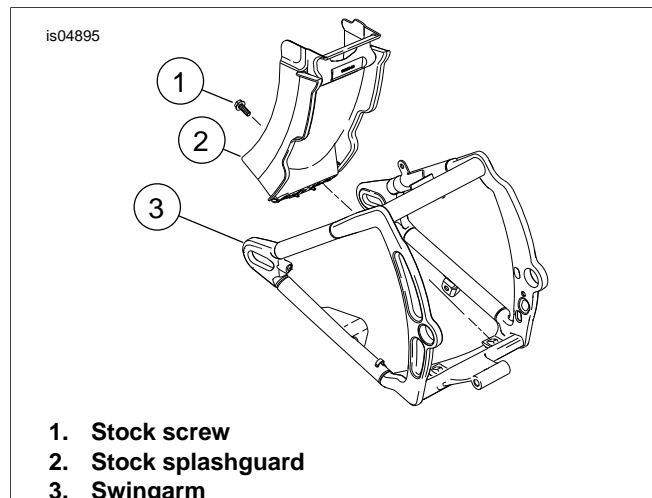

Figure 1. Stock Splashguard

INSTALLATION

WARNING

To prevent accidental vehicle start-up, which could cause death or serious injury, remove maxi-fuse before proceeding. (00251a)

1. Refer to the appropriate Service Manual and remove the Maxi® fuse.
2. Refer to the applicable Service Manual and remove the rear wheel.
3. See Figure 1. Remove one screw (1) and stock splashguard (2) from swingarm (3).
4. Remove the protective film from the new splashguard.
5. See Figure 4. Using two screws (4) and nuts (2), loosely install the H-clips to the back of the splash guard vertically as shown.

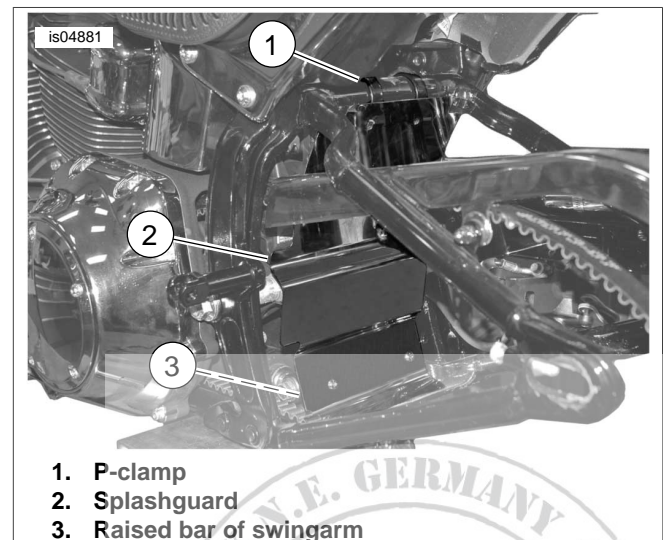

Figure 2. Install Splashguard

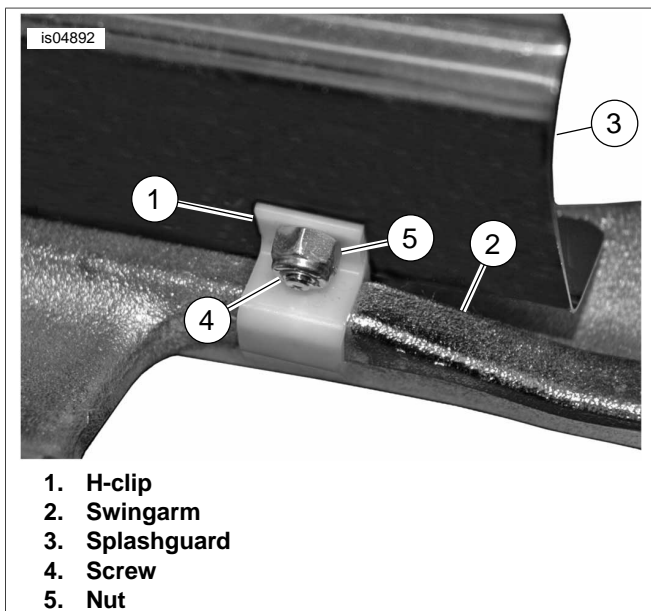

Figure 3. H-Clips Installed on Swingarm

6. See Figure 2. Slide two P-clamps (1) around the upper bar of the rear fork. The straight side of the clamp will face rearward, as shown in Figure 4.

7. See Figure 4. Orient the splashguard with the polished side facing the rear wheel. Align the upper two holes with the P-clamp holes. Secure splashguard to the P-clips with two screws (4) and locknuts (2). Do not tighten at this time.
8. See Figure 3. Turn H-clips (1) horizontal on the splashguard. Press splashguard (3) into place. When the splashguard is in place, rotate the H-clips down over the raise bar of the swingarm (2). Tighten the screw (4) and nut (5) to secure the H-clips.

NOTE

If adequate clearance does not exist between the splashguard and rear brake line and drive belt, adjust fender extension by loosening hardware and centering the splashguard.

9. See Figure 4. Ensure the splashguard does not touch the drive belt on the left side and the rear brake line on the right side, then tighten P-clip mounting screws (4) and nuts (2) securely.
10. Refer to the applicable Service Manual and install the rear wheel.
11. Refer to the appropriate Service Manual and install the Maxi fuse.

SERVICE PARTS

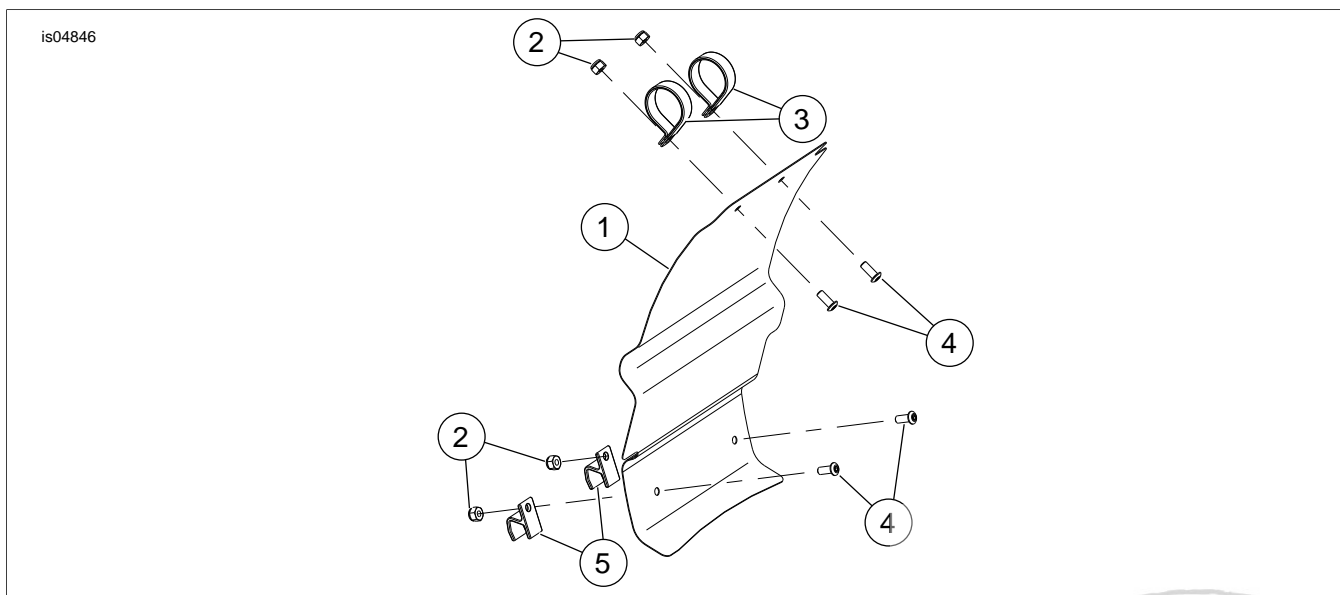

Figure 4. Service Parts for Softail Splashguard Kit

Table 1. Service Parts Table

Item	Description (Quantity)	Part Number
1	Splash guard	Not Sold Separately
2	Locknut	7686
3	Clamp, rubber cushioned (2)	10332
4	Screw, button head (4)	94385-92T
5	Mounting clip (2)	10330

