



INSTRUCTIONS

-J03284

REV. 04-30-2004

Kit Number 60060-04

BILLET LICENSE-PLATE FRAME KIT

General

This kit fits license plates measuring a maximum of 7-1/4 in. by 4-1/4 in. (18.4 cm x 10.8 cm).

This kit can be used on all motorcycle models except those equipped with Chrome License-Plate Mount 59720-01A or 59726-04, or a Layback License-Plate Mounting Kit.

See the Service Parts list for kit contents.

Installation

1. Remove the screws and nuts fastening the license plate (if installed) to the bracket.

NOTE

In most cases, the Billet License-Plate Frame can be mounted with the nameplate cavity either at the top or the bottom. See Figure 1. See reflector note later in these

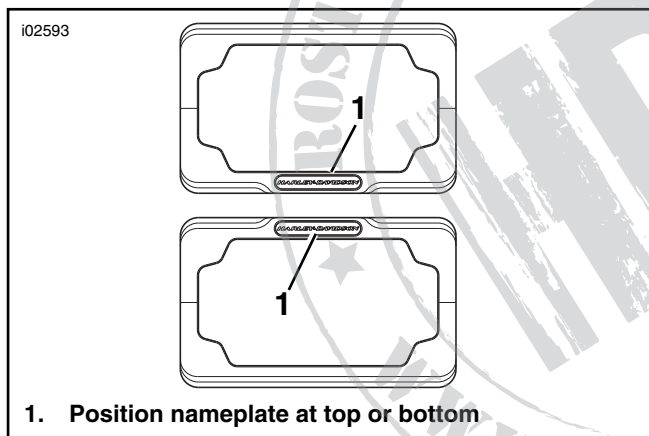

1. Position nameplate at top or bottom

Figure 1. License Plate Frame Orientation Options

instructions for exception.

2. See the Service Parts illustration. Obtain the license-plate frame (1) and two "T"-slot screws (3 or 4) from the kit. Slide the screws into the lower slots in the frame.
3. Place the license-plate frame on the bracket, aligning the screws in the frame to the bottom screw holes of the stock bracket.
 - If the bottom of the license-plate frame covers any part of the reflector on the bottom of the stock bracket, go to step 4.
 - If the bottom of the license-plate frame **does not cover** any part of the reflector on the bottom of the stock bracket, go to step 5 for your model.

4. Set the frame and screws aside. Remove the existing reflector. Clean any remaining adhesive from the bracket with a mixture of 50 to 70% isopropyl alcohol and 30 to 50% distilled water or, if necessary, straight isopropyl alcohol. Allow the bracket to dry thoroughly, then go to step 5 for your model.

For Models With Three-Point License Bracket:

NOTE

*If the original reflector was removed, and the new reflector will not fit **below** the new license-plate frame, the frame should only be installed with the nameplate cavity at the top.*

5. See Figure 2. Rotate the new license-plate frame to place the nameplate cavity at the top or bottom, as desired (see Figure 1). Insert two long "T"-slot screws (4) from the kit into the lower slots in the frame. Insert the two short "T"-slot screws (3) into the upper slots in the frame.
6. Place the vehicle license-plate over the threads of the four "T"-slot screws installed in Step 5. Install the backing plate, with the tab up and bent **away** from the license plate, over the screw threads.
7. Hook the tab at the top of the backing plate under the OE license-plate bracket clamp. Insert the two lower screws through the holes in the bracket. Install a flat washer and lock nut from the kit onto each of the four screws. Tighten all lock nuts to 10 **in-lbs** (0.1 Nm). Proceed to Step 10.

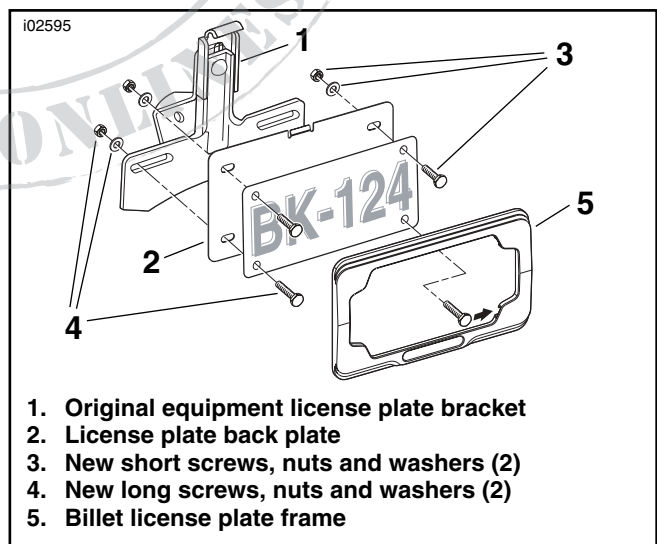

Figure 2. Install License and Frame (Models With 3-Point Mounting Bracket)

**For 2000 and Later FX Softail Models,
For 1999 and later FXDWG Models,
For all VRSC Models,
For models fitted with a Bobtail Fender Kit:**

- See Figure 3. Temporarily fasten the bottom of the license-plate back plate (2) and license plate (3) to the OE license-plate/ tail lamp bracket (1) with the screws and nuts (4) removed in Step 1, but do not tighten.

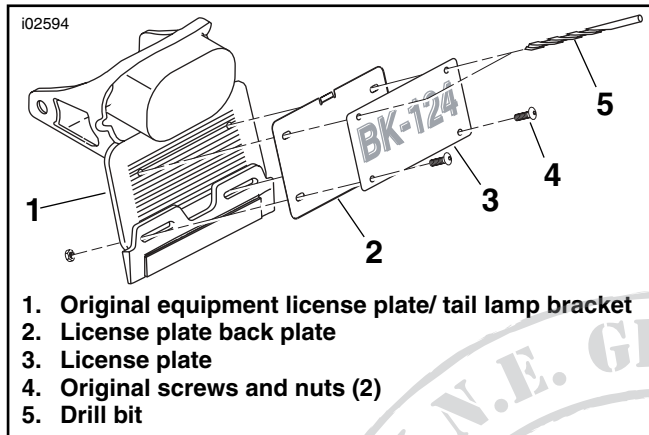

Figure 3. Drill License Bracket Mounting Holes (FX Softail and FXDWG Models)

- Place a block of wood between the rear tire and the OE license-plate bracket.
 - Use the license plate as a template to mark the frame's two upper mounting locations on the OE bracket. Remove the back plate from the bracket.
 - Drill a 1/16-in. pilot hole through the bracket at each of the two upper mounting locations.
 - Enlarge the pilot holes using a 9/32-in. drill bit.
 - Remove the wood block. Remove and discard the OE screws and nuts.
- Rotate the new license-plate frame to place the nameplate cavity at the top or bottom, as desired (see Figure 1). Insert four long "T"-slot screws (4) from the kit into the slots in the frame.
- Place the vehicle license plate over the threads of the four "T"-slot screws installed in Step 7. Install the backing plate, with the tab up and bent **away** from the license plate, over the screw threads.
- Insert the four screws through the holes in the OE bracket. Install a flat washer (5) and lock nut (6) onto each screw. Tighten all fasteners to 10 **in-lbs** (0.1 Nm). Proceed to Step 10.

For Touring Models:

NOTE

*If the original reflector was removed, and the new reflector will not fit **below** the new license-plate frame, the frame should only be installed with the nameplate cavity at the top.*

- See Figure 4. Rotate the new license-plate frame to place the nameplate cavity at the top or bottom, as desired (see Figure 1). Insert two long "T"-slot screws (4) from the kit into the lower slots in the frame. Insert the two short "T"-slot screws (3) into the upper slots in the frame.

- Place the vehicle license plate over the threads of the "T"-slot screws installed in Step 5. Install the backing plate, with the tab up and bent **away** from the license plate, over the screw threads.
- Insert the screws through the holes in the original equipment license-plate bracket. Install a flat washer and lock nut from the kit onto each of the four screws. Tighten all lock nuts to 10 **in-lbs** (0.1 Nm). Proceed to Step 10.

ALL Models:

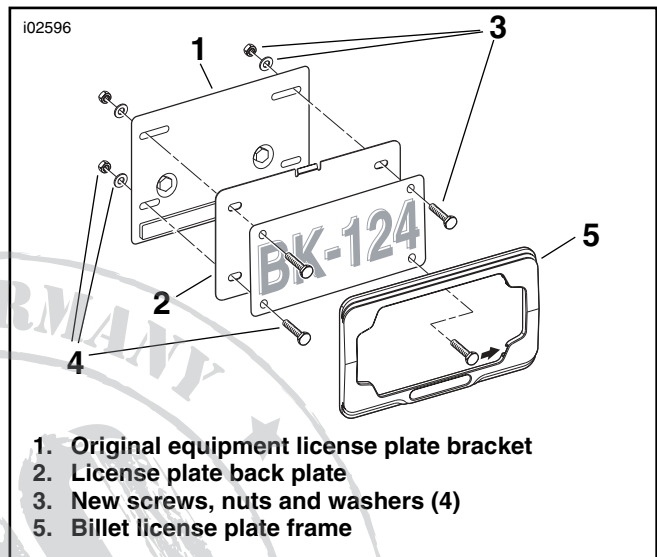

Figure 4. Install License and Frame (Touring Models)

- See the Service Parts illustration.
 - Choose the appropriate nameplate (8) from the kit. Remove the adhesive-strip cover from the back of the nameplate.
 - Position the nameplate in the nameplate cavity and press the adhesive backing firmly into place.
 - Firmly rub the nameplate, applying enough pressure to ensure a strong adhesive bond to the frame.

WARNING

Federal Motor Vehicle Safety Standard (FMVSS) 108 requires motorcycles to be equipped with rear and side reflectors. Be sure rear and side reflectors are properly mounted. Low visibility of rider can result in death or serious injury. (00336a)

If the original reflector was removed:

- Obtain the new rear reflector (7) from the kit. Remove the adhesive-strip cover from the back of the reflector.
- Position the upper edge of the replacement reflector against the bottom edge of the new license-plate frame and press the adhesive backing firmly to the original equipment license-plate bracket. If the reflector does not fit **below** the license-plate frame, install the reflector **at the bottom** of the frame.
- Firmly rub the replacement reflector, applying enough pressure to the reflector to ensure a strong adhesive bond to the stock bracket.



Service Parts

Part No. 60060-04

Date 04/04

Billet License Plate Frame

102592

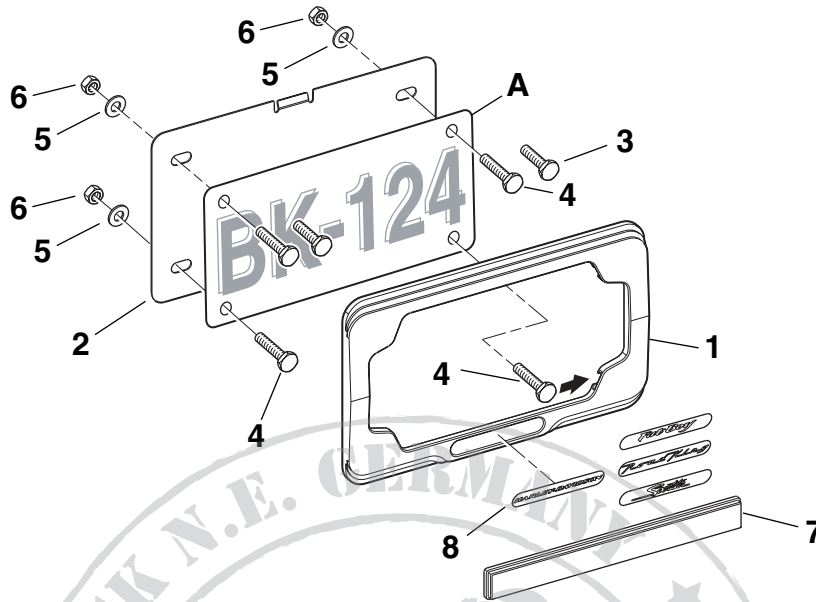

Item	Description (Quantity)	Part No.
1	License plate frame (billet)	Not sold separately
2	Back plate, license plate frame	Not sold separately
3	Screw, "T"-slot, 1/4-20 x 5/8 in. long (2)	4397
4	Screw, "T"-slot, 1/4-20 x 7/8 in. long (4)	4398
5	Flat washer, chrome, 1/4 in (2)	6868
6	Lock nut, Nylock, 1/4-20, chrome (4)	Not sold separately
7	Reflector, rear (red)	59988-72A
8	Nameplate, "Harley-Davidson"	Not sold separately
	Nameplate, "Fat Boy"	Not sold separately
	Nameplate, "Road King"	Not sold separately
	Nameplate, "Sportster"	Not sold separately

Not included in kit:

A License plate