



INSTRUCTIONS

-J02420

REV. 04-02-02

Kit Number 59720-01A

General

This kit is designed to fit:

- 1999 and later FXDWG Models,
- 2000 and later FXST, FXSTD, FXSTS and FXSTB Models, and
- 1998 and later XL models equipped with Bobtail Fender Kit 60025-01 (primed or colors).

See the Service Parts illustration for kit contents.

Installation

1. Remove the current license plate, discarding used hardware.
2. Remove and discard the reflector bracket from the license plate bracket.
3. **For 2003 and later FXST, FXSTB, FXSTD, FXSTS, and for 2002 and later FXDWG:**

The license plate bracket has the required holes already molded in. Proceed to Step 7.

For 2000-2002 FXST, FXSTB, FXSTD and FXSTS, for 1999-2001 FXDWG, and for 1999 and later XL:

Align the bottom slots of the chrome license plate bracket cover (1) with the slots in the license plate bracket. Temporarily mount the cover to the bracket using the supplied 1/4"-20 screws (4), 1/4 in. flat washers (3) and 1/4 in. acorn nuts (2)

4. To prevent damage to the rear tire, place a block of wood between the rear tire and the bracket. Drill a 3/16 in. hole through the bracket at each of the two upper holes in the cover.
5. Remove the chrome cover from the bracket.
6. With the block of wood back in place, enlarge the 3/16 in. diameter holes in the bracket by re-drilling them to 1/2 in. diameter. Proceed to Step 7.

For ALL Models:

7. Hold the chrome cover up to the bracket. Align the slots of the cover with the slots in the bracket, and align the two upper holes of the cover with the two upper holes in the bracket. The back of the cover should now mate up to the front surface of the bracket.
8. Assemble the chrome cover to the bracket by inserting one #10-32 flat head screw (7) through the bracket cover. From the back side of the bracket, place one #10 fender washer (6) on the flat head screw (7). Attach with one #10 keps nut (5) and tighten securely. Repeat for the other side.
9. Reinstall the license plate by inserting one 1/4"-20 button head screw (4) through a 1/4 in. flat washer (3). Insert the screw and washer assembly through the back side of the bracket and through the license plate mounting hole. Attach the license plate with a 1/4 in. flat washer (4) and a 1/4 in. acorn nut (2). Repeat for the second license plate mounting hole. Center the license plate on the cover. Securely tighten the acorn nuts.



Service Parts

Part No. 59720-01A

Date 04/02

License Plate Bracket Cover Kit

i03468.eps

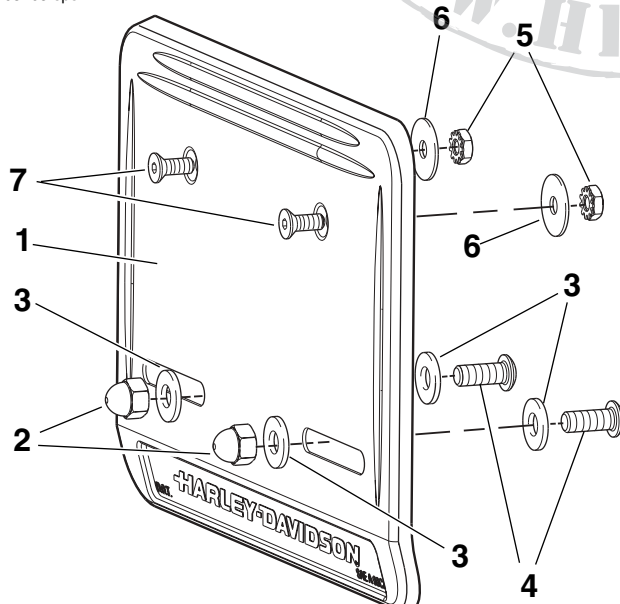

Item	Description	Part No.
1	License plate bracket cover	Not sold separately
2	Nut, 1/4"-20, acorn, chrome (2)	94012-00
3	Washer, flat, 1/4", chrome (4)	Not sold separately
4	Screw, 1/4"-20 x .62 long (2)	Not sold separately
5	Nut, keps, #10-32 (2)	Not sold separately
6	Washer, fender, #10 (2)	Not sold separately
7	Screw, #10-32 x .50, flat (2)	Not sold separately