



# INSTRUCTIONS

-J03364

REV. 5-26-04

Kit Number 59380-05 (Smoked) and 59381-05 (Clear)

## SMOKED AND CLEAR FENDER TIP LENS KITS

### General

These kits fit 1980 and later FLHT, FLT, FLHS, FLHR and 1986 and later FLSTC, 1993 to 1996 FLSTN model motorcycles.

These kits contain the following items:

#### Smoked Fender Tip Lens Kit 59380-05

QTY	DESCRIPTION	PART NO.
1	Front Lens Cover (Smoked)	59773-05
1	Rear Lens Cover (Smoked)	59771-05
1	Front LED Lamp (Amber)	59767-05
1	Rear LED Lamp (Red)	59763-05

#### Clear Fender Tip Lens Kit 59381-05

QTY	DESCRIPTION	PART NO.
1	Front Lens Cover (Clear)	59774-05
1	Rear Lens Cover (Clear)	59772-05
1	Front LED Lamp (Amber)	59767-05
1	Rear LED Lamp (Red)	59763-05

### CAUTION

It is possible to overload your motorcycle's charging system by adding too many electrical accessories. If your combined electrical accessories operating at any one time consume more electrical current than your vehicle's charging system can produce, the electrical consumption can discharge the battery and cause vehicle electrical system damage. See a Harley-Davidson Dealer for advice about the amount of current consumed by additional electrical accessories, or for necessary wiring changes. (00211b)

### NOTE:

These lamps require 0.05 amps of available current from the motorcycle's electrical system for each the front and rear lamp (0.10 amps total).

### Preparation

### WARNING

To prevent accidental vehicle start-up, which could cause death or serious injury, disconnect battery cables (negative cable first) before proceeding. (00048a)

### WARNING

Disconnect negative (-) battery cable first. If positive (+) cable should contact ground with negative (-) cable connected, the resulting sparks can cause a battery explosion, which could result in death or serious injury. (00049a)

1. Disconnect the battery cables, negative cable first.
2. See Figure 1. Insert blade of small screwdriver into slot at top of front fender tip lamp lens (2). Rotate end of screwdriver to unsnap lens from lamp bracket. Repeat for rear fender tip lamp lens.

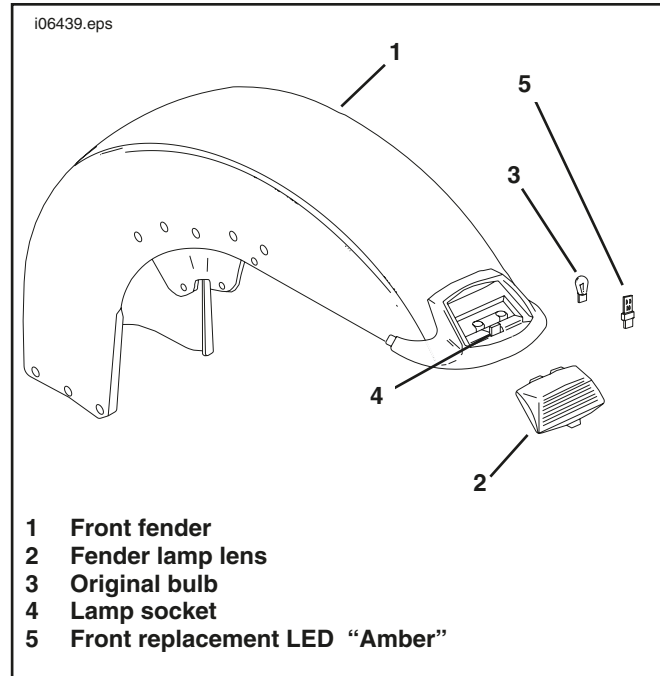

Figure 1. Front Fender Assembly Shown

3. Remove bulb (3) from socket (4).
4. From the kit, find the LED marked "Amber" (5) and install into front fender tip lamp assembly.lamp socket.
5. From the kit, find the LED marked "Red" (5) and install into rear fender tip lamp assembly.lamp socket.

### WARNING

Always connect the positive battery cable first. If the positive cable should contact ground with the negative cable installed, the resulting sparks may cause a battery explosion which could result in death or serious injury.

6. Connect the battery cables, positive cable first.
7. Apply power and check for proper function of front and rear fender tip lamps.

### NOTE:

If either lamp fails to illuminate, shut off power, remove lamp and install in opposite direction. Retest fender tip lamps for proper function

6. From the kit, find the front lens cover and install into front lamp bracket. The front lens is identified with the markings PM 1735-15.
7. From the kit, find the rear lens cover and install into rear lamp bracket. The rear lens is identified with the markings PM 1736-15.