



INSTRUCTIONS

-J01684

REV. 6-24-99

Kit Number 59133-99

BAR & SHIELD WINDSHIELD MOULDING

General

This kit is designed to fit 1996 and later Electra Glide model motorcycles.

This kit contains:

Quantity	Description
3	Washers, rubber
3	Washers, stainless
3	Screws, 1/4-20 x .625
1	Trim, windshield

Installation

1. See Figure 1. Remove the three original equipment (OE) screws in the locations shown.

CAUTION

Properly align the trim piece, fairing, windshield and brass insert before starting screws to prevent damage to the brass inserts due to cross-threading.

CAUTION

Do not over torque screws. Damage to mounting hardware, fairing, or windshield may result if recommended torque is exceeded when installing mounting screws.

2. Install windshield trim (4) with rubber washer (1), stainless washer (2) and screws (3) from the kit in same locations as OE screws as shown. The rubber washers (1) must be between the trim (4) and the fairing as shown. Start the center screw first, then start the two end screws. Center the windshield trim ends with the end of the fairing. Tighten center screw to **8-13 in-lbs**, then tighten the two end screws to **8-13 in-lbs**. **Do not over torque screws, per caution above.**



Service Parts

Part No. 59133-99

Date 6/99

Bar & Shield Windshield Moulding

i01687

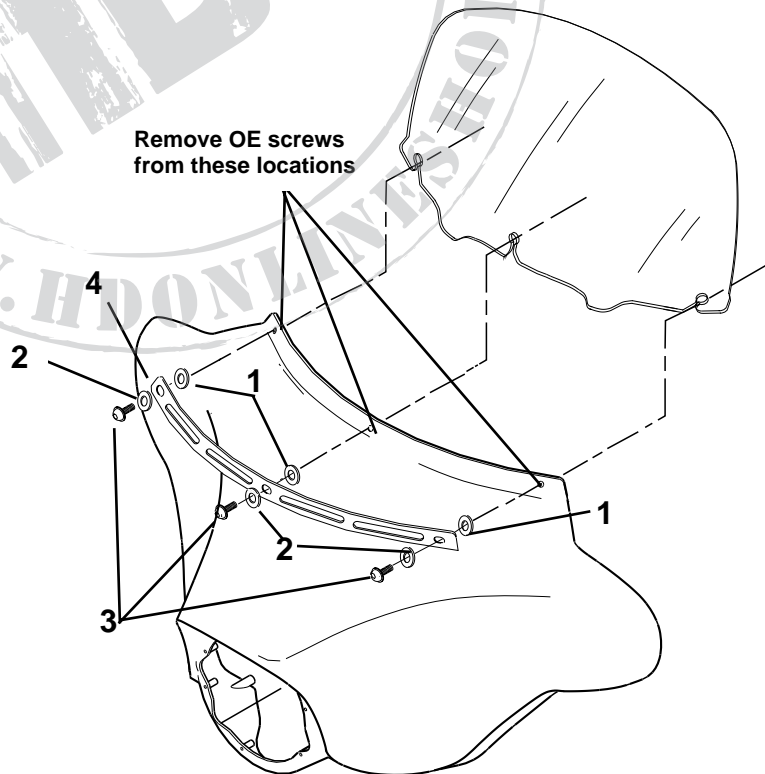

Item	Description	Part Number
1	Washer, rubber (3)	57765-99
2	Washer, stainless (3)	6383
3	Screw, 1/4-20 x .625 (3)	94676-99
4	Trim, windshield	Not sold separately