



# INSTRUCTIONS

-J01138

REV 11-20-97

Kit Number 59071-98

## FLSTC MUD FLAP KIT

### General

This kit is designed for installation 1986 and later FLSTC models.

See Service Parts Illustration on page two for kit contents.

### Installation

#### NOTE

If kit will be installed with chrome rear fender rail kit 91081-93, follow the proper instructions in Steps 7 and 8.

#### For installation on rear fender with marker light:

1. Cut out Rear Fender Template.
2. Use a paper punch to punch out holes marked **A** and **C**. Holes **A** are the locations of the marker light screws, and hole **C** is the location of the marker light wiring. Cut along centerline of template from top down to hole **C**.
3. Remove light lens by carefully pressing down on top center of light to disengage tab.
4. Remove the two screws, washers, and nuts that hold the marker light assembly in place and carefully pull the light assembly away from the fender. Discard the two screws, but save the nuts and washers for later use. Do not disconnect the wire connector.
5. Slip template over marker light wires, align holes marked **A** with marker light holes, and align lower edge of template with lower edge of fender. Tape template in place.
6. Prick punch holes marked **B** at indicated centers on template.
7. Carefully, and as accurately as possible, drill holes marked **B** in two steps. First drill holes with a 1/16" drill, then finish holes with a 7/32" drill.  
*If installing with chrome rear fender rail kit 91081-93, place kit 91081-93 assembly on loosely after drilling holes as explained above.*
8. See Service Parts illustration. Place the mud flap inside fender and secure outer holes with two of the buttonhead screws (3), washers (6), and two of the locknuts (4) contained in kit (The third locknut and buttonhead screw will not be used and may be discarded). The mud flap is split to fit around light assembly wires.  
*If installing with chrome rear fender rail kit 91081-93, slip mudflap up under the assembly for kit 91081-93, so that mudflap is between rear fender and assembly for kit 91081-93. The middle slot of the mudflap will fit up under tab. Secure mudflap with two of the buttonhead screws (3), washers (6), and two of the locknuts (4) contained in kit as shown in Service Parts Illustration (The third locknut and buttonhead screw will not be used and may be discarded). Then, tighten kit 91081-93 as directed in instruction sheet.*
9. Using the longer panhead screws (2) provided in the kit and the original nuts and washers saved from Step 4, install fender tip light and check that light is operational.

i00702a

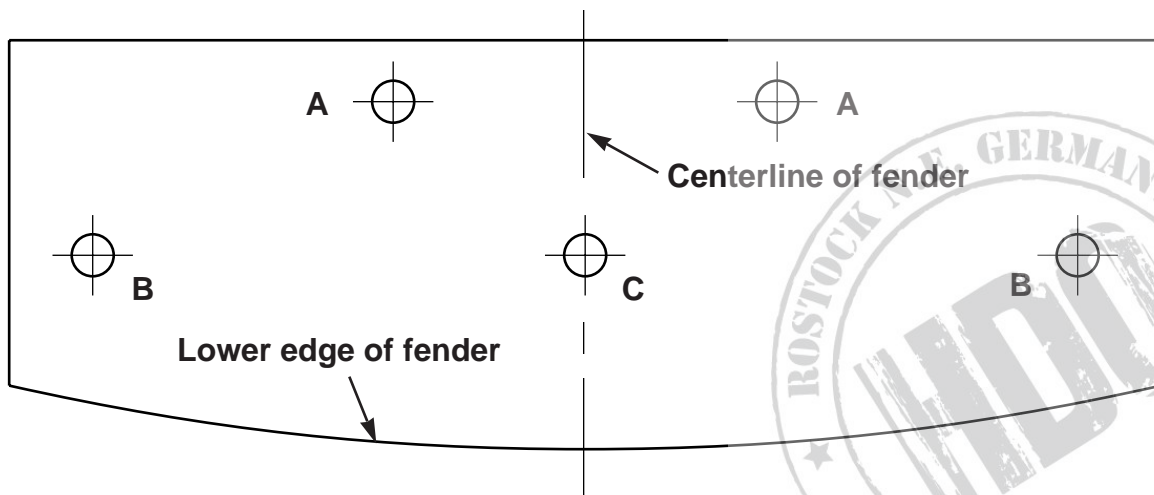

Rear Fender Template



# Service Parts

Part No. 59071-98

Date 11/97

## Mud Flap

sp59071-98a

### NOTE

Illustration shows a generic styled mud flap.

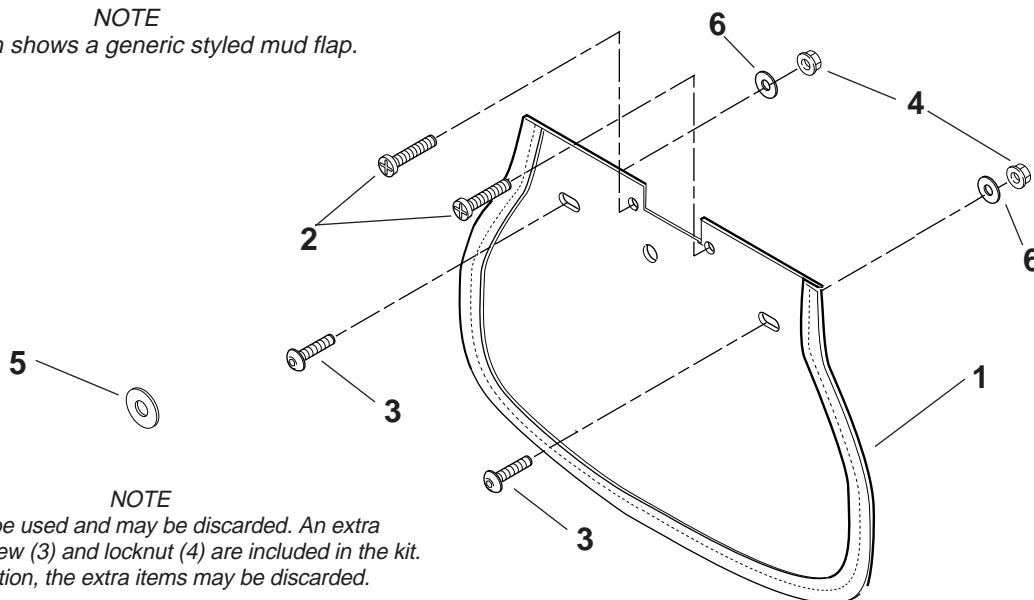

### NOTE

Item 5 will not be used and may be discarded. An extra buttonhead screw (3) and locknut (4) are included in the kit. After kit installation, the extra items may be discarded.

Item	Description	Part No.	Item	Description	Part No.
1	Mud flap	not sold separately	4	Nylon insert locknuts (3) (One of the locknuts may be discarded)	7626W
2	Pan head screws (2)	2449	5	#10 fender washer Item 5 will not be used and may be discarded	6831
3	Button head screws (3) (One of the buttonhead screws may be discarded)	94034-97	6	#10 flat washers (2)	6716

