



# INSTRUCTIONS

-J00330

REV. 1-11-02

Kit Numbers 58830-88, 58830-88DH, 58830-88HE, 58830-88HP, 58830-90JA, 58830-90JC, 58830-92DB, 58830-92PA, 58830-92PD, 58830-93MB, 58830-93LS, 58830-93LV, 58830-94LF, 58830-94MC, 58830-96MR, 58830-96CX, 58830-96PY, 58835-88, 58871-90AV, and 58878-91DA

## FLHT FAIRING LOWERS

### General

These kits are designed for installation on 1983 and later FLHT and FLHTC model motorcycles.

#### NOTE

Mounting this kit on 1984 – 1987 models requires drilling a hole in the left side lower for engine guard filler valve clearance.

#### WARNING

Increased visibility is an important consideration for motorcycle riders. If you install these fairing lowers on an Electra Glide (FLHT) or a Road King (FLHR) the front reflectors may be hidden. To help prevent potential injury because of a lack of visibility, install front bumper reflectors (included with kit) onto these vehicles. Failure to follow instructions could result in death or serious injury.

QTY	DESCRIPTION
1	Cap, fairing lower, left
1	Cap, fairing lower, right
1	Fairing lower, left
1	Fairing lower, right
1	Mounting hardware kit
2	Reflectors, front fender

### Installation

1. See Figure 1. Place fairing lower (1) in position in engine guard space.
2. From hardware kit obtain U-bolt (2), U-bolt retainer (3) and two 1/4-20 locknuts (4). Clamp fairing lower to top of engine guard with U-bolt from back of lower through holes provided at top of fairing lower. Place retainer in position on U-bolt and secure to engine guard with two locknuts. Tighten locknuts with fingers.
3. Secure bottom of fairing to engine guard with round clamp (5) from hardware kit. Position clamp around engine guard with tabs toward rear of vehicle and flat side of clamp against fairing lower. Place 5/16-18 x 1-1/4 in. screw (6) through fairing lower, rubber washer (7) and clamp (5). Secure assembly with flanged locknut (8). Tighten to 12 ft-lbs (16.3 Nm).
4. Tighten U-bolt nuts (4) to 6 ft-lbs (8.1 Nm).
5. Insert crimp nuts (9) into holes provided above and below engine guard at top of fairing lower. (NOTE: Some fairing lowers may already have crimp nuts in place.)

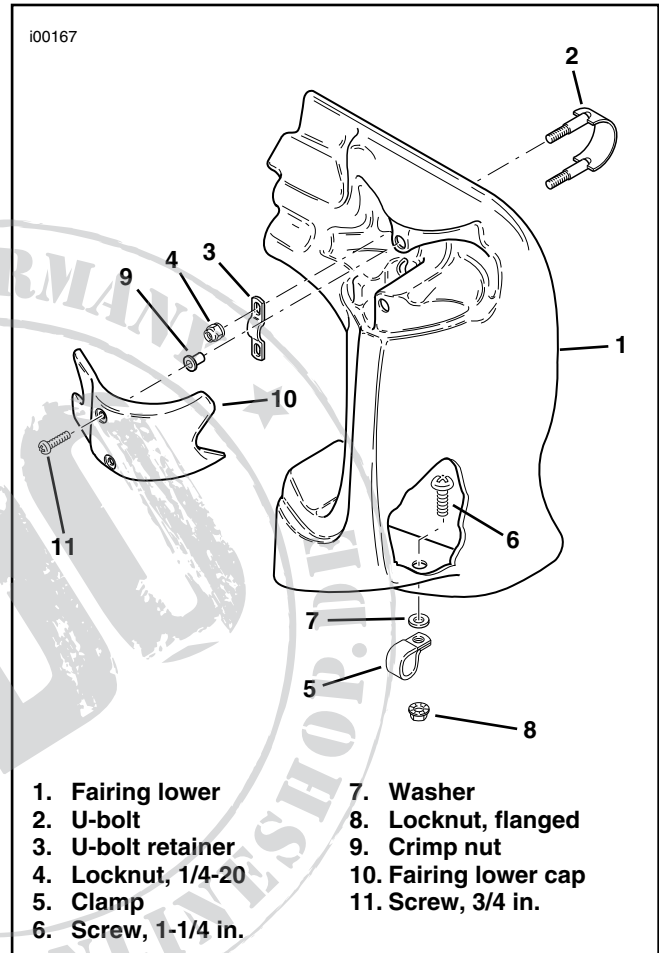

Figure 1. Fairing Lower Assembly - Left View

6. Attach appropriate fairing lower cap (10) to assembly with #6-32 x 3/4 in. screws (11). Tighten securely.

#### CAUTION

Do not press reflector firmly into place until you have it positioned in desired location. The adhesive is very strong and once it comes in contact with a surface, it will be difficult to remove without damaging the reflector.

7. Peel adhesive strip off back of reflector from kit. Position reflector on side of front fender above chrome side trim strip and approximately 4 in. rearward from front of fender. Press reflector securely into place.
8. Repeat Steps 1 through 7 for opposite side of vehicle.