



# INSTRUCTIONS

-J00893

REV. 5-15-01

Kit Number 57846-01

## FLTR FAIRING BRA

### General

This kit is designed for use on 1998 and later FLTR Models.

#### NOTE

A Service Manual for your model motorcycle is available from your Harley-Davidson Dealer.

### Installation

#### CAUTION

When performing the following procedures, be careful not to scratch painted surfaces (fender, fairing, etc.) with metal tabs on the fairing bra.

#### NOTE

Wash and wax the fairing prior to installation of a fairing bra.

1. See Figure 1. Remove screws (1), washers (2) and well nuts (3) holding the windshield (4). Lay the fairing bra (14) over the fairing with holes in the bra (15) over holes in the fairing (16). Replace well nuts, washers and screws through the fairing and tighten.
2. Remove the headlight cover (13). Place loops (17) from the fairing bra over tabs on the headlight cover and reinstall the cover.
3. Remove both nuts (8) and the plate (9) holding the fairing to the engine guard mount (10). Position the bra holes (19) over the studs (11), replace the plate (9), and retighten the nuts (8). Repeat on the other side.
4. Loosen the screws holding the inner and outer fairing halves. Slide chrome clips (20) between the fairing halves and retighten the screws.

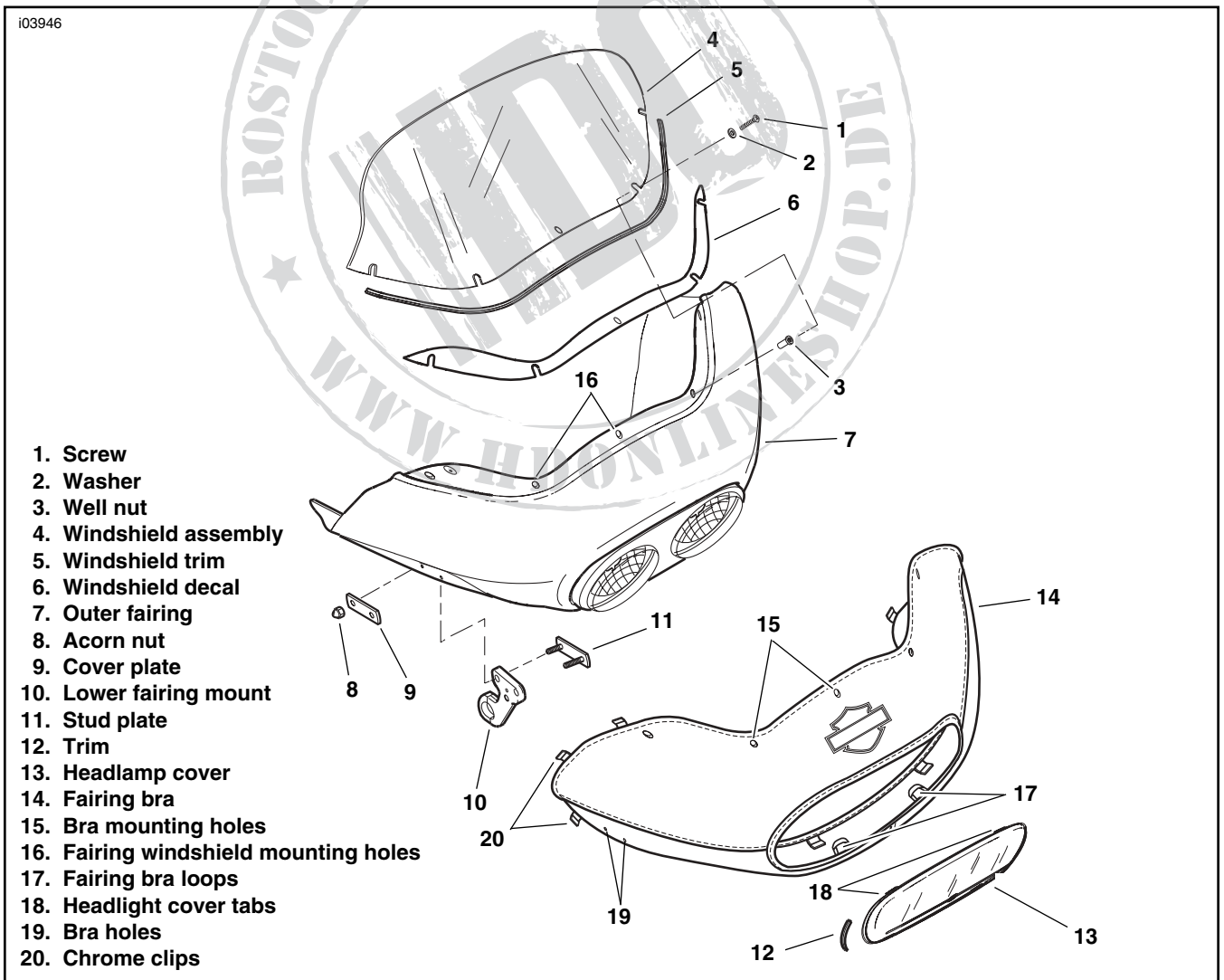

Figure 1. Installation of the Fairing Bra