



INSTRUCTIONS

-J02680

REV. 2006-08-08

SADDLEBAG LID COVER KIT

GENERAL

Kit Number

57805-03A

Models

This kit does not fit FLHRCI (Road King Classic) or Police models. Saddlebag Lid Covers are not compatible with Saddlebag Lid Rails or Saddlebag Lid Spoiler Kit.

For the most up-to-date model fitment information, please see the product label or www.harley-davidson.com.

NOTE

A Service Manual for your model motorcycle is available from a Harley-Davidson Dealer.

Kit Contents

Table 1. Kit Contents

Description (Quantity)	Part Number
Cover, saddlebag lid (right)	Not Sold Separately
Cover, saddlebag lid (left)	Not Sold Separately
Hook and loop fastener, 4 inch (102 mm) (10)	Not Sold Separately
Hook and loop fastener, 6 inch (152 mm) (4)	Not Sold Separately
Hook and loop fastener, 1.5 inch (38 mm) (4)	Not Sold Separately
Alcohol prep pad (2)	Not Sold Separately

There are no Service Parts available with this kit.

INSTALLATION

NOTE

To avoid failure, the fastening tab adhesive must be allowed to cure for 24 hours before installing these Lid Covers.

NOTE

Lid Cover installation may be easier with the saddlebags removed from the motorcycle.

1. See Figure 1. Open the saddlebag lid. Remove the two T-20 TORX® screws (5) attaching the check strap (3) to the lid.

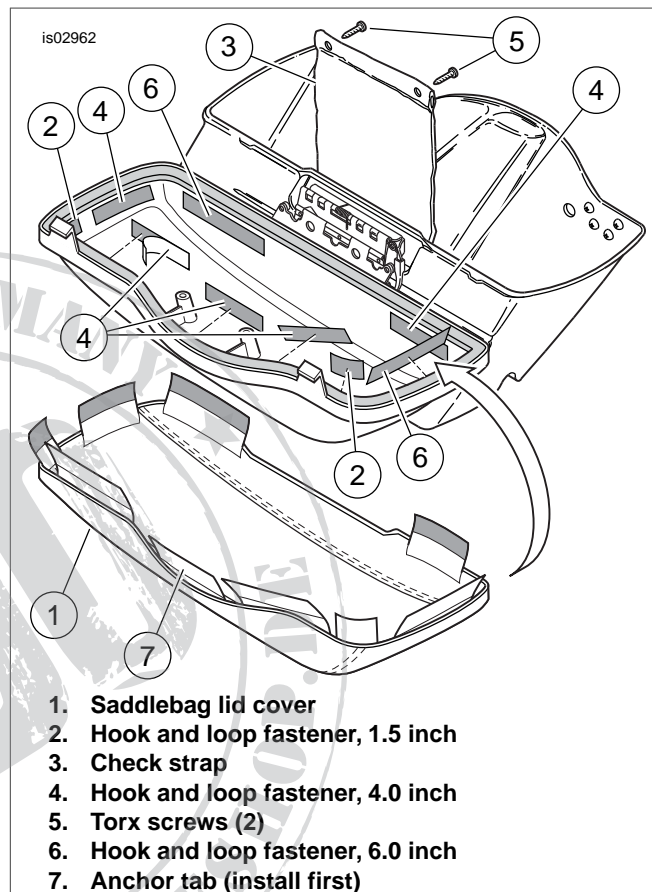

Figure 1. Saddlebag Lid Cover Installation

2. Wash the entire saddlebag lid, inside and out, with warm, soapy water. Rinse and dry thoroughly.
3. Use the alcohol prep pad provided in the kit to further clean the inside of the lid in the areas where the hook and loop strips will be attached.

NOTE

The Saddlebag Lid Covers are side-specific. A Bar-and-Shield logo is stitched into the rear face of each cover.

NOTE

DO NOT fasten the Saddlebag Lid Cover tabs to the hook and loop strips until the adhesive has cured for 24 hours.

4. Place the correct Saddlebag Lid Cover (1) over the saddlebag lid in its proper position. Bring the cover tabs over the edge of the lid to serve as a guide in positioning the hook and loop strips on the inside of the lid. Remove the protective backing from one hook and loop strip at a time. Use the corresponding tab on the cover only as a positioning guide, then fold it back out of the

way. Press the hook and loop strip firmly into place on the inside of the lid as follows:

- One 6-inch (152 mm) long strip (6) at the front of the lid.
- One 6-inch long strip on the outboard side of the lid, between the hinge and the rear surface.
- One 4-inch (102 mm) long strip (4) on the outboard side of the lid, between the hinge and the front surface.
- One 4-inch long strip at the rear of the lid, toward the hinge side.
- Three 4-inch long strips on the inboard (anchor tab) side of the lid.
- Two 1.5-inch (38 mm) long pieces (2) at the front and rear inboard (anchor tab) corners of the lid.

5. Repeat Steps 1 through 4 for the opposite saddlebag.
6. Set the saddlebags aside and allow the adhesive to cure for 24 hours before installing the Saddlebag Lid Covers.
7. Saddlebag Lid Covers are side-specific. After checking that the Velcro strips are firmly attached, place the correct Saddlebag Lid Cover (1) over the saddlebag lid in its proper position.

Bring the cover tabs over the edge of the lid and, starting with the center tab (7) on the inboard (anchor tab) side of the lid, work around the cover in both directions, ending at the hinge.

Pull the lid cover so the hem is even with the bottom of the saddlebag lid all around. Adjust the hook and loop tabs as needed for best appearance.
8. Repeat for the opposite saddlebag.

