



INSTRUCTIONS

-J05947

2014-08-22

WINDSHIELD TRIM MIRROR MOUNT KIT

GENERAL

Kit Number

57400254

Models

For model fitment information, see the P&A retail catalog or the Parts and Accessories section of www.harley-davidson.com (English only).

Installation Requirements

Separate purchase of a Windshield Trim Mirror Kit (Part No. 56000091) is required for proper installation of this kit.

FLHX, FLHXS, FLHXSE Models only: Separate purchase of a Fairing Plug Kit (Part No. 57300063) is required for proper installation of this kit.

Kit Contents

See Figure 2 and Table 1.

INSTALLATION

1. Remove the original equipment (OE) mirrors. See the service manual. **FLHX, FLHXS, FLHXSE Models only:** Install the Fairing Plug Kit (Part No. 57300063, purchased separately) per the instructions in **that** kit.

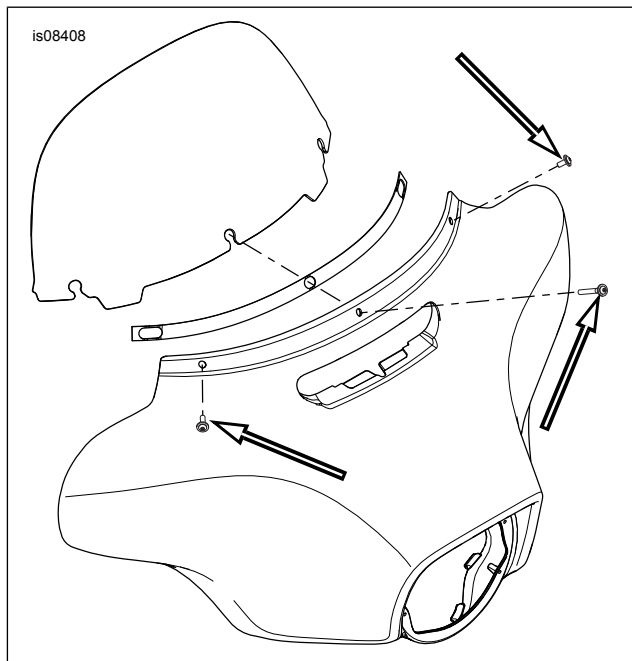

Figure 1. Remove and Discard Screws

2. See Figure 1. Remove and discard the three original equipment (OE) outer fairing/windshield screws. Remove windshield lower trim or molding, if present.

3. See Figure 2. Get the windshield trim base (1) and mirror supports (2, 3) from the kit.
4. Insert mirror supports into trim base.
 - a. Position bottom edge of one support into correct-side bottom flange of trim base.
 - b. Snap top edge of support into top flange.
 - c. Make sure that support is fully seated in the trim base.
 - d. Repeat on the opposite side.
5. Insert the long screw (4) through the windshield trim base center hole. Slide the thick spacer (5) onto the screw threads, conical side first. Slide the spacer all the way to the trim base.
6. Insert a short screw (6) through each windshield trim base end hole and mirror support hole. Slide a thin spacer (7) onto the threads of each screw. Leave the spacer close to the screw tip.
7. Mount the assembly to the vehicle.
 - a. Thread in the center screw part way.
 - b. Thread in the outer screws part way.
 - c. Alternately tighten the screws to 2.8–3.4 N·m (25–30 in-lbs).
8. Install the mirrors per the instructions in **that** kit.

-J05947



Many Harley-Davidson® Parts & Accessories are made of plastics and metals which can be recycled. Please dispose of materials responsibly.

1 / 2

SERVICE PARTS

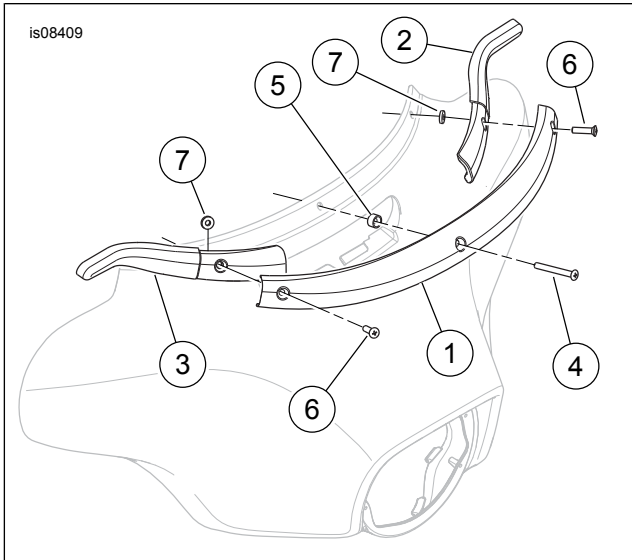

Figure 2. Service Parts, Windshield Trim Mirror Mount Kit

Table 1. Service Parts

Item	Description (Quantity)	Part Number
1	Mounting base, windshield trim mirror	Not sold separately
2	Mirror support (left)	Not sold separately
3	Mirror support (right)	Not sold separately
4	Screw, oval head Phillips, 1/4-20 x 57 mm (2.25 in) long	10500050
5	Spacer, windshield trim (thick)	12400105
6	Screw, oval head Phillips (2) 1/4-20 x 25.4 mm (1.0 in) long	10200341
7	Spacer, windshield trim (thin) (2)	12400106