



INSTRUCTIONS

-J04120

REV. 2006-05-30

DETACHABLE WINDSHIELD KITS

GENERAL

Kit Number

57331-07

Models

This kit fits 2007 FXDSE or Softail models with the Parts and Accessories Inverted Front Fork Kit, Part Number 46321-05, 46321-05A or 48646-06.

Kit Contents

See Figure 3 and Table 1.

INSTALLATION

WARNING

The rider's safety depends upon the correct installation of this kit. If the procedure is not within your capabilities or you do not have the correct tools, have a Harley-Davidson dealer perform the installation. Improper installation of this kit could result in death or serious injury. (00308a)

NOTE

Cover front fender and front of fuel tank with clean shop towels to prevent scratching. Damage to the finish could result.

Assemble Clamps to Windshield

1. See Figure 1. Remove windshield sub-assembly from packaging and place face down on a clean, soft surface with mount brackets facing upward.
2. See Figure 2. The windshield will require 4 clamps, the upper two mount locations are slotted in the windshield brackets and the lower two are thru holes. Separate the 4 clamps, shoulder bolts, cup washers, and Belleville washer hardware from their packaging.
3. See Figure 2. Take one shoulder bolt and one belleville washer and orient the belleville washer on the shoulder so the cupped side of the washer is facing away from the bolt head.

WARNING

The cupped side of the Belleville (cone) washers must face each other and sandwich the windshield mount brackets at each mount point. Failure to orient washers correctly can reduce windshield's ability to break away in a collision, which could result in death or serious injury. (00422b)

4. Insert the bolt washer through one of the bracket holes from the inside, center-line of the shield with threads pointing outward.

5. Using another belleville washer and the machined cup-spacer orient the belleville washer again with the "cupped" side of the washer facing the windshield bracket sandwiching it and the cup spacer's cup side facing the belleville washer. The complete stack of components is shown in Figure 2 and should be assembled as shoulder bolt, belleville washer, bracket, belleville washer, cup spacer, and clamp.
6. Using a 1/4 inch allen wrench, thread the shoulder bolt into one of the clamps with the jaws of the clamp facing upward. Tighten shoulder bolt so clamp will remain secure when handled.
7. Assemble second hardware stack complete (orient the belleville washer again with the "cupped" side of the washer facing the windshield bracket sandwiching it and the cup spacer's cup side facing the belleville washer) as shown in Figure 2 and loosely thread shoulder bolt into clamp. Keep loose enough to spread Belleville washers apart to the width of the bracket.
8. Slip the spread belleville washers to each side of the slot on the same windshield bracket and insert the shoulder portion of the bolt all the way to the depth of the slot. Tighten shoulder bolt so clamp will remain secure when handled.
9. Repeat the above installation procedures for the opposite bracket clamp positions.

NOTE

Prior to installing the windshield on the motorcycle the top and bottom clamps must be aligned.

10. Using a straight edge placed between the upper clamps along the face of the rubber clamp gasket, align the clamps and tighten shoulder bolts to 60 **in-lbs** (6.8 Nm). Repeat alignment procedure for lower clamps and tighten to 60 **in-lbs** (6.8 Nm).

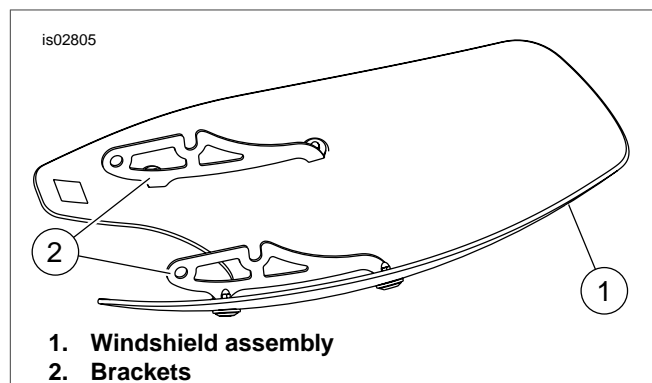

Figure 1. Windshield Mounting Brackets

NOTE

Clamps can be rotated a small amount after torquing the shoulder bolt to help final clamp alignment.

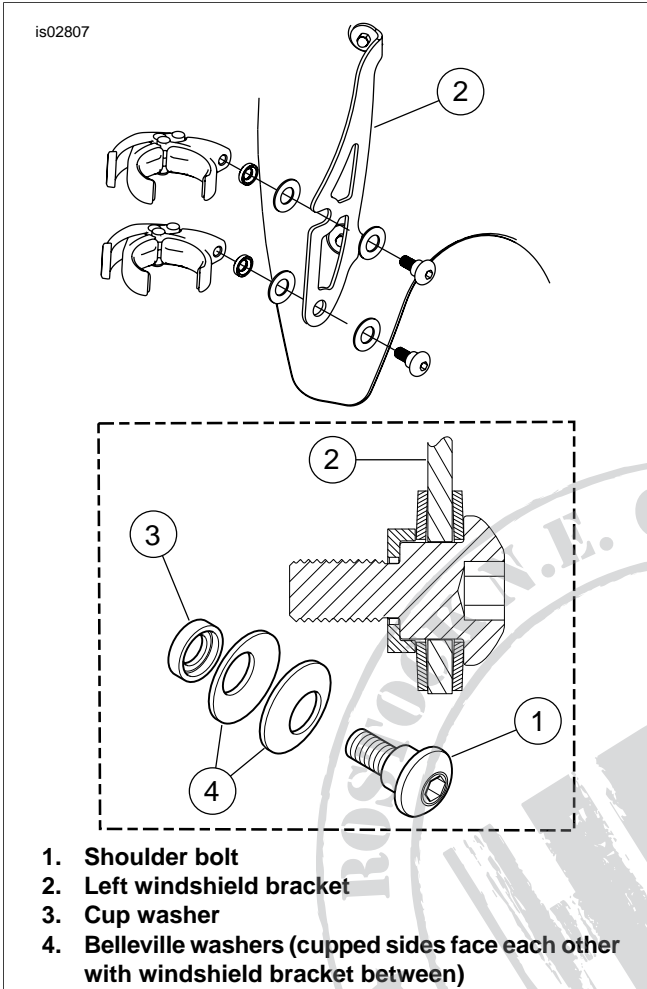

Figure 2. Windshield Mounting Clamp

Install Windshield

NOTE

Keep front wheel straight to prevent brackets from scratching fuel tank.

1. Make sure all four clamps are in the "open" position, then bring windshield (with clamp side away from you) to front of bike.

NOTE

Take care not to scratch the headlamp housing with the clamps while positioning the windshield to the fork sliders.

2. Straddle front fender and center windshield around the headlamp and seat clamps onto fork sliders.
3. Starting at the bottom of either side, close each clamp.

NOTE

If interference occurs, adjust windshield as needed until proper clearance is obtained. Have experienced Harley-Davidson

service personnel correct any problems before riding with this accessory installed.

Remove and Store Windshield

To remove windshield, open four clamps, in any sequence, and remove windshield. Take care to not scratch headlamp housing or fuel tank as noted during installation.

When storing windshield, place in a location where windshield clamps will receive the greatest protection. Keep from locations where the windshield may be bumped or dropped. Do not stack anything on top of assembly.

Prior to re-installation after any storage period, inspect clamps and hardware for fastener preload and cleanliness. Ensure each clamp can be cycled open and closed freely and is free of any debris.

CARE AND CLEANING

NOTE

Sunlight reflections off inside surface of windshield can cause extreme heat build-up on motorcycle instruments. Exercise care in parking. Park facing the sun, place an opaque object over instruments, or adjust windshield to avoid reflections.

CAUTION

Harley-Davidson windshields are made of Lexan. Lexan is a more durable and distortion-resistant material than other types of motorcycle windshield material, but still requires attention and care to maintain. Failure to maintain Lexan properly can result in damage to the windshield. (00230a)

- Do not clean Lexan® polycarbonate in hot sun or high temperature. Powdered, abrasive, or alkaline cleanser will damage windshield. Never scrape windshield with a razor blade or other sharp instruments because permanent damage will result.

CAUTION

Do not use harsh chemicals including rain sheeting products on Harley-Davidson windshields. They can cause dulling or hazing. If you want to use a windshield protectant on your windshield, try Harley Glaze Polish and Sealant (00231a)

CAUTION

Do not use benzene, paint thinner, gasoline or any other type of harsh cleaner on the windshield. Doing so will damage the windshield surface. (00232a)

- Do not use benzene, paint thinner, gasoline, lubricants (including Armorall®), or other cleaning agents on rubber bushings or rubber clamp gaskets. They will damage the rubber surfaces.

NOTE

Covering the windshield with a clean, wet cloth for about 15 minutes before washing will make dried bug removal easier.

SERVICE PARTS

is02794

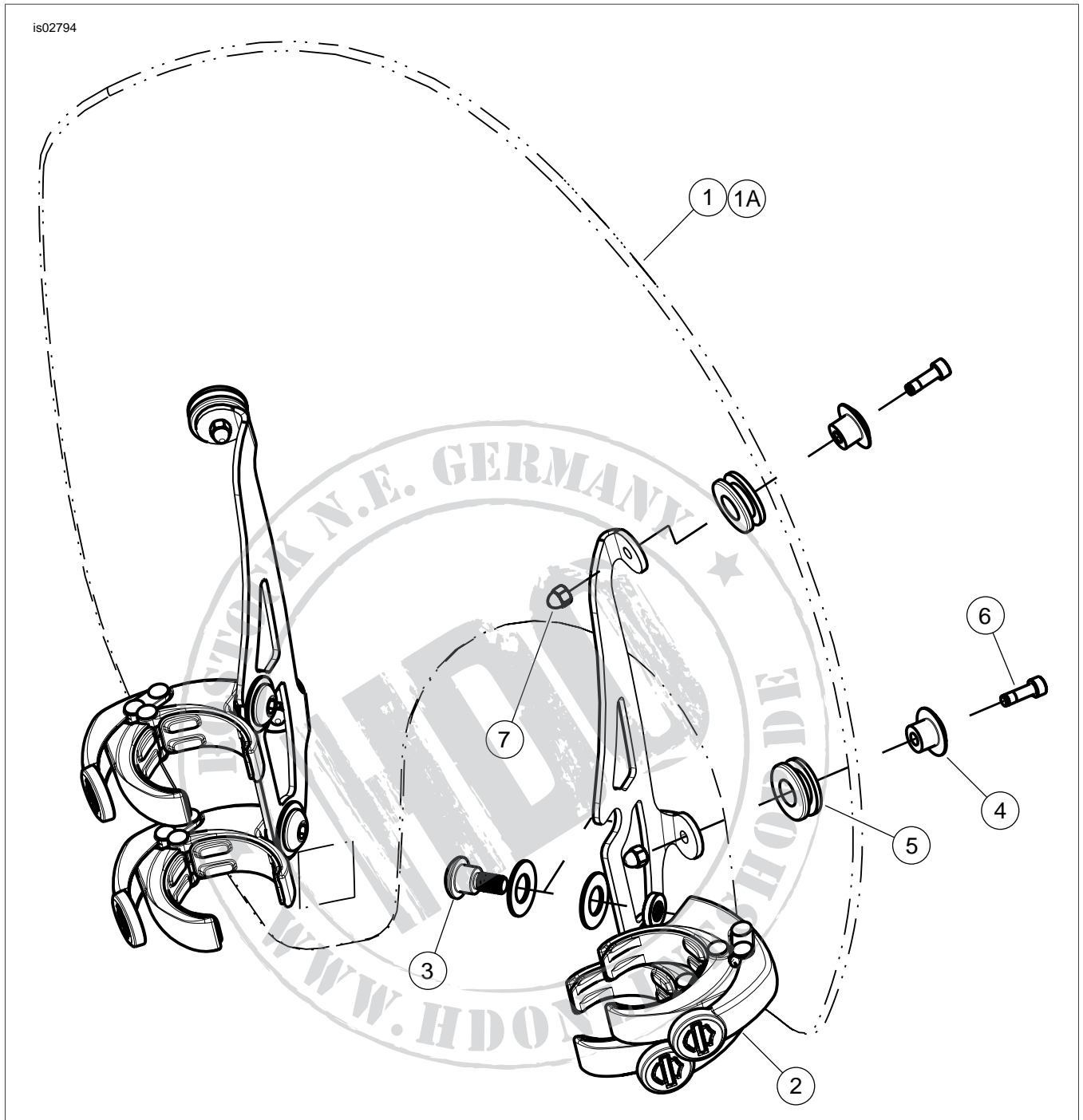

Figure 3. Service Parts: Super Sport Quick-Release Windshield Kit

Table 1. Service Parts Table

Item	Description (Quantity)	Part Number
1	Windshield assembly (includes item 4 thru 7)	Not Sold Separately
1A	Service windshield (replacement)	57332-07
2	52 mm quick clamp assembly (4)	57288-07
3	Mounting hardware kit (4)	58790-04
4	Top mount cap (4)	57818-01
5	Grommet (4)	11564

Table 1. Service Parts Table

Item	Description (Quantity)	Part Number
6	Screw, M5 x 0.8 x 16 mm (4)	3080M
7	Nut, acorn, M5 x 0.8 (4)	7154M

