



# INSTRUCTIONS

-J04317

REV. 2007-08-20

## DETACHABLE WINDSHIELD KITS

### GENERAL

#### Kit Number

57251-08, 57253-08

#### Models

For model fitment information, please see the P&A Retail Catalog or the Parts and Accessories section of [www.harley-davidson.com](http://www.harley-davidson.com) (English only).

#### Kit Contents

See Figure 3 and Table 1.

### INSTALLATION

#### WARNING

The rider's safety depends upon the correct installation of this kit. If the procedure is not within your capabilities or you do not have the correct tools, have a Harley-Davidson dealer perform the installation. Improper installation of this kit could result in death or serious injury. (00308a)

#### NOTE

Cover front fender and front of fuel tank with clean shop towels to prevent scratching. Damage to the finish could result.

#### Assemble Clamps to Windshield

1. See Figure 1. Remove windshield subassembly from packaging and place face down on a clean, soft surface with mount brackets facing up.

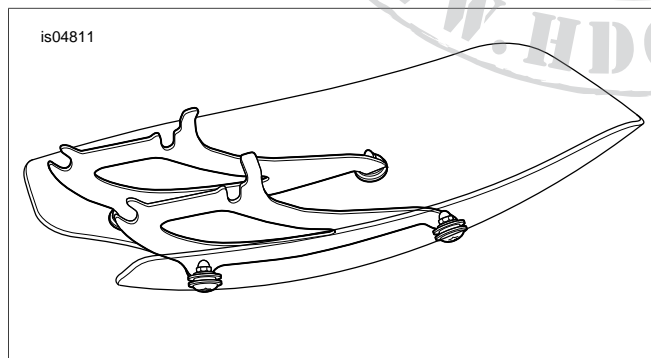

Figure 1. Windshield Subassembly

#### WARNING

The cupped side of the Belleville (cone) washers must face each other and sandwich the windshield mount brackets at each mount point. Failure to orient washers correctly can reduce windshield's ability to break away in a collision, which could result in death or serious injury. (00422b)

2. See Figure 2. Install a belleville washer (4) onto a shoulder bolt (1) orienting the belleville washer on the shoulder so the cupped side of the washer is facing away from the bolt head.
3. Assemble the second belleville washer with the cupped side of the washer facing the shoulder bolt and install the cup spacer with the cup side facing the belleville washer. Loosely thread shoulder bolt into clamp. Keep loose enough to spread belleville washers apart to the width of the bracket.
4. Repeat for the second clamp.
5. Spread the belleville washers and install assembly into one of the slots on the windshield bracket. Ensure the shoulder portion of the bolt is all the way to the depth of the slot. Tighten shoulder bolt so clamp will remain secure when handled.
6. Repeat for the second slot on the windshield bracket.
7. Repeat Steps 2 through 6 for the opposite bracket clamps.
8. Align the clamps by placing a straightedge between the upper clamps along the face of the rubber clamp gasket and tighten shoulder bolts to 60 **in-lbs** (6.8 Nm). Repeat alignment procedure for lower clamps and tighten to 60 **in-lbs** (6.8 Nm).

#### NOTE

Clamps can be rotated a small amount after tightening the shoulder bolt to help final clamp alignment.

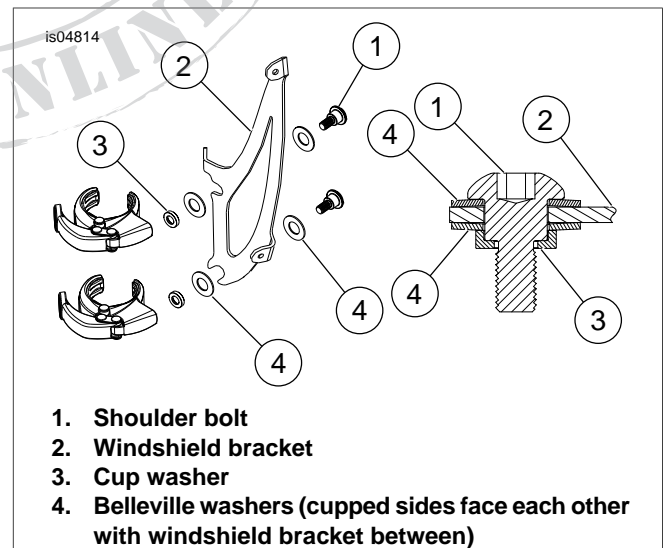

1. Shoulder bolt
2. Windshield bracket
3. Cup washer
4. Belleville washers (cupped sides face each other with windshield bracket between)

Figure 2. Windshield Mounting Clamp

## Install Windshield

### NOTES

*Prior to installing the windshield on the motorcycle, the top and bottom clamps must be aligned.*

*Keep front wheel straight to prevent brackets from scratching fuel tank.*

1. Make sure all four clamps are in the open position, then bring windshield (with clamp side away from you) to front of bike.

### NOTE

*Take care not to scratch the headlamp housing with the clamps while positioning the windshield to the fork sliders.*

2. Straddle front fender and center windshield around the headlamp and seat clamps onto fork sliders.
3. Close each clamp starting at the bottom.

### NOTE

*If interference occurs, adjust windshield as needed until proper clearance is obtained. Have experienced Harley-Davidson service personnel correct any problems before riding with this accessory installed.*

## Remove and Store Windshield

Remove windshield: Open the clamps in any sequence and remove windshield. Take care to not scratch headlamp housing or fuel tank as noted during installation.

Storing windshield: Store in a location where windshield clamps will receive the greatest protection. Keep from locations where the windshield may be bumped or dropped. Do not stack anything on top of windshield assembly.

Prior to re-installation after any storage period: Inspect clamps and hardware for fastener preload and cleanliness. Ensure

each clamp can be cycled open and closed freely and is free of any debris.

## CARE AND CLEANING

### NOTE

*Sunlight reflections off inside surface of windshield can cause extreme heat build-up on motorcycle instruments. Exercise care in parking. Park facing the sun, place an opaque object over instruments, or adjust windshield to avoid reflections.*

### CAUTION

**Polycarbonate windscreens/windshields require proper attention and care to maintain. Failure to maintain polycarbonate properly can result in damage to the windscreen/windshield. (00483d)**

- Do not clean polycarbonate in hot sun or high temperature.
- Powdered, abrasive, or alkaline cleanser will damage windshield.
- Do not use benzene, paint thinner, gasoline or any other type of harsh cleaner on the windshield. Doing so will damage the surface.

### CAUTION

**Do not use harsh chemicals including rain sheeting products on Harley-Davidson windshields. They can cause dulling or hazing. If you want to use a windshield protectant on your windshield, try Harley Glaze Polish and Sealant (00231a)**

### NOTE

*Covering the windshield with a clean, wet cloth for about 15 minutes before washing will make dried bug removal easier.*

# SERVICE PARTS

is04813

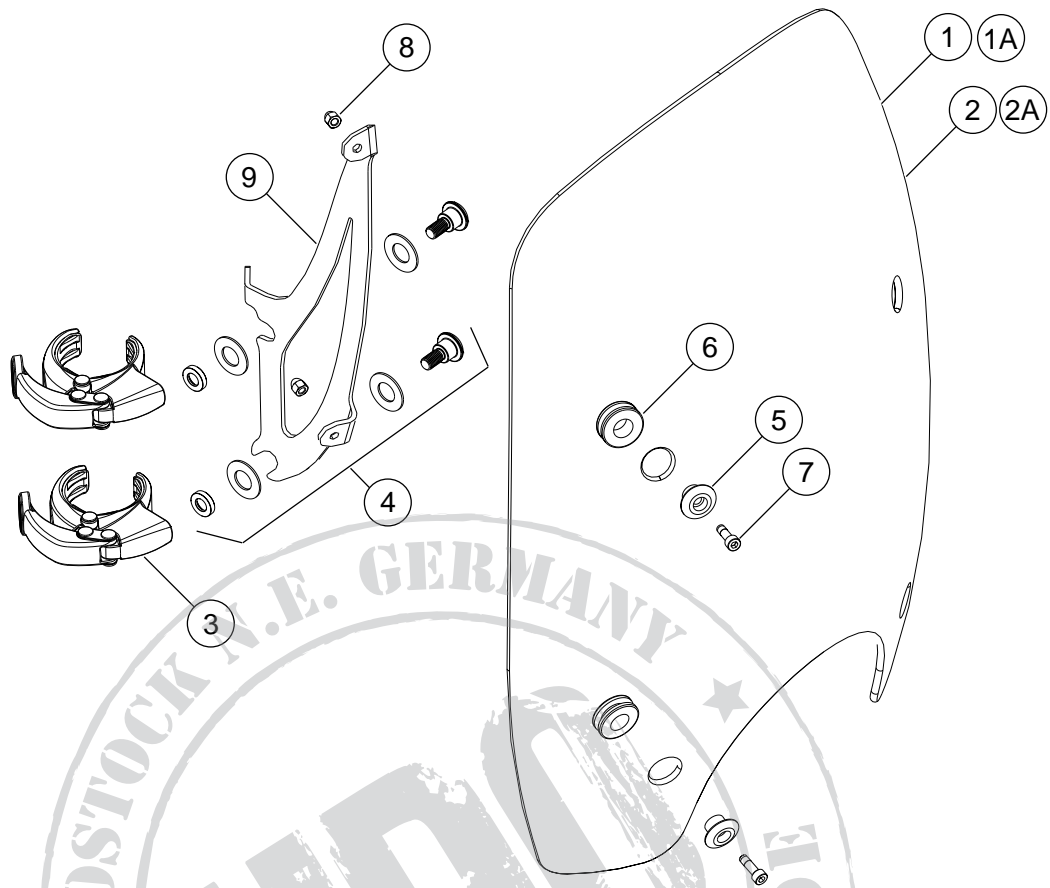

**Figure 3. Service Parts: Detachable Windshield Kits**

**Table 1. Service Parts Table**

Item	Description (Quantity)	Part Number
1	Windshield assembly, standard height (includes items 3 through 9)	Not Sold Separately
1A	Service windshield, standard height (replacement) (includes item 6)	57366-08
2	Windshield assembly, low profile (includes items 3 through 9)	Not Sold Separately
2A	Service windshield, low profile (replacement) (includes item 6)	57367-08
3	49 mm quick clamp assembly (4)	57289-07
4	Mounting hardware kit (4)	58790-04
5	Top mount cap (4)	57818-01
6	Grommet (4)	11564
7	Screw, M5 x 0.8 x 16 mm (4)	3080M
8	Nut, acorn, M5 x 0.8 (4)	7154M
9	Bracket, windshield mounting, standard right	57365-08
	Bracket, windshield mounting, standard left (not shown)	57364-08
	Bracket, windshield mounting, low profile right (not shown)	57258-08
	Bracket, windshield mounting, low profile left (not shown)	57257-08