



# INSTRUCTIONS

-J05026

REV. 2009-09-24

## ONE-PIECE FAT HANDLEBAR RISER KITS

### GENERAL

#### Kit Numbers

56929-10, 56931-10

#### Models

For model fitment information, see the P&A retail catalog or the Parts and Accessories section of [www.harley-davidson.com](http://www.harley-davidson.com) (English only).

#### Additional Parts Required

Proper installation of this kit requires the prior or concurrent installation of an appropriate Harley-Davidson 1-1/4 inch (31.75 mm) (fat) handlebar kit. Contact a Harley-Davidson dealer to determine which kits will fit your model motorcycle.

Proper installation of this kit may require longer cables, brake lines or wires. Contact a Harley-Davidson dealer to determine if your application requires additional components.

#### WARNING

**The rider's safety depends upon the correct installation of this kit. Use the appropriate service manual procedures. If the procedure is not within your capabilities or you do not have the correct tools, have a Harley-Davidson dealer perform the installation. Improper installation of this kit could result in death or serious injury. (00333a)**

#### NOTE

*This instruction sheet refers to service manual information. A service manual for this year/model motorcycle is required for this installation and is available from a Harley-Davidson dealer.*

#### Kit Contents

See Figure 1 and Table 1.

### REMOVAL

#### NOTE

*Cover the front fender and fuel tank with an H-D Service Cover or clean shop towel to prevent scratching the finish.*

**If replacing the handlebar**, refer to the service manual to remove the controls and other components, and the handlebar and risers.

**If replacing only the risers**, proceed as follows:

1. Remove four screws and the riser clamp (or caps) from the risers. Carefully rest the handlebar with attached controls on the protected fuel tank.
2. See Figure 1. Remove two riser mounting screws (I) from under the upper fork bracket. Remove the risers and hardware (A through H). Note the sequence and orientation of the hardware as it is removed and retain it for later installation.

Discard the original equipment (OE) risers and riser clamp (or caps).

### INSTALLATION

#### NOTE

*The upper cup washer (A) must be oriented with the flat side **up**, and the lower cup washer (D) with the flat side **down**.*

*The ground wire (G) and internal tooth lockwasher (H) are mounted to the **right-side** riser leg.*

1. Align the components as shown, and install the riser (2) to the upper fork bracket. Do not fully tighten the riser mounting screws (I) at this time.
2. Install the **1-1/4 inch (31.75 mm)** (fat) handlebar assembly onto the riser. If a **new** handlebar is being installed, assemble and install it according to the instructions included with **that** kit.
3. Install the riser clamp (1) onto the handlebar and riser using four socket head screws (3) and washers (4) as shown. Snug the upper screws, but do not fully tighten.
4. Tighten the riser mounting screws (I) to 50-60 ft-lbs (68-81 Nm).

#### WARNING

**Be sure handlebar risers are firmly locked into desired position before operating motorcycle. Movement of the handlebar can distract the rider and lead to loss of control, which could result in death or serious injury. (00394d)**

#### CAUTION

**Improperly aligned handlebars can contact the fuel tank when turned to the left or right. Contact with the fuel tank can cause cosmetic damage. (00372a)**

5. Adjust the handlebar to the desired position, and verify that the handlebar is centered on the riser.  
Slowly turn the front wheel to the full right fork stop and then the full left fork stop to be sure the handlebar does not contact the fuel tank or tank console. If contact occurs and the handlebars are properly centered, raise the handlebar angle as necessary until proper clearance is attained.
6. Tighten the upper handlebar clamp screws as follows:
  - a. Tighten the front screws to 15-18 ft-lbs (20.3-24.4 Nm).
  - b. Tighten the rear screws to 15-18 ft-lbs (20.3-24.4 Nm).
  - c. Tighten the front screws to 15-18 ft-lbs (20.3-24.4 Nm).

NOTE

The gap between the upper clamp and the riser should be approximately equal at the front and rear of the handlebar after tightening.

**WARNING**

Be sure that steering is smooth and free without interference. Interference with steering could result in loss of vehicle control and death or serious injury. (00371a)

- Be sure the steering stops function properly.
- Be sure throttle/idle and clutch control cables do not pull tight when handlebars are turned fully to left or right fork stops.
- Be sure throttle returns from full open to close at both fork stops.
- Be sure wires, cables and brake lines are not pinched between the frame and forks.

**WARNING**

Install proper length brake lines. Incorrect brake line length can adversely affect motorcycle operation, which could cause loss of control resulting in death or serious injury. (00325a)

- If you are installing different handlebars, measure the change in distance that will be required from the end of the OE brake line to the brake master cylinder.
- If the line is more than 2.0 in (50.8 mm) longer, or more than 1.0 in (25.4 mm) shorter than the above measured distance, see a Harley-Davidson dealer for the correct length brake line.

SERVICE PARTS

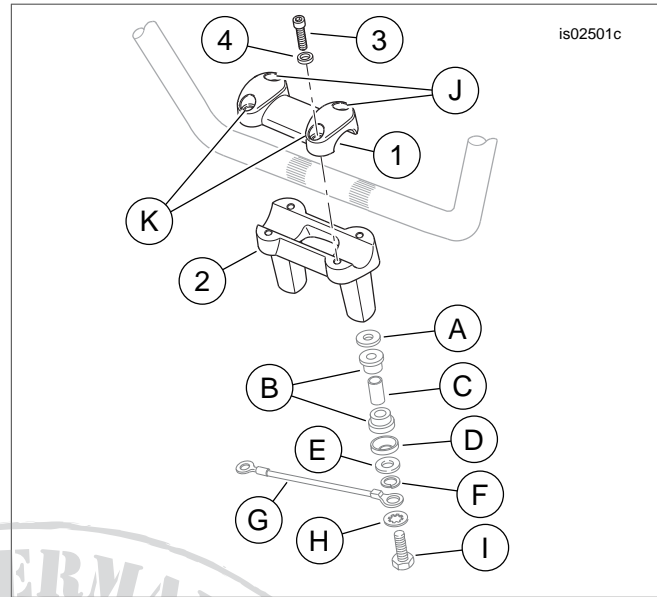

Figure 1. Service Parts, One-Piece Fat Handlebar Riser Kits

Table 1. Service Parts

Item	Description (Quantity)	Part Number
1	Clamp, fat handlebar upper	Not sold separately
2	Riser, fat handlebar	Not sold separately
3	Cap screw, hex socket head (silver) (4, for Kit 56929-10) Cap screw, hex socket head (black) (4, for Kit 56931-10)	3210A 3153
4	Washer (silver) (4, for Kit 56929-10) Washer (black) (4, for Kit 56931-10)	12408 12409
<b>Items mentioned in text, but not included in kit.</b>		
A	OE cup washer (upper) (install flat side up) (2)	
B	OE bushing (4)	
C	OE spacer (2)	
D	OE cup washer (lower) (install flat side down) (2)	
E	OE flat washer (2)	
F	OE split lockwasher (2)	
G	OE ground wire	
H	OE internal-tooth lockwasher	
I	OE riser mounting screw (2)	
J	Front clamp screw (2)	
K	Rear clamp screw (2)	