



INSTRUCTIONS

-J04533

2008-07-14

PULLBACK RISER KIT FOR 1.25-INCH HANDLEBARS

GENERAL

Kit Number

56267-09, 56269-09

Models

For model fitment information, see the P&A Retail Catalog or the Parts and Accessories section of www.harley-davidson.com (English only).

Additional Parts Required

Proper installation of this kit requires the prior or concurrent installation of an appropriate Harley-Davidson 1-1/4 inch handlebar kit. Contact a Harley-Davidson dealer to determine which kits will fit your model motorcycle.

For FXSTD Models: Two spacers (6740) are required to install this kit. See your Harley-Davidson Dealer for more information.

Loctite[®] 271 (Red) Threadlocker and Sealant (99671-97) is required for the proper installation of this kit.

Separate purchase and installation of additional parts or accessories may be required for proper installation of this kit on your model motorcycle. See the P&A Retail Catalog or the Parts and Accessories section of www.harley-davidson.com (English only) for a list of required parts or accessories for your model.

▲ WARNING

The rider's safety depends upon the correct installation of this kit. Use the appropriate service manual procedures. If the procedure is not within your capabilities or you do not have the correct tools, have a Harley-Davidson dealer perform the installation. Improper installation of this kit could result in death or serious injury. (00333a)

NOTE

This instruction sheet references service manual information. A service manual for your model motorcycle is required for this installation and is available from a Harley-Davidson Dealer.

Kit Contents

See Figure 3 and Table 1.

REMOVAL

NOTE

Cover the fuel tank with clean shop towels to prevent scratching.

If replacing the handlebar, refer to the service manual to remove controls, hand levers, handlebar and risers.

If only the risers are being replaced, proceed as follows:

1. Remove the two hex head cap screws and split lockwashers on the underside of the upper fork bracket that hold the currently installed risers in place. Discard the screws, but retain the lockwashers for assembly. Retain all additional components from the riser assembly when the screws are removed.
2. Remove and discard the four screws that fasten the currently installed handlebar upper clamp(s) to the risers. Remove and discard the clamp(s). Remove the handlebar from the risers and carefully set the handlebar on the fuel tank.

INSTALLATION

NOTE

See Figure 3. The upper cup washer (A) must be oriented with the flat side up and the lower cup washer (D) with the flat side down.

1. See Figure 3. Align the components as shown, and install the risers (2) to the upper fork bracket. The ground wire (G) and the lock washer (F) are located on the right side only. Do not tighten the riser mounting screws (4) at this time.
2. If an appropriate Harley-Davidson 1-1/4 inch handlebar has not been installed, install one according to the Instruction Sheet included with the kit, or install the handlebar assembly onto the risers.
3. Loosely install riser caps (1) onto the handlebars and risers with the Bar & Shield toward the front of the motorcycle (Figure 1, Item 1). Install four socket head screws (3) with four washers (6).

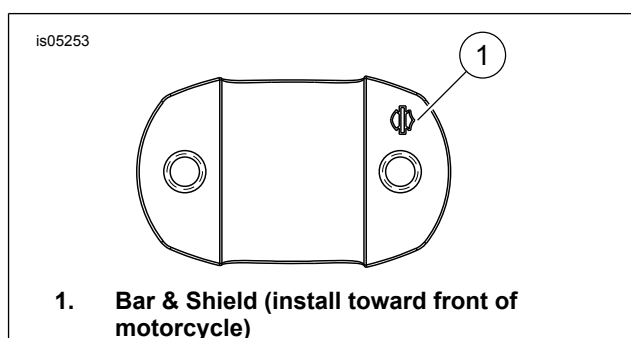

Figure 1. Bar & Shield on Riser and Cap

4. Check that the risers stay properly aligned with the handlebar and tighten the riser mounting screws following the instructions in the service manual.
5. Adjust handlebar to the desired position, verify that it is centered on the risers, then tighten the front socket head screws (3) to 16–20 N·m (12–15 ft-lbs). There should be no gap at the front of the risers.

-J04533



Many Harley-Davidson® Parts & Accessories are made of plastics and metals which can be recycled. Please dispose of materials responsibly.

1 / 3

NOTE

See Figure 2. After tightening, the gaps between the upper clamps and the risers should only be at the rear (2) of the handlebar (1) and between the handlebar and the riser (3). Verify there is no gap between the riser caps and the risers at the front of the handlebar.

- Tighten the rear socket head screws (3) to 16–20 N·m (12–15 ft·lbs). If necessary, use torque adapter (5) and a crow'sfoot. Verify socket head screws are tightened to specified value.

NOTICE

Improperly aligned handlebars or components can contact the fuel tank when turned to the left or right. Contact with the fuel tank can cause cosmetic damage. (00372b)

- Turn the handlebars full right and left. Check that:
 - The handlebars and triple tree clamps do not contact the fuel tank.
 - The steering stops function properly.
 - The wiring and brake line are not pinched or kinked in the steering assembly.
 - Throttle returns from full open to close at both fork stops.
- One at a time, remove the riser screws installed in Step 3. Apply two drops of Loctite® 271 (Red) to the bolt threads and install. Tighten the riser bolts following the instructions in the appropriate Service Manual.

WARNING

Install proper length brake lines. Incorrect brake line length can adversely affect motorcycle operation, which could cause loss of control resulting in death or serious injury. (00325a)

- If you are installing different handlebars, measure the change in distance that will be required from the end of the stock brake line to the brake master cylinder.
- If the line is more than 2.0 in (50.8 mm) longer or more than 1.0 in (25.4 mm) shorter than the above measured distance, see a Harley-Davidson dealer for the correct brake line length.

WARNING

Be sure that steering is smooth and free without interference. Interference with steering could result in loss of vehicle control and death or serious injury. (00371a)

- Be sure wires, clutch cables, throttle/idle cables and brake lines do not pull tight when handlebars are turned fully to left or right fork stops.

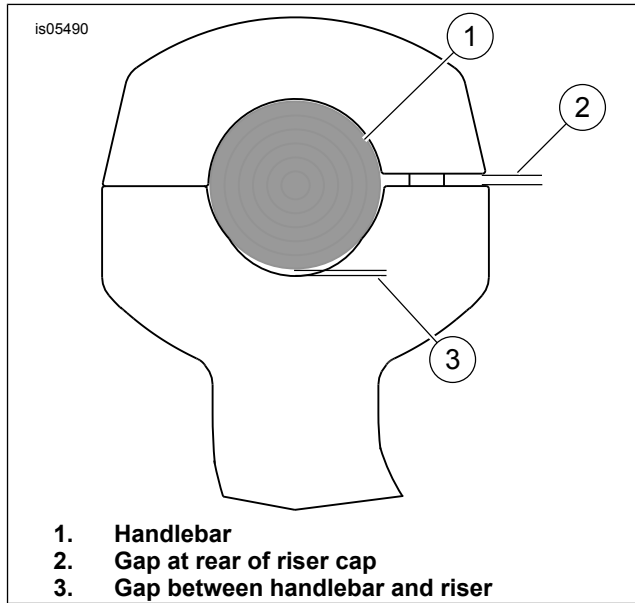

Figure 2. Proper Installation Configuration

SERVICE PARTS

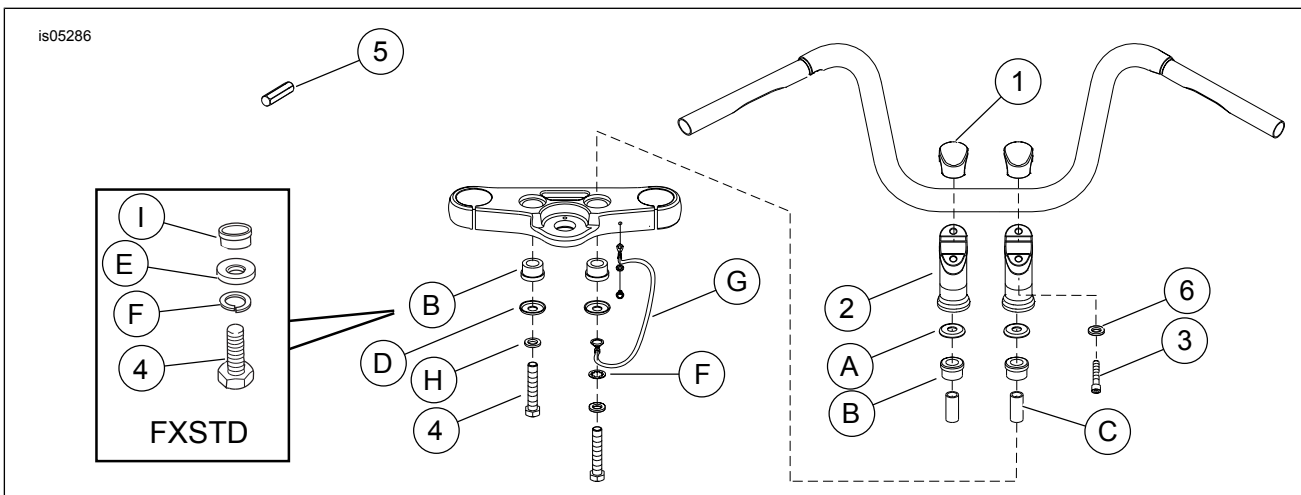

Figure 3. Service Parts: Handlebar Riser Kit (FXDL Shown)

Table 1. Service Parts Table

Item	Description (Quantity)	Part Number
1	Cap, riser (2)	Not Sold Separately
2	Riser (2)	Not Sold Separately
3	Screw, socket hex (4)	94334-91T
4	Screw, hex head (2)	3450
5	Adapter, torque	56282-09
6	Washer (4)	6396

Table 1. Service Parts Table

Item	Description (Quantity)	Part Number
Items mentioned in text, but not included in kit:		
A	Cup washer (upper) (flat side up) (2)	
B	Bushing (2)	
C	Spacer (2)	
D	Cup washer (lower) (flat side down) (2)	
E	Washer (2)	
F	Lock washer	
G	Ground wire	
H	Internal tooth lock washer (2)	
I	Spacer (2) (FXSTD models - purchased separately)	