



INSTRUCTIONS

-J01213

REV. 2008-05-15

TALL RISER KITS FOR 1-INCH HANDLEBARS

GENERAL

Kit Number

56223-98, 56266-09

Models

For model fitment information, please see the P&A Retail Catalog or the Parts and Accessories section of www.harley-davidson.com (English only).

Additional Parts Required

Proper installation of this kit requires the prior or concurrent installation of an appropriate Harley-Davidson 1-inch handlebar kit. Contact a Harley-Davidson dealer to determine which kits will fit your model motorcycle.

For FXSTD Models: Two spacers (part number 6740) are required to install this kit. See your Harley-Davidson Dealer for more information.

Loctite® 271 (Red) Threadlocker and Sealant (H-D Part Number 99671-97) is required for the proper installation of this kit.

Separate purchase and installation of additional parts or accessories may be required for proper installation of this kit on your model motorcycle. Please see the P&A Retail Catalog or the Parts and Accessories section of www.harley-davidson.com (English only) for a list of required parts or accessories for your model.

WARNING

The rider's safety depends upon the correct installation of this kit. Use the appropriate service manual procedures. If the procedure is not within your capabilities or you do not have the correct tools, have a Harley-Davidson dealer perform the installation. Improper installation of this kit could result in death or serious injury. (00333a)

NOTE

This instruction sheet references service manual information. A service manual for your model motorcycle is required for this installation and is available from a Harley-Davidson Dealer.

Kit Contents

See Figure 2 and Table 1.

REMOVAL

NOTES

Cover the fuel tank with clean shop towels to prevent scratching.

If replacing the handlebar, refer to the service manual to remove controls, hand levers, handlebar and risers.

If only the risers are being replaced, proceed as follows:

1. Remove the two hex head cap screws and split lockwashers on the underside of the upper fork bracket that hold the currently installed risers in place. Discard the screws, but retain the lockwashers for assembly.

Retain all additional components from the riser assembly when the screws are removed.

2. Remove and discard the four screws that fasten upper clamp(s) to the risers. Remove the clamp(s).

Remove the handlebar from the risers, and carefully allow the handlebar to rest on the fuel tank.

INSTALLATION

NOTES

See Figure 2. The upper cup washer (G) must be oriented with the flat side up and the lower cup washer (O) with the flat side down.

1. Align the components as shown, and install the risers (1 and 2) to the upper fork bracket. The ground cable (M) and the internal tooth lock washer (L) are located on the right side only. Do not tighten the riser mounting screws (3) at this time.
2. If an appropriate Harley-Davidson 1-inch handlebar has not been installed, install one according to the Instruction Sheet included with the kit, or install the handlebar assembly onto the risers.
3. See Figure 1. Loosely install riser clamps or caps onto the handlebars and risers with the Bar & Shield toward the front of the motorcycle. Install four socket head screws (1 and 2) as shown.
4. See Figure 2. Check that the risers stay properly aligned with the handlebar and tighten the riser mounting screws (3) following the instructions in the service manual.

NOTE

See Figure 1. After tightening, the gap between the upper clamps and the risers should only be at the rear of the handlebar (4). There should be no gap between the riser caps and the risers at the front of the handlebar (3).

5. Adjust handlebar to the desired position, verify that it is centered on the risers, then tighten the front socket head screws (1) to 12-15 ft-lb (16-20 Nm). There should be no gap at the front of the risers.
6. Tighten rear socket head screws (2) to 12-15 ft-lb (16-20 Nm).

CAUTION

Improperly aligned handlebars can contact the fuel tank when turned to the left or right. Contact with the fuel tank can cause cosmetic damage. (00372a)

7. Turn the handlebars full right and left. Check that:
 - The handlebars and triple tree clamps do not contact the fuel tank.
 - The steering stops function properly.
 - The wiring and brake line are not pinched or kinked in the steering assembly.
 - Throttle returns from full open to close at both fork stops.
8. One at a time, remove the riser bolts installed in Step 4. Apply two drops of Loctite® 271 (Red) to the bolt threads and install. Tighten the riser bolts following the instructions in the appropriate Service Manual.

⚠ WARNING

Install proper length brake lines. Incorrect brake line length can adversely affect motorcycle operation, which could cause loss of control resulting in death or serious injury. (00325a)

- If you are installing different handlebars, measure the change in distance that will be required from the end of the stock brake line to the brake master cylinder.
- If the line is more than 2.0 in (50.8 mm) longer or more than 1.0 in (25.4 mm) shorter than the above measured

distance, see a Harley-Davidson dealer for the correct brake line length.

⚠ WARNING

Be sure that steering is smooth and free without interference. Interference with steering could result in loss of vehicle control and death or serious injury. (00371a)

- Be sure wires, clutch cables, throttle/idle cables and brake lines do not pull tight when handlebars are turned fully to left or right fork stops.

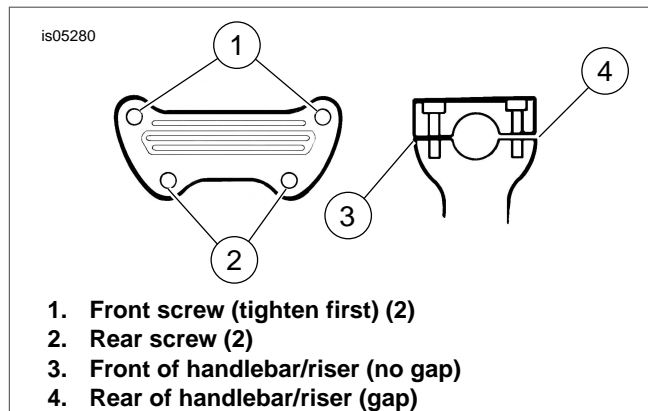

Figure 1. Handlebar Mounting



SERVICE PARTS

is05276

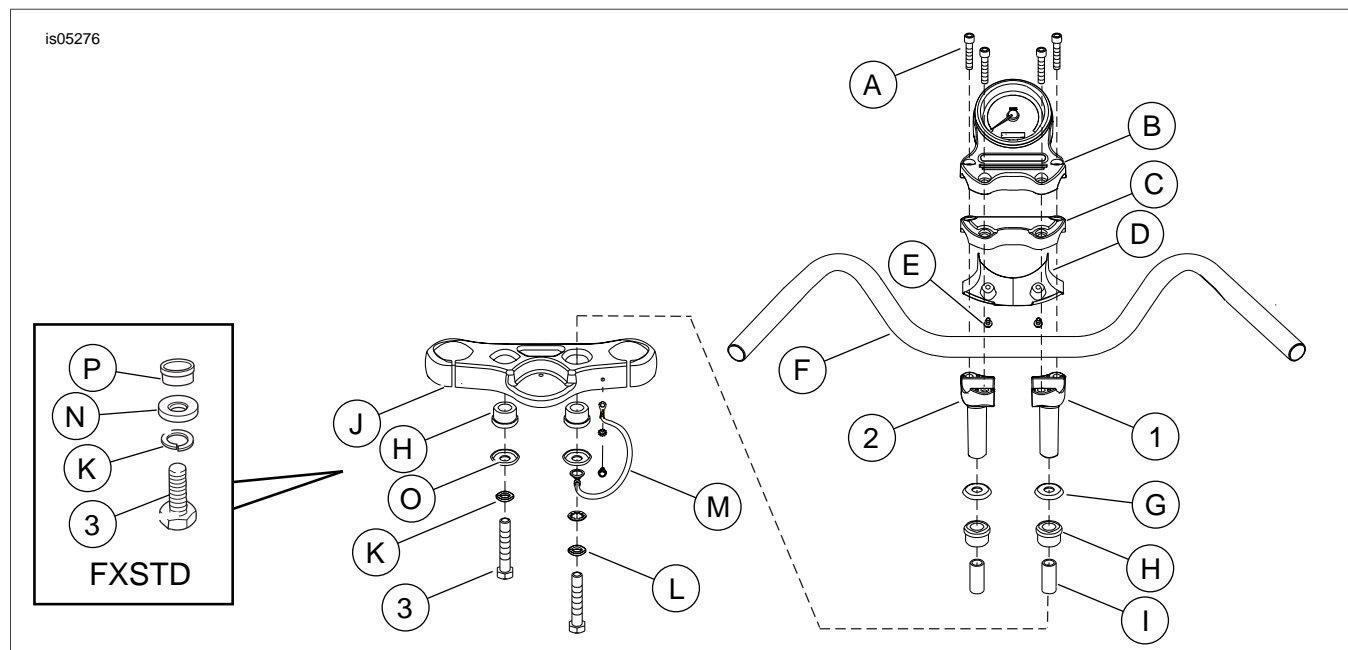

Figure 2. Service Parts: Tall Handlebar Riser

Table 1. Service Parts: Tall Handlebar Riser

Item	Description (Quantity)	Part Number
1	Right side handlebar riser	Not Sold Separately
2	Left side handlebar riser	Not Sold Separately
3	Riser mounting screw (2)	3450
Items mentioned in text, but not included in kit:		
A	Upper handlebar clamp fastener (4)	
B	Upper handlebar clamp and speedometer assembly (FXD)	
C	Upper Handlebar clamp (FXDC)	
D	Speedometer cover (FXD)	
E	Speedometer cover fastener (FXD) (2)	
F	Handlebar	
G	Upper cup washer (2)	
H	Bushing (4)	
I	Spacer (2)	
J	Upper fork bracket	
K	Lockwasher (2)	
L	Ground cable washer (right side only)	
M	Ground cable (right side only)	
N	Washer (2)	
O	Lower cup washer (2)	
P	Spacer (2) (FXSTD models only - purchase separately)	6740