



INSTRUCTIONS

-J05414

2016-08-22

MIRROR KITS

GENERAL

Kit Number

91315-04, 91657-02, 91696-05A, 91697-06A, 91965-98, 92096-05, 92190-06, 92398-09, 92410-09, 92416-08, 92423-08, 92441-10, 56000006, 56000090, 56000135

Models

For model fitment information, see the P&A Retail Catalog or the Parts and Accessories section of www.harley-davidson.com (English only).

Kit Contents

See Figure 2, Table 1 and Table 2.

INSTALLATION

XG Models

1. See Figure 1. Remove mirror.
 - a. Remove mirror (1).
 - b. Remove tube nut (3).
 - c. Remove mirror mount (4).
2. See Figure 1. Install mirror.
 - a. Install mirror mount (4). Tighten to 11.7–14.3 N·m (104–126 in-lbs).
 - b. Install tube nut (3) to mirror stem (2). Hand-tighten.
 - c. Install mirror and tube nut to mirror mount. Hand-tighten.
 - d. Adjust mirror (1).
 - e. Tighten tube nut to 11.7–14.3 N·m (104–126 in-lbs).

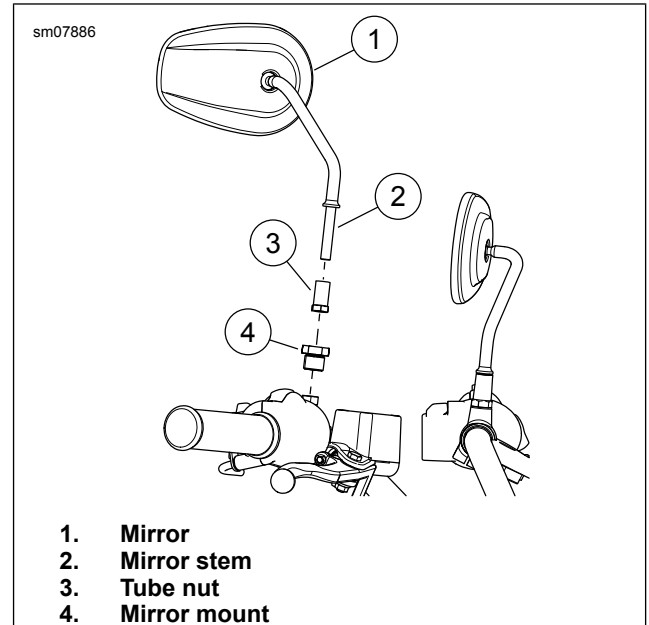

Figure 1. Mirror

All Other Models

1. Remove and discard the existing mirror. Discard any lockwashers and acorn nuts used to mount the original mirror.
2. See Figure 2. Install flat washer (1) on mirror stud (top position) for all mirrors except Part No. 91696-05A, 92398-09 and 92410-09.
3. **For motorcycles with turn signals mounted to the underside of the hand lever housings (except 2004 and later XL models):** Secure the left side mirror using only the lockwasher (2) and the acorn nut (3) from the kit.
4. Secure the right side mirror with the lock washer (2) and acorn nut (3) from the kit and the turn signal retainer only.
5. **For motorcycles with turn signals mounted away from the hand lever housings:** Insert the mirror studs into the holes in the hand lever housings, and secure the mirrors with the flat washers (1) in top and bottom position, lockwashers (2) and acorn nuts (3) from the kit.

NOTE

Harley-Davidson Motor Company cannot test, and make specific fitment recommendations concerning every possible mirror, and handlebar combination. Therefore, after installing new mirrors or handlebars, and before operating the motorcycle, check that the mirrors provide the operator a clear view to the rear.



6. Adjust mirrors for proper field of vision and tighten. Check adjustment and reposition if necessary. **Airflow mirrors:**10.8–16.3 N·m (8–12 ft-lbs)**Other mirrors:**13.5–18.9 N·m (10–14 ft-lbs)

Table 1. Service Parts: Mirror Kits Hardware

Item	Description (Qty)	Silver	Black
1	Flat washer (4)	6771A	6929
2	Lock washer (2)	7127	7155
3	Acorn nut (2)	7736	8196

SERVICE PARTS

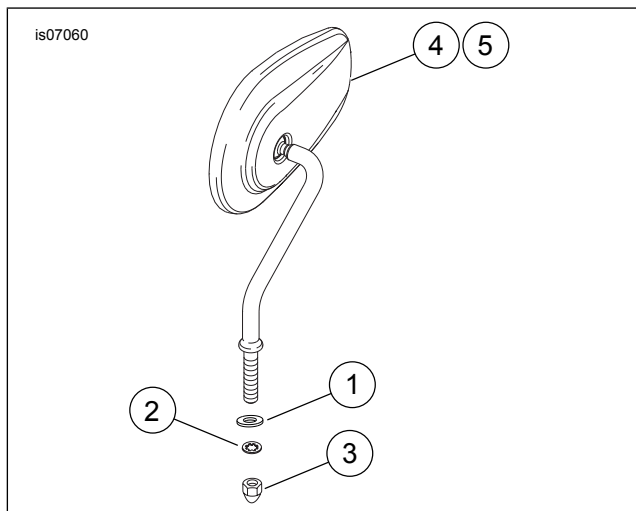

Figure 2. Service Parts: Mirror Hardware

Table 2. Service Parts: Mirror Kits

Kit Number	Description	Left Mirror (Item 4)	Right Mirror (Item 5)
91315-04	Skull	Not Sold Separately	Not Sold Separately
91657-02	Bullet	91928-03	91927-03
91696-05A	Tailfin	92176-05A	92175-05A
91697-06A	Profile Custom	92063-06A	92062-06A
91965-98	Aluminator	Not Sold Separately	Not Sold Separately
92096-05	Buckshot Chrome	91949-05	91987-05
92190-06	Split Vision	Not Sold Separately	Not Sold Separately
92398-09	Tribal Black	Not Sold Separately	Not Sold Separately
92410-09	Tribal Chrome	Not Sold Separately	Not Sold Separately
92416-08	Buckshot Black	92417-08	92419-08
92423-08	Dome Billet	92424-08	92426-08
92441-10	Edgecut Stem	Not Sold Separately	Not Sold Separately
56000006	Slipstream	Not Sold Separately	Not Sold Separately
56000090	Edge Cut Dome	Not Sold Separately	Not Sold Separately
56000135	Airflow, Black	56000125	56000126