



# INSTRUCTIONS

-J05008

REV. 2009-09-10

## FRONT SLOTTED DISC WHEELS

### GENERAL

#### Kit Number

55056-10

#### Models

For model fitment information, see the P&A Retail Catalog or the Parts and Accessories section of [www.harley-davidson.com](http://www.harley-davidson.com) (English only).

#### Additional Parts Required

These kits include the custom wheel only.

Proper installation of these kits require the separate purchase of the following parts which are available at a Harley-Davidson dealer.

- Wheel Bearing Remover and Installer (HD-44060-A)
- Wheel Installation Kit (See tables for part number)
- Models not having a stock 18" front wheel require the separate purchase of tire 44026-09A.

#### Recommended Parts

The following Harley-Davidson Genuine Motor Accessories are recommended for proper maintenance and cleaning:

- Harley® Bright™ Chrome Cleaner (94683-99)
- Harley® Glaze™ Polish and Sealant (99701-84)
- Harley® Wheel and Spoke Brush (43078-99)
- Harley-Davidson® Wheel and Tire Cleaner (94658-98)

### WARNING

**The rider's safety depends upon the correct installation of this kit. Use the appropriate service manual procedures. If the procedure is not within your capabilities or you do not have the correct tools, have a Harley-Davidson dealer perform the installation. Improper installation of this kit could result in death or serious injury. (00333a)**

#### NOTE

*This instruction sheet references service manual information. A service manual for your model motorcycle is required for this installation and is available from a Harley-Davidson dealer.*

### Kit Contents

See Figure 1 and Service Parts Tables.

### INSTALLATION

1. Remove existing front wheel assembly. Save axle, axle nut, brake discs, and wheel spacers for kit installation. Refer to FRONT WHEEL in service manual.

#### NOTES

*Prior to removing or installing the wheel, the front brake calipers must be removed.*

### CAUTION

**Do not re-use brake disc/rotor screws. Re-using these screws can result in torque loss and damage to brake components. (00319c)**

2. See Figure 1. Install valve stem assembly (D) on wheel. Refer to TIRES in service manual.
3. Assemble wheel installation kit components, stock brake discs to wheel using the appropriate service parts table. Refer to FRONT WHEEL in service manual.
4. Mount and balance tire. Refer to TIRES in service manual.

#### NOTES

*The valve stem side of the wheel and machined grooves in the hub face indicate the primary bearing side. Install the primary bearing first using appropriate service manual and WHEEL BEARING REMOVER/INSTALLER.*

5. Install front wheel (1), stock axle, and stock spacers to motorcycle. Refer to FRONT WHEEL in service manual.

### MAINTENANCE AND CLEANING

Chrome parts must be maintained regularly to make sure that they keep their original shine and luster.

1. Clean heavily-soiled wheel surfaces using Harley-Davidson Wheel and Tire Cleaner, applied with Harley Wheel and Spoke Brush.
2. Thoroughly clean chrome with a good quality chrome cleaner, such as Harley Bright Chrome Cleaner.
3. After cleaning and polishing, seal the finish with a good quality sealer, such as Harley Glaze Polish and Sealant.

# SERVICE PARTS

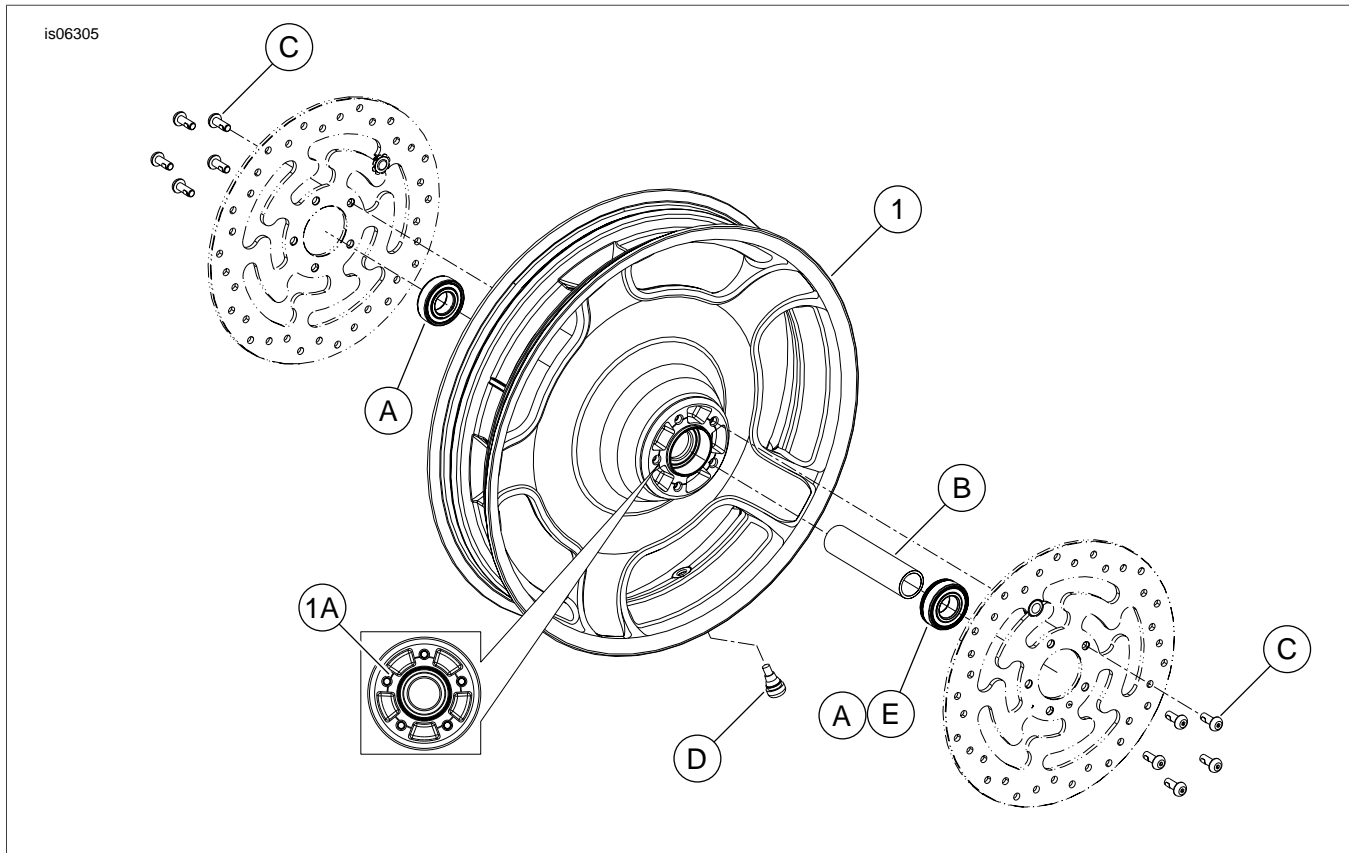

Figure 1. Service Parts: Front Slotted Disc Wheel

Table 1. Service Parts Table

Kit	Installation Kit	Item	Description (Quantity)	Part Number	
55056-10		1	Wheel	Not Sold Separately	
		1A	Machined groove	Not Sold Separately	
2009-later Touring (NON-ABS)	43851-08A 18x3.5 front wheel	A	Bearing (2)	9276	
		B	Sleeve, bearing spacer	41900-08	
		C	Disc screws (10)	3655A	
		D	Valve stem assembly	40999-87	
		NOTE: Discard the following components which are provided with this installation kit, but are not required for this fitment.			
			Valve stem assembly	43157-83A	
			Valve stem assembly	43206-01	
			Shim, Bearing	43903-08	
			Shim, Bearing	43315-07	
			Sleeve, bearing spacer	41349-07	
	Spacer, axle	41695-07			
	Spacer, axle	41504-07			

**Table 1. Service Parts Table**

Kit	Installation Kit	Item	Description (Quantity)	Part Number		
2009-later Touring (ABS)	41454-08A 17x3 front wheel	A	Bearing	9276		
		B	Sleeve, bearing spacer	41900-08		
		C	Disc screws (10)	3655A		
		D	Valve stem assembly	40999-87		
		E	Bearing, ABS ( <b>Red side must face inward</b> )	9252		
		NOTE: Discard the following components which are provided with this installation kit, but are not required for this fitment.				
		Valve stem				43157-83A
		Valve stem				43206-01
		Valve stem assembly				43157-83A
		Shim, bearing				43903-08
		Shim, bearing				41450-08
		Sleeve, bearing spacer				41748-08
		TORX® bolt (10)				3762M
		Washers (10)				6966M

