



INSTRUCTIONS

-J04473

REV. 2007-11-27

TWO-UP LOW REAR SHOCK ABSORBER KIT

GENERAL

Kit Number

54704-07

Models

For model fitment information, please see the P&A Retail Catalog or the Parts and Accessories section of www.harley-davidson.com (English only).

Additional Parts Required

This kit requires LOCTITE® 243 (blue) for proper installation.

WARNING

The rider's safety depends upon the correct installation of this kit. Use the appropriate service manual procedures. If the procedure is not within your capabilities or you do not have the correct tools, have a Harley-Davidson dealer perform the installation. Improper installation of this kit could result in death or serious injury. (00333a)

NOTE

This instruction sheet references Service Manual information. A Service Manual for your model motorcycle is required for this installation and is available from a Harley-Davidson Dealer.

Kit Contents

See Figure 2 and Table 1.

INSTALLATION

WARNING

Perform this installation when the engine is cool. Working on or near the exhaust system when the engine is hot could result in severe burns. (00311a)

NOTES

This procedure requires that both shocks be removed prior to installing the new shock absorbers. You need to place the motorcycle on a center stand with the rear wheel raised off of the ground.

The exhaust system may interfere when removing and installing the lower right shock mounting hardware. If necessary, see Service Manual and remove the rear exhaust pipe.

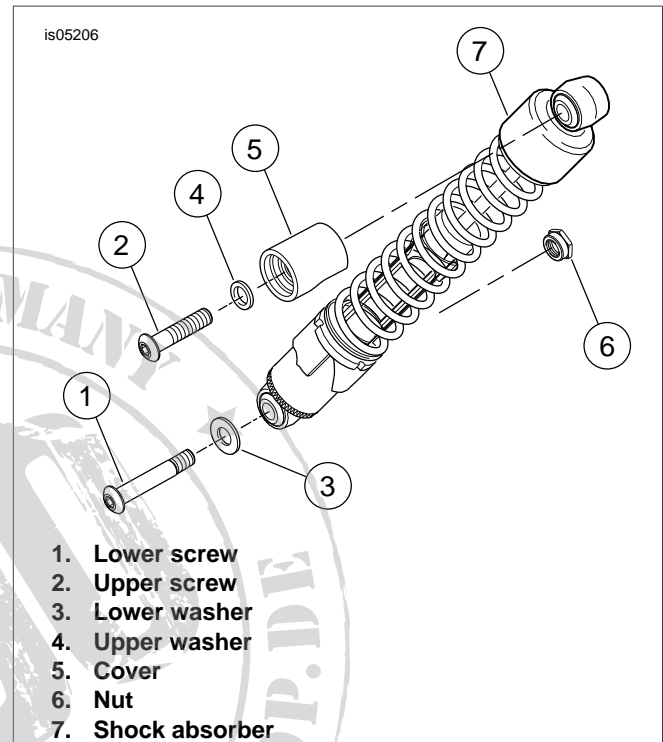

Figure 1. Remove/Install Shock Absorber

1. Remove lower shock mounting screw (1), washer (3) and nut (6) from shock absorber (7). Save hardware for reuse.
2. Remove upper bolt (2), washer (4) and cover (5) and remove the shock absorber. Save hardware for reuse.
3. Repeat Steps 1 and 2 for opposite side and save hardware.
4. Apply 2-3 drops of LOCTITE 243® (blue) on the threads of the lower mounting bolt, then install bolt, lower washer and nut to the shock.
5. Apply 2-3 drops of LOCTITE 243® (blue) on the threads of the upper mounting bolt, then install shock cover, upper mounting bolt and washer to the shock. Ensure cutout in shock cover locates properly.

NOTE

Ensure that the shock covers stay centered on the shock and do not turn when tightening the shock mounting bolts.

6. Tighten mounting bolts to 45-50 ft-lbs (61.1-67.9 Nm).
7. Repeat Steps 4, 5 and 6 for opposite side.

WARNING

Be sure both shock absorbers are adjusted to same preload position. Improper adjustment can adversely affect stability and handling, which could result in death or serious injury. (00036a)

NOTE

Spanner wrenches are available to adjust the shock spring preload, Part Number HD-94700-52C or HD-94820-74A. These tools can be purchased from your Harley-Davidson Dealer.

CAUTION

Wipe all fingerprints off of exhaust system components after installation and before starting engine. Oil from hands can leave permanent marks on exhaust system finish. (00346a)

8. See the Service Manual and install rear exhaust pipe, if removed.

SERVICE PARTS

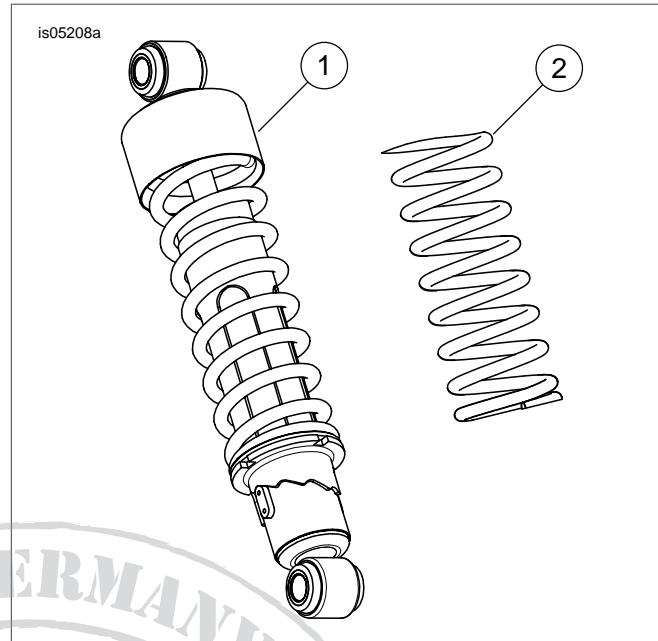

Figure 2. Service Parts: Two-Up Low Rear Shock Absorber Kit

Table 1. Service Parts

Item	Description (Quantity)	Part Number
1	Shock absorber (2)	Not Sold Separately
2	Spring, shock absorber	54706-07